

HO-95

## Wheatfields (Chews Resolution Manor)

### **Architectural Survey File**

This is the architectural survey file for this MIHP record. The survey file is organized reverse-chronological (that is, with the latest material on top). It contains all MIHP inventory forms, National Register nomination forms, determinations of eligibility (DOE) forms, and accompanying documentation such as photographs and maps.

Users should be aware that additional undigitized material about this property may be found in on-site architectural reports, copies of HABS/HAER or other documentation, drawings, and the “vertical files” at the MHT Library in Crownsville. The vertical files may include newspaper clippings, field notes, draft versions of forms and architectural reports, photographs, maps, and drawings. Researchers who need a thorough understanding of this property should plan to visit the MHT Library as part of their research project; look at the MHT web site ([mht.maryland.gov](http://mht.maryland.gov)) for details about how to make an appointment.

All material is property of the Maryland Historical Trust.

***Last Updated: 05-03-2004***

HO-95  
WHEATFIELDS  
Ellicott City  
Private

early nineteenth century

Wheatfields is noted on both the Martinet Map of 1860 and the Hopkins Atlas of 1878 as belonging, along with 202 acres, to James Clark, a prosperous planter who married Jemina R. Ward and raised a large family. Their oldest son, James Clark, Jr. became president of the Drovers and Mecanics Bank in 1892.

Wheatfields is a fine architectural composition, built in four sections with east and west one story high flat roofed appendages. The oldest section is the kitchen. It is a three bay wide, one bay deep, two and a half story stone structure which has a water table running along the perimeter of the foundation. A very early two story high, one bay wide south addition was added which later was extended eastward two bays to meet and connect with the east wing of the house, a three bay wide, two bay deep, two and a half story high, gabled roof stone covered with stucco east wing. A fine rectangular south entrance located in its west bay is surmounted by a three lite transom and flanked by flat pilasters with full entablature. A flat lintel and projecting cornice are decorated with a row of dentils and by a broken pediment with Grecian urn rising from its central base. A peg barn, old stable and smoke house are located amidst manicured lawns, trees and shrubbery on this exceptionally well maintained site.

MARYLAND HISTORICAL TRUST

INVENTORY FORM FOR STATE HISTORIC SITES SURVEY

**1 NAME**

HISTORIC Chews Resolution Manor

AND/OR COMMON Wheatfields

**2 LOCATION**

STREET & NUMBER 4588 Montgomery Road (MD 103)  
Ellicott City,

sixth

CITY, TOWN  
Maryland

CONGRESSIONAL DISTRICT

\_\_\_ VICINITY OF

Howard

STATE

COUNTY

**3 CLASSIFICATION**

CATEGORY	OWNERSHIP	STATUS	PRESENT USE
<input checked="" type="checkbox"/> DISTRICT	<input type="checkbox"/> PUBLIC	<input checked="" type="checkbox"/> OCCUPIED	<input type="checkbox"/> AGRICULTURE <input type="checkbox"/> MUSEUM
<input type="checkbox"/> BUILDING(S)	<input checked="" type="checkbox"/> PRIVATE	<input type="checkbox"/> UNOCCUPIED	<input type="checkbox"/> COMMERCIAL <input type="checkbox"/> PARK
<input type="checkbox"/> STRUCTURE	<input type="checkbox"/> BOTH	<input type="checkbox"/> WORK IN PROGRESS	<input type="checkbox"/> EDUCATIONAL <input checked="" type="checkbox"/> PRIVATE RESIDENCE
<input type="checkbox"/> SITE	<input type="checkbox"/> PUBLIC ACQUISITION	<input type="checkbox"/> ACCESSIBLE	<input type="checkbox"/> ENTERTAINMENT <input type="checkbox"/> RELIGIOUS
<input type="checkbox"/> OBJECT	<input type="checkbox"/> IN PROCESS	<input checked="" type="checkbox"/> YES: RESTRICTED	<input type="checkbox"/> GOVERNMENT <input type="checkbox"/> SCIENTIFIC
	<input type="checkbox"/> BEING CONSIDERED	<input type="checkbox"/> YES: UNRESTRICTED	<input type="checkbox"/> INDUSTRIAL <input type="checkbox"/> TRANSPORTATION
		<input type="checkbox"/> NO	<input type="checkbox"/> MILITARY <input type="checkbox"/> OTHER

**4 OWNER OF PROPERTY**

NAME Mr. and Mrs. Donald Doll  
4588 Montgomery Rd.

Telephone #: 465-2475

STREET & NUMBER

Ellicott City

Md. 21043

CITY, TOWN

STATE, zip code

\_\_\_ VICINITY OF

**5 LOCATION OF LEGAL DESCRIPTION**

COURTHOUSE,  
REGISTRY OF DEEDS, ETC.

Howard County Courthouse Hall of Records

Liber #: 457

Folio #: 465

STREET & NUMBER

Courthouse Dr.

CITY, TOWN

STATE

Ellicott City

Maryland, 21043

**6 REPRESENTATION IN EXISTING SURVEYS**

TITLE

Howard County Historic Sites Inventory

DATE

May 1977

\_\_\_ FEDERAL  STATE \_\_\_ COUNTY \_\_\_ LOCAL

DEPOSITORY FOR  
SURVEY RECORDS

Maryland Historical Trust

CITY, TOWN

STATE

21 State Circle, Annapolis,

Maryland, 21401

7. DESCRIPTION <u>The Dolls</u>	
CONDITION	<div style="text-align: right; font-size: small;">(Check One)</div> <input type="checkbox"/> Excellent <input type="checkbox"/> Good <input type="checkbox"/> Fair <input type="checkbox"/> Deteriorated <input type="checkbox"/> Ruins <input type="checkbox"/> Unexposed
	<div style="display: flex; justify-content: space-between;"> <div style="width: 45%; text-align: center; font-size: small;">(Check One)</div> <div style="width: 45%; text-align: center; font-size: small;">(Check One)</div> </div> <input type="checkbox"/> Altered <input type="checkbox"/> Uncluttered <input type="checkbox"/> Moved <input type="checkbox"/> Original Site
	DESCRIBE THE PRESENT AND ORIGINAL (if known) PHYSICAL APPEARANCE
<p>Wheatfield is a fine architectural composition, built in several stages, located on the west side of Montgomery Road located south of Route 29.</p> <p>Wheatfields was built in four sections (See plan) with east and west one story high flat roofed appendages. The oldest section is the north wing which is a three bay wide, one bay deep, two and a half story stone structure which has a water table running along the foundation of the structure. A ground floor and first floor entrance is located in the central bay of the west wall. An additional ground floor entrance is located on its south wall; surmounted by a three lite transom which leads into a two story high, one bay wide stone addition.</p> <p>The north and south bays of the east and west walls hold double-hung ground level and first floor rectangular windows with six-over-three and six-over-six lites respectively. Six lite casement second floor windows lie above.</p> <p>The north wall holds a similar first floor window. The east wall also holds an additional six-over-six rectangular first floor window in the south bay. This entire section is used as a kitchen with large central brick fireplace centered into the east wall.</p> <p><u>Section 2</u></p> <p>A very early two bay wide, one bay deep, two story high stone covered with stucco addition was added to the original stone house. Its north and south walls hold first and second floor rectangular, double-hung windows with six-over-six lites, decorated with flat wooden sills and shutters. It has a central rectangular west entrance door which is surmounted by a four lite transom which now enters into the two bay wide, one bay deep stone covered with stucco, flat roofed, one story high den which springs from its west wall.</p> <p><u>Section 3</u></p> <p>Lying east of Section 2 is a three bay wide, two bay deep, two and a half story gabled roof (running east-west) stone covered with stucco structure. Wide brick chimneys are inset into its east wall, on either side of the gable, furnishing two flues for the fireplaces of the two first floor parlors and the two second floor bedrooms.</p>	

SEE INSTRUCTIONS

### North and South Walls of Section 3

Cross paneled rectangular entrance doors are located in the west bay of the north and south walls. That on the south is surmounted by a three lite transom, flanked by flat pilasters, with full entablature. A flat lintel and cornice are decorated by a broken pediment with grecian urn rising from its central base.

A gabled roof, roman arched hood covers the north entrance. One ashlar granite slab and four granite stone steps lead to a flag stone patio surrounded by a stone wall which runs from the west to the central bay of the north wall.

### East and West Walls of Section 3

Two rectangular, double-hung small attic windows, decorated with projecting stone sills and black shutters are inset into its east wall. A single attic window is inset into its west wall, which also holds a first floor window similar to the others.

A one story high, flat roofed, enclosed porch, one room deep lies along the entire east elevation. Square columns at each side and three pilasters between its four bays (each bay holding a double rectangular window with six-over-six lites) indicates its early use as an open porch.

### Section 4 - Connector

A two story high, two bay wide, one room deep stone covered with stucco structure connects sections 2 and 3. On its south wall it holds a cross paneled rectangular door surmounted by a three lite transom in the east bay and a rectangular double-hung window holding six-over-six lites in the west bay. Its stone wall is inset with a one story open porch lying flush with section two's south wall. It is supported by two square columns and two pilasters. A second floor has been added above the open porch, covered with a gable roof (running east-west) which holds three sliding windows with 12-12 lites. This connector holds first and second floor north windows, double-hung with six-over-six lites. A gabled roof dormer is inset into the north elevation's roof line. Its double-hung rectangular window holds six-over-six lites, flanked by pilasters and surmounted by a closed pediment.

A peg barn lies south of the main house. A two car gabled

roof garage is west and the old stone smoke house is north of the house. The latter had a central round pit for smoking meat and was used for storage of hams, etc. A double stable adjoined it. These structures have been unified under one gable roof (running east-west) and converted into a craft shop for Mrs. Donald Doll, the present owner. A green house extends from the south wall of this structure whose axis runs north-south.

The entire site is covered with manicured lawns and shrubbery, well laid out flower beds and mature trees. Carefully and thoughtfully cared for, Wheatfield is one of Howard County's outstanding homes.

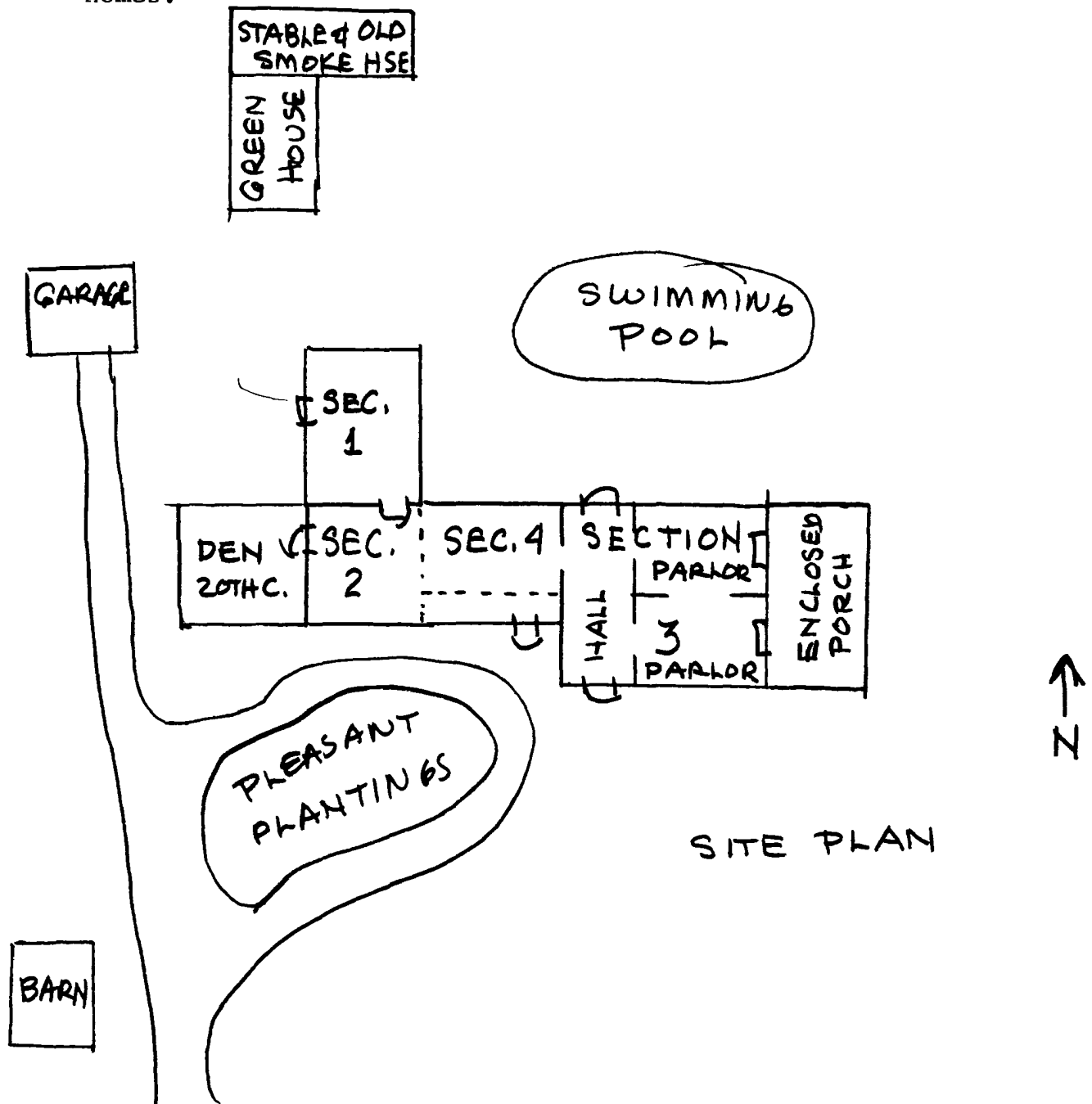

**8. SIGNIFICANCE** Wheatfields

PERIOD (Check One or More as Appropriate)

<input type="checkbox"/> Pre-Columbian	<input type="checkbox"/> 16th Century	<input type="checkbox"/> 18th Century	<input type="checkbox"/> 20th Century
<input type="checkbox"/> 15th Century	<input type="checkbox"/> 17th Century	<input checked="" type="checkbox"/> 19th Century	

SPECIFIC DATE(S) (If Applicable and Known) Early nineteenth century

AREAS OF SIGNIFICANCE (Check One or More as Appropriate)

<input type="checkbox"/> Aboriginal	<input type="checkbox"/> Education	<input type="checkbox"/> Political	<input type="checkbox"/> Urban Planning
<input type="checkbox"/> Prehistoric	<input type="checkbox"/> Engineering	<input type="checkbox"/> Religion/Philosophy	<input type="checkbox"/> Other (Specify) _____
<input checked="" type="checkbox"/> Historic	<input type="checkbox"/> Industry	<input type="checkbox"/> Science	_____
<input type="checkbox"/> Agriculture	<input type="checkbox"/> Invention	<input type="checkbox"/> Sculpture	_____
<input checked="" type="checkbox"/> Architecture	<input type="checkbox"/> Landscape Architecture	<input type="checkbox"/> Social/Humanitarian	_____
<input type="checkbox"/> Art	<input type="checkbox"/> Literature	<input type="checkbox"/> Theater	_____
<input type="checkbox"/> Commerce	<input type="checkbox"/> Military	<input type="checkbox"/> Transportation	_____
<input type="checkbox"/> Communications	<input type="checkbox"/> Music		
<input type="checkbox"/> Conservation			

STATEMENT OF SIGNIFICANCE

In 1790 three brothers, David, John and James Clark left their native home in Northern Ireland near Belfast to settle in upper Anne Arundel County.

Both David and John Clark became prosperous merchants and bankers of Howard County. John Clark had an only son James Clark (1809-1890) who was also a prosperous planter and lived at Wheatfields. He married Jemina R. Ward and they raised a large family. James Clark, Jr., his oldest son, was a Confederate army officer who returned to Howard County after the Civil War to engage in banking and commerce in both Baltimore and Howard County. He became president of the Drovers and Mechanics Bank in 1892 which was at that time one of the most important banks in Baltimore. Both the Martinet Map of 1860 (attachments) and the Hopkins Atlas of 1878 (see attachment) indicate James at Wheatfields.

James Clark, Jr. married Elizabeth Booker of Baltimore and had a family of eight children. Their third son, John Lawrence Clark, continued his father's business with great success. It was he who married Mary Corinne Talbott and had a son James Clark who became one of Howard County's finest judges, succeeding Judge William H. Forsythe, Jr. as Judge of the Fourth Judicial Circuit and later appointed to the Court of Appeals in 1954. He and his wife Alda Hopkins Clark had sons who served Howard County and their state well. Their son John L. Clark became Judge of the People's Court of Howard County and makes his home in Marriottsville at the old homestead of Dr. Thomas Snowden Herbert. Another son, James is presently our State Senator.

Architecturally Wheatfields is outstanding for its fine integration of several structures into a pleasing architectural composition, having the elements of continuity, rhythm and integrity. The original three bay wide, one room deep stone kitchen of the house with second floor above was probably built as early as 1802 when neighboring Avoca,

SEE INSTRUCTIONS

existed (1802-N.H. 16-486 - A.A. County) then known as the Manor House for Chew's Resolution Manor and Chew's Vineyard.

A deed from Michael Pue, owner of Chew's Resolution Manor to James Clark is noted in the deed of 19 March, 1878, LJW 39-89 from James MacKubin as Executor for the estate of Michael Pue to Alfred W. and Emma W. Thomas. Buildings existed here as early as 1802 and James Clark bought the property prior to 1860 (see attachment 3). The later part of the house was therefore built prior to 1860, probably circa 1830.

For these reasons Wheatfields, which is presently owned and delightfully maintained by Mr. and Mrs. Donald Doll, should be considered for inclusion to the National Register, the State Critical Areas Program and any future local landmark legislation.

**9 MAJOR BIBLIOGRAPHICAL REFERENCES**

Stein, Charles. Origin and History of Howard County, Maryland.  
Baltimore, 1972, p. 187.

CONTINUE ON SEPARATE SHEET IF NECESSARY

**10 GEOGRAPHICAL DATA**

ACREAGE OF NOMINATED PROPERTY 11.350 acres

Please see attachment 1, Tax Map 30, Blk. 12, p. 30 457-465.

VERBAL BOUNDARY DESCRIPTION

Please see attachment 1.

LIST ALL STATES AND COUNTIES FOR PROPERTIES OVERLAPPING STATE OR COUNTY BOUNDARIES

STATE	COUNTY
Maryland	Howard
STATE	COUNTY

**FORM PREPARED BY**

NAME / TITLE Cleora B. Thompson/ Archivist  
Comprehensive Planning

May 1977

ORGANIZATION

DATE

3450 Courthouse Drive

465-5000 ext.257

STREET & NUMBER

TELEPHONE

Ellicott City,

Maryland, 21043

CITY OR TOWN

STATE

The Maryland Historic Sites Inventory was officially created by an Act of the Maryland Legislature, to be found in the Annotated Code of Maryland, Article 41, Section 181 KA, 1974 Supplement.

The Survey and Inventory are being prepared for information and record purposes only and do not constitute any infringement of individual property rights.

RETURN TO: Maryland Historical Trust  
The Shaw House, 21 State Circle  
Annapolis, Maryland 21401  
(301) 267-1438

WILLIAM L FEARING  
405/689  
31.22A.  
P.2

CO. COMM.  
OF HO. CO.  
180/339

P.529

H. W. MILNER  
515/757  
11.05A.  
P.592

MORRIS G SMITH & W.F.  
157/206 & 181/327

H.S. CELGIN  
724/378  
5.00A.  
P.586, W.T. ROTH  
619/237  
11.44A.  
P.8

DONALD E. DOLL  
C.W.F.  
457/465  
11.35A.  
P.563

RUSSELL H BAUGHER  
181/253

FRANK A. JOSEPH  
184/417  
27.14A.  
P.11

FRED W ZAISER  
221/165 C.J. & R.M.  
15.00A. NICHOLS  
389/574  
11.9A  
P.14, P.15

J.F. JOHNSON  
LUMBER  
404/518  
7.59A  
P.376

V.L. LOUGH  
470/274  
5.03A.  
P.19

RALPH NUFF  
287/69  
15.54A.  
P.351

Attachment 1  
Wheatfield  
HO - 95  
Tax map 31

30

RALPH FEUGH  
288/85  
P.301

LEON A. CRANE, ETAL  
653/698  
17.93A.  
P.175

JOS. W. ZWOBOT  
ETAL.  
537/102  
26.35A.  
P.103

553/23  
P.7.84  
P.106  
P.507 ARTHUR  
H. GORDON  
164, 223 277

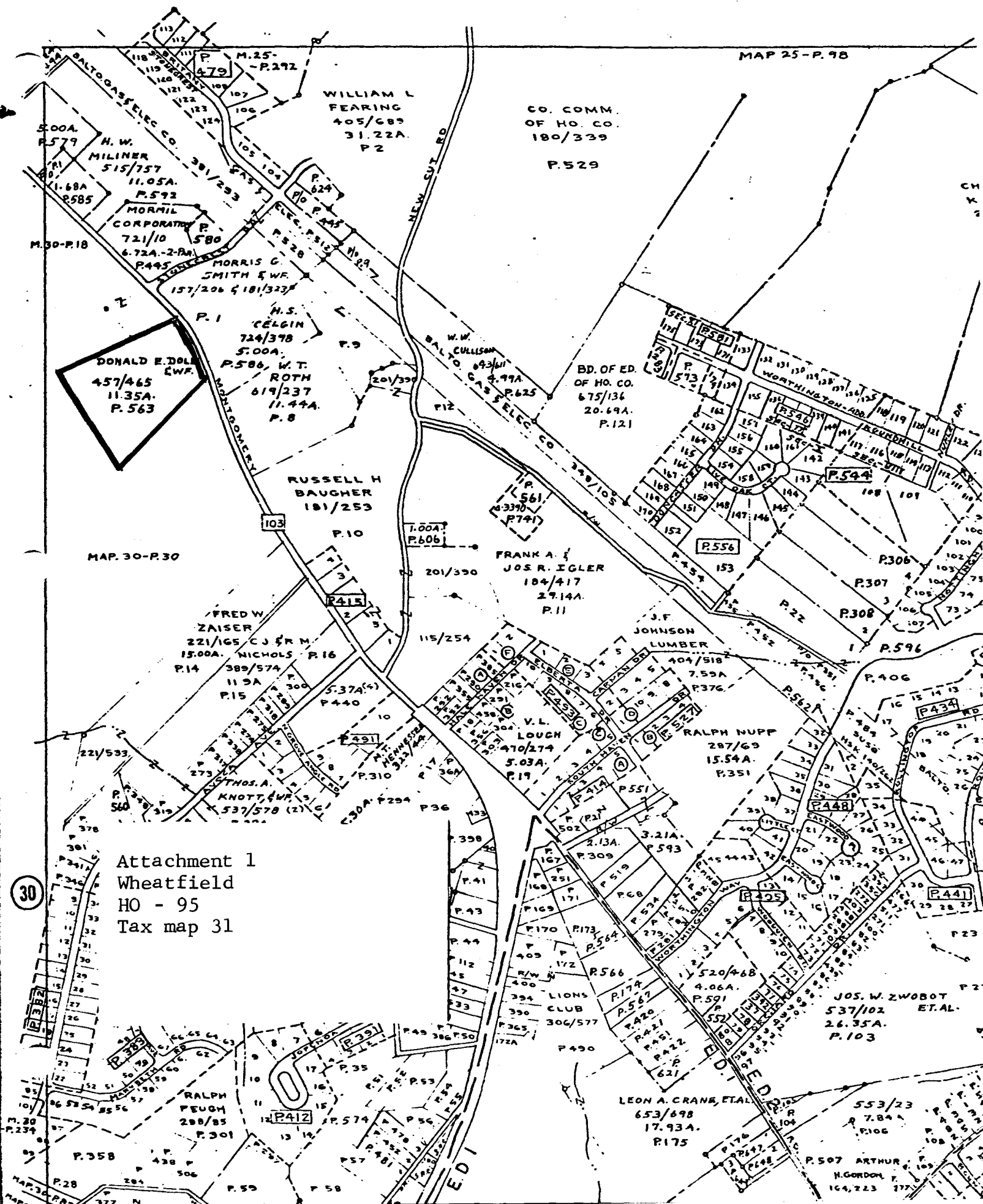

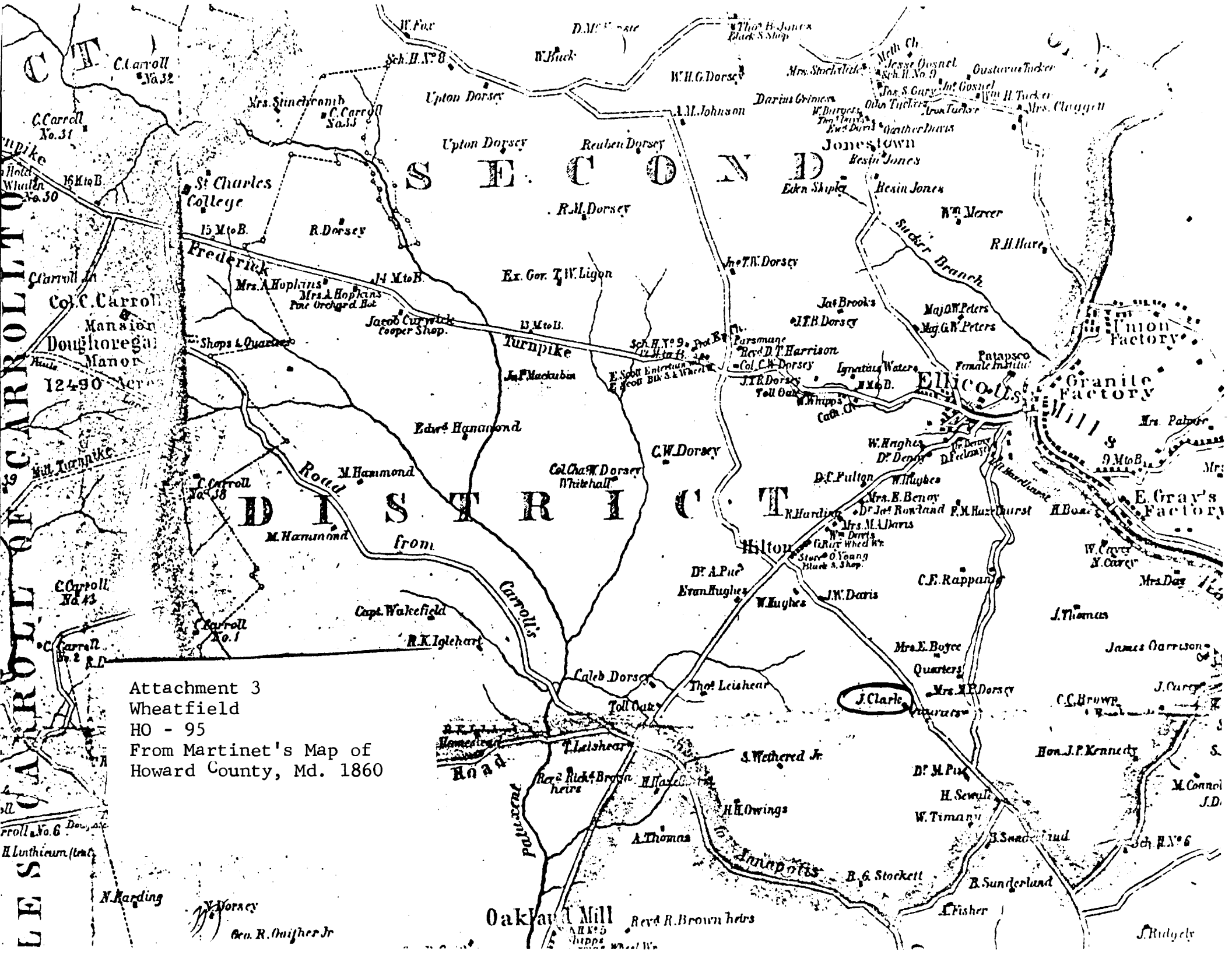

Attachment 3  
 Wheatfield  
 HO - 95  
 From Martinet's Map of  
 Howard County, Md. 1860

LES CARROLL OF CARROLL COUNTY

S E C T I O N D

D I S T R I C T

C. Carroll No. 32

C. Carroll No. 31  
 C. Carroll No. 30

Col. C. Carroll  
 Mansion  
 Doughoregan  
 Manor  
 12490 Acres

Turnpike

C. Carroll No. 43  
 C. Carroll No. 2  
 C. Carroll No. 1

C. Carroll No. 6

N. Harding

Gen. R. Snijder Jr

Sch. H. No. 8

St. Charles College

Frederick

Shops & Quarters

C. Carroll No. 38

C. Carroll No. 1

R. Dorsey

Mrs. A. Hopkins  
 Pine Orchard Bot.

Jacob Currywick  
 Cooper Shop.

M. Hammond

M. Hammond

Capt. Wakefield  
 R. K. Iglehart

Palmer Road

Oakvale Mill

Upton Dorsey

Upton Dorsey

Reuben Dorsey

R. M. Dorsey

Ex. Gov. T. W. Ligon

Turnpike

J. F. MacCubbin

Edw. Hammond

Col. Chas. W. Dorsey  
 Whitehall

Caleb Dorsey

Toll Oak

Rev. Richd. Brown heirs

A. Thomas

Rev. R. Brown heirs

W. Huck

W. H. G. Dorsey

A. M. Johnson

Thos. T. Dorsey

Sch. H. No. 9

E. Scott Entrance

C. W. Dorsey

Dr. A. P. Egan Hughes

W. Hughes

Thos. Leishear

S. Weathered Jr.

H. H. Owings

Annepoles

Whipp

Thos. B. Jones  
 Black S. Shop

Darius Grimes

W. Burgess

Thos. T. Dorsey

Edm. Shipley

Thos. T. Dorsey

Jas. Brooks

J. B. Dorsey

Rev. D. T. Harrison

Col. C. W. Dorsey

J. R. Dorsey

Toll Oak

W. Whipp

R. Harding

Dr. J. A. Davis

W. Davis

Dr. A. P. Egan Hughes

W. Hughes

J. W. Davis

Thos. Leishear

Toll Oak

S. Weathered Jr.

H. H. Owings

H. H. Owings

H. H. Owings

H. H. Owings

H. H. Owings

H. H. Owings

H. H. Owings

J. Clarke

Mrs. E. Boyce

Quarters

Mrs. M. P. Dorsey

Quarters

Dr. M. P. Pux

H. Sewell

W. Timany

W. Timany

W. Timany

W. Timany

W. Timany

Meth. Ch.

Jesse Gosnell

Sch. H. No. 9

Jas. S. Gury

Wm. H. Tucker

Wm. H. Tucker

Wm. H. Tucker

Wm. H. Tucker

Wm. H. Tucker

Wm. H. Tucker

Wm. H. Tucker

Wm. H. Tucker

Wm. H. Tucker

Wm. H. Tucker

Wm. H. Tucker

Wm. H. Tucker

Wm. H. Tucker

Wm. H. Tucker

Wm. H. Tucker

Wm. H. Tucker

Wm. H. Tucker

Wm. H. Tucker

Wm. H. Tucker

Wm. H. Tucker

Wm. H. Tucker

Wm. H. Tucker

Wm. H. Tucker

Wm. H. Tucker

Wm. H. Tucker

Wm. H. Tucker

Wm. H. Tucker

Wm. H. Tucker

Wm. H. Tucker

Wm. Mercer

R. H. Hart

R. H. Hart

R. H. Hart

R. H. Hart

R. H. Hart

R. H. Hart

R. H. Hart

R. H. Hart

R. H. Hart

R. H. Hart

R. H. Hart

R. H. Hart

R. H. Hart

R. H. Hart

R. H. Hart

R. H. Hart

R. H. Hart

R. H. Hart

R. H. Hart

R. H. Hart

R. H. Hart

R. H. Hart

R. H. Hart

R. H. Hart

R. H. Hart

Union Factory

Union Factory

Union Factory

Union Factory

Union Factory

Union Factory

Union Factory

Union Factory

Union Factory

Union Factory

Union Factory

Union Factory

Union Factory

Union Factory

Union Factory

Union Factory

Union Factory

Union Factory

Union Factory

Union Factory

Union Factory

Union Factory

Union Factory

Granite Factory

Granite Factory

Granite Factory

Granite Factory

Granite Factory

Granite Factory

Granite Factory

Granite Factory

Granite Factory

Granite Factory

Granite Factory

Granite Factory

Granite Factory

Granite Factory

Granite Factory

Granite Factory

Granite Factory

Granite Factory

Granite Factory

Granite Factory

Granite Factory

Granite Factory

Granite Factory

E. Gray's Factory

E. Gray's Factory

E. Gray's Factory

E. Gray's Factory

E. Gray's Factory

E. Gray's Factory

E. Gray's Factory

E. Gray's Factory

E. Gray's Factory

E. Gray's Factory

E. Gray's Factory

E. Gray's Factory

E. Gray's Factory

E. Gray's Factory

E. Gray's Factory

E. Gray's Factory

Patuxent

Patuxent

Patuxent

Patuxent

Patuxent

Patuxent

Patuxent

Patuxent

Patuxent

Patuxent

Patuxent

Patuxent

Patuxent

Patuxent

Patuxent

Patuxent

Patuxent

Patuxent

Patuxent

Female Institute

Female Institute

Female Institute

Female Institute

Female Institute

Female Institute

Female Institute

Female Institute

Female Institute

Female Institute

Female Institute

Female Institute

Female Institute

Female Institute

Female Institute

Female Institute

Female Institute

Female Institute

Female Institute

Female Institute

Female Institute

Female Institute

Female Institute

Hilton

Hilton

Hilton

Hilton

Hilton

Hilton

Hilton

Hilton

Hilton

Hilton

Hilton

Hilton

Hilton

Hilton

Hilton

Hilton

Patuxent

Patuxent

Patuxent

Patuxent

Patuxent

Patuxent

Patuxent

Patuxent

Patuxent

Patuxent

Patuxent

Patuxent

Patuxent

Patuxent

Patuxent

Patuxent

Patuxent

Patuxent

Patuxent

Patuxent



Attachment 2  
Wheatfield  
HO-95  
U.S. Geological Map  
Ellicott City and Savage,  
Maryland Quads

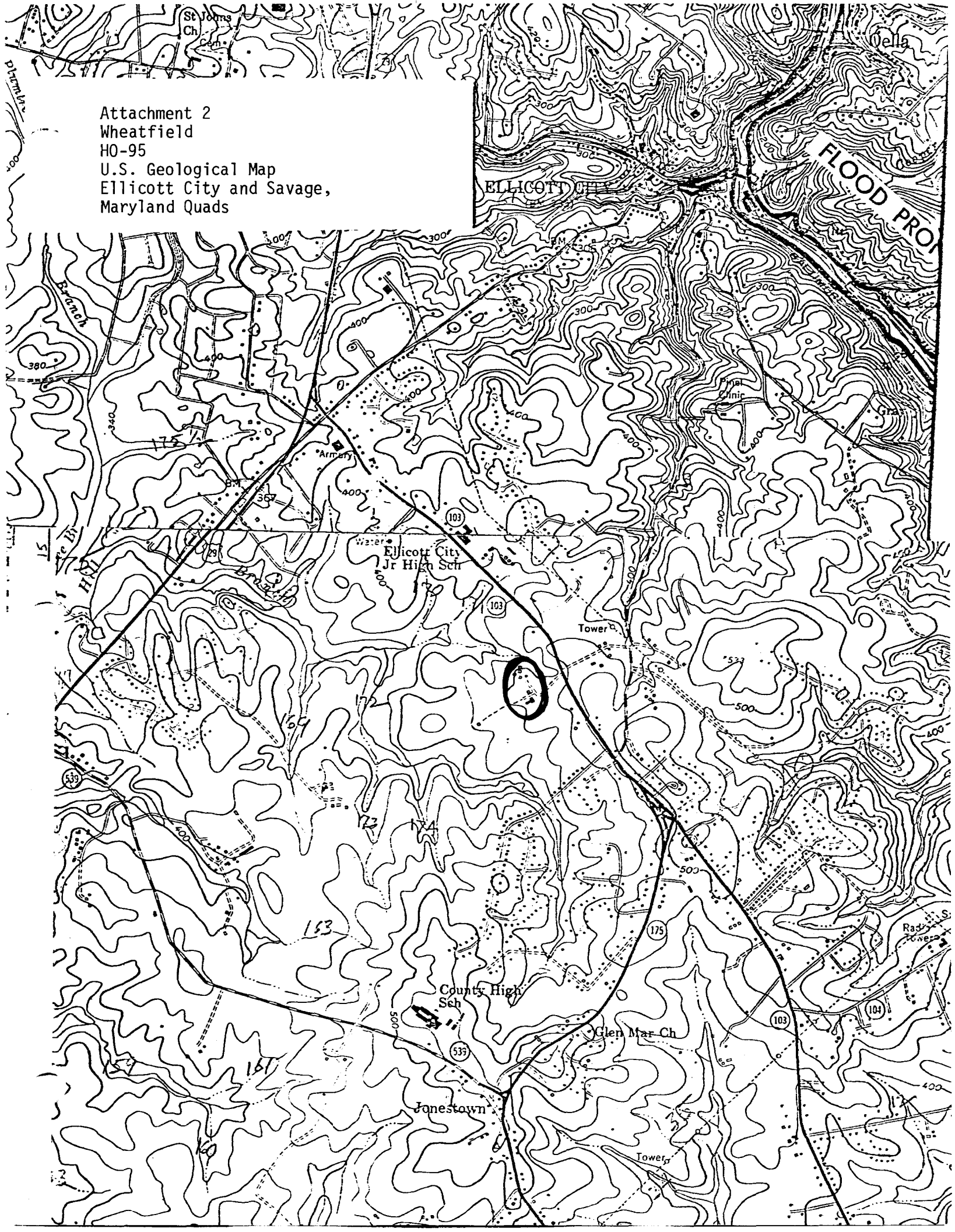



H0.95

from the east

566A

Wheatfields

JSE 6/72



40.95

from the west

566A

Wheat-fields

JSZ 6/22



CLEORA BARNES THOMPSON  
PLANNING CONSULTANT  
HISTORICAL SITES SURVEY

WHEATFIELDS

H0-95

MAY, 1977

(SOUTH)