

HO-709

Architectural Survey File

This is the architectural survey file for this MIHP record. The survey file is organized reverse-chronological (that is, with the latest material on top). It contains all MIHP inventory forms, National Register nomination forms, determinations of eligibility (DOE) forms, and accompanying documentation such as photographs and maps.

Users should be aware that additional undigitized material about this property may be found in on-site architectural reports, copies of HABS/HAER or other documentation, drawings, and the “vertical files” at the MHT Library in Crownsville. The vertical files may include newspaper clippings, field notes, draft versions of forms and architectural reports, photographs, maps, and drawings. Researchers who need a thorough understanding of this property should plan to visit the MHT Library as part of their research project; look at the MHT web site (mht.maryland.gov) for details about how to make an appointment.

All material is property of the Maryland Historical Trust.

Last Updated: 05-03-2004

**INDIVIDUAL PROPERTY/DISTRICT
MARYLAND HISTORICAL TRUST
INTERNAL NR-ELIGIBILITY REVIEW FORM**

Property/District Name: 10756 Scaggsville Road Survey Number: HO-709

Tax Parcel#: 5

Project: Maryland 216/29 Project Planning Study Agency: MDOT-SHA

Site visit by MHT Staff: no yes Name _____ Date _____

Eligibility recommended _____ Eligibility **not** recommended X

Criteria: A B C D Considerations: A B C D E F G None

Justification for decision: (Use continuation sheet if necessary and attach map)

The house at 10756 Scaggsville Road is not eligible due to the fact that it does not meet National Register Criteria A, B, C, or D. Preliminary research has not revealed any association between the dwelling and events that have made a significant contribution to the broad patterns of our history (Criterion A) or the lives of persons significant in our past (Criterion B). Vernacular in design, it is neither unusual nor distinguished; it does not represent the work of a master or display high artistic merit (Criterion C). There is no evidence that the property is likely to yield information important in history or prehistory (Criterion D). Thus, the property is not National Register-eligible.

Documentation on the property/district is presented in: Maryland Historical Trust Inventory Form

and Maryland 29/216 Project Planning Report

Prepared by: Tracerics, 5420 Western Ave., Chevy Chase, MD 20815 November 1997

Robert Conner Date 7/10/98
Reviewer, Office of Preservation Services

NR program concurrence: yes no not applicable

B. Kuntz Date 3/31/99
Reviewer, NR Program

Am

CAPSULE SUMMARY
10756 Scaggsville Road
(HO-709)

Constructed at the turn of the twentieth century, the vernacular dwelling at 10756 Scaggsville Road was originally an T-shaped two-story, three-bay, cross gable roof residence. The house is set on a solid stone foundation, and the wood frame walls are clad in vinyl German siding. The cross gable roof is covered in standing seam sheet metal. An exterior brick chimney, laid in stretcher bond, rises at the original section of the northwest elevation, and a one-story, two-bay porch with square wood posts and a standing seam, sheet metal, shed roof extends across a portion of the facade. A large, two-story, single pile addition extended the rear ell, and a one-story, L-shaped porch with a shed roof was erected at the eastern interior corner of the southwest and northeast elevations.

The dwelling was most likely built by John H. Hines after he purchased the property in November of 1892. The property transferred to John T. and Ida Fyock Hines in 1942, upon the death of John H. Hines. The Hines family still retains ownership of 10756 Scaggsville Road.

The property at 10756 Scaggsville Road illustrates a typical farm house at the turn-of-the-century. The original house and four historic outbuildings provide a strong example of a working farm in rural Maryland during the beginning of the twentieth century.

MARYLAND HISTORICAL TRUST
MD INVENTORY OF HISTORIC PROPERTIES

Inventory No. HO-709

=====

1. Name of Property

=====

historic name _____
common/other name _____

=====

2. Location

=====

street & number 10756 Scaggsville Road not for publication _____
city or town Laurel vicinity _____ state Maryland code MD
county Howard code 027 zip code 20723

=====

3. State/Federal Agency Certification N/A

=====

4. National Park Service Certification N/A

=====

5. Classification

=====

Ownership of Property (Check all that apply)

- private
- public-local
- public-State
- public-Federal

Category of Property (Check only one box)

- building(s)
- district
- site
- structure
- object

Number of Resources within Property

Contributing	Noncontributing	
<u>5</u>	<u>2</u>	buildings
<u>0</u>	<u>0</u>	sites
<u>0</u>	<u>0</u>	structures
<u>0</u>	<u>0</u>	objects
<u>5</u>	<u>2</u>	Total

Is this property listed in the National Register?

Yes _____ Name of Listing _____
No X

=====
6. Function or Use
=====

Historic Functions (Enter categories from instructions)

Cat: DOMESTIC Sub: SINGLE DWELLING
AGRICULTURE AGRICULTURAL OUTBUILDINGS

Current Functions (Enter categories from instructions)

Cat: DOMESTIC Sub: SINGLE DWELLING
AGRICULTURE AGRICULTURAL OUTBUILDINGS

=====
7. Description
=====

Architectural Classification (Enter categories from instructions)

Vernacular

Materials (Enter categories from instructions)

foundation Solid: Stone, Parged
roof Cross Gable: Standing Seam Sheet Metal
walls Wood Frame: Vinyl German Siding
other _____

Narrative Description (Describe the historic and current condition of the property.)

See Continuation Sheet No. 7-1

=====
8. Statement of Significance
=====

Applicable National Register Criteria (Mark "x" in one or more boxes for the criteria qualifying the property for National Register listing)

- A Property is associated with events that have made a significant contribution to the broad patterns of our history.
- B Property is associated with the lives of persons significant in our past.
- C Property embodies the distinctive characteristics of a type, period, or method of construction or represents the work of a master, or possesses high artistic values, or represents a significant and distinguishable entity whose components lack individual distinction.
- D Property has yielded, or is likely to yield information important in prehistory or history.

Criteria Considerations (Mark "X" in all the boxes that apply.)

- A owned by a religious institution or used for religious purposes.
- B removed from its original location.
- C a birthplace or a grave.
- D a cemetery.
- E a reconstructed building, object, or structure.
- F a commemorative property.
- G less than 50 years of age or achieved significance within the past 50 years.

Maryland Inventory of Historic Properties
10756 Scaggsville Road
Howard County, Maryland

Inventory No. HO-709
Page 4

=====
Areas of Significance (Enter categories from instructions)

Architecture
Agriculture

Period of Significance ca. 1890-present

Significant Dates ca. 1890-1900

Significant Person (Complete if Criterion B is marked above)

Cultural Affiliation Undefined

Architect/Builder Unknown

Narrative Statement of Significance (Explain the significance of the property.)

See Continuation Sheet No. 8-1

=====
9. Major Bibliographical References
=====

(Cite the books, articles, legal records, and other sources used in preparing this form.)

Howard County Land Records, Recorder of Deeds, Howard County, Ellicott City, Maryland.

=====
10. Geographical Data
=====

Acreage of Property 15.85 acres

Verbal Boundary Description (Describe the boundaries of the property.)

The property at 10756 Scaggsville Road is designated as Parcel 5, as indicated on Map 46, Grid 11.

Boundary Justification (Explain why the boundaries were selected.)

The property at 10756 Scaggsville Road has historically been associated with Parcel 5 since the building's construction circa 1890.

=====
11. Form Prepared By
=====

name/title Kristyna G. Olsen, Architectural Historian
organization Traceries date October 29, 1997
street & number 5420 Western Avenue telephone 301/656-5283
city or town Chevy Chase state MD zip code 20815

=====
12. Property Owner
=====

name John T. and Ida Fyock Hines
street & number 10752 Scaggsville Rd. telephone _____
city or town Laurel state MD zip code 20723

MARYLAND INVENTORY OF HISTORIC PROPERTIES
CONTINUATION SHEET

Inventory No. HO-709

Section 7 Page 1

10756 Scaggsville Road
name of property
Howard County, Maryland
county and state

=====
Constructed at the turn of the century, the vernacular dwelling at 10756 Scaggsville Road was originally an T-shaped two-story, three-bay, cross gable roof residence. The house is set on a solid stone foundation, and the wood frame walls are clad in vinyl German siding. The cross gable roof is covered in standing seam sheet metal. An exterior brick chimney, laid in stretcher bond, rises at the original section of the northwest elevation, and a one-story, two-bay porch with square wood posts and a standing seam, sheet metal, shed roof extends across a portion of the facade. A large, two-story, single pile addition extended the rear ell, and a one-story, L-shaped porch with a shed roof was erected at the eastern interior corner of the southwest and northeast elevations.

The house is set on a slight rise above the road. The property is dominated to the south by mature trees, and several outbuildings stand to the east of the house. The dwelling addresses Scaggsville Road to the southwest, and a gravel drive leads from the road across the northeast edge of the property, past the main facade, provides access to the various outbuildings.

EXTERIOR DESCRIPTION:

The facade of the house is L-shaped, with a one-story two-bay porch in the corner of the "L." The main entrance to the house is situated in the center bay of the three-bay southwest elevation. This entrance is marked with a non-original, single-leaf, panel-and-light metal door. To either side of the entrance, the first story of the house is pierced with two replacement, 6/1 metal sash windows. The second story is pierced by two replacement, 6/1 metal sash windows, one in the gable end wall, one above the entrance, and one in the southeast wall within the corner of the "L."

The northwest elevation consists of the original house with the large, two-story addition to the north. The exterior brick chimney, laid in stretcher bond, rises at the north of the original section of the house. The first story of the original house is pierced by two non-original, 6/1 metal sash windows, and the second story is pierced by two non-original, 6/1 metal sash windows. The first and second stories of the addition are each pierced by a single 6/1 metal sash window.

The northeast elevation consists of the gable end of the rear ell and the rear wall of the original side gable portion of the house. On the northeast elevation, the first story of the original house is entirely covered by the one-story, L-shaped porch with a shed

MARYLAND INVENTORY OF HISTORIC PROPERTIES
CONTINUATION SHEET

Inventory No. HO-709

Section 7 Page 2

10756 Scaggsville Road
name of property
Howard County, Maryland
county and state

=====
roof with asphalt shingles. Beneath the porch, on the first story, is an original, single leaf, wood paneled door with lights. The first story is also pierced by one non-original, 6/1 metal sash window. The second story is pierced by one non-original, 6/1 metal sash window.

The first story of the southeast elevation is entirely covered by the one-story, L-shaped porch with an asphalt shingled shed roof. Beneath the porch, on the first story, is a salvaged, single leaf, wood paneled door with lights. The first story of this elevation is pierced by two non-original, 6/1 metal sash windows. The second story, is marked by three non-original 6/1 metal sash windows of varying sizes, two within the original rear ell, and one in the addition.

OUTBUILDINGS:

To the southeast of the main house stand two circa 1920, wood frame sheds. The larger shed is set on a stone pier foundation. It has a gable roof with metal sheathing and wood vertical board siding. The smaller shed is also set on a stone pier foundation and has a gable roof, but it clad in board and batten siding.

A large wood frame barn is located to the east of the main dwelling. The original portion of this hay barn dates to circa 1920. The original building sits on a stone foundation and has vertical board siding. The entire building is covered with a metal gable roof. A frame addition on the northeast side sits on a concrete block foundation.

A two-story concrete block barn is also located to the east of the main house. This 1950s building has a metal gable roof and allows vehicles to pass through the interior structure.

A 1930s dilapidated wood frame shed lays to the northeast of the main dwelling. The shed has board and batten siding and a gable roof.

A 1980s wood frame, machine shed is located to the north of the main building. The shed is covered with metal siding and has a gable roof.

MARYLAND INVENTORY OF HISTORIC PROPERTIES
CONTINUATION SHEET

Inventory No. HO-709

Section 8 Page 1

10756 Scaggsville Road
name of property
Howard County, Maryland
county and state

=====

Erected circa 1890, the vernacular house at 10756 Scaggsville Road is typical of the dwellings constructed in rural communities across the country in the last decades of the nineteenth century in its lack of detail and ornamentation.

The dwelling was most likely built by John H. Hines after he purchased the property in November of 1892. The property transferred to John T. and Ida Fyock Hines in 1942, upon the death of John H. Hines. The Hines family still retains ownership of 10756 Scaggsville Road.

The property at 10756 Scaggsville Road illustrates a typical farm house at the turn-of-the-century. The original house and four historic outbuildings provide a strong example of a working farm in rural Maryland during the beginning of the twentieth century.

MARYLAND INVENTORY OF HISTORIC PROPERTIES
CONTINUATION SHEET

Inventory No. HO-709

10756 Scaggsville Road

name of property

Howard County, Maryland

county and state

=====

HISTORIC CONTEXT:

Geographic Organization:

Piedmont

Chronological/Development Period (s):

Industrial/ Urban Dominance (1870-1930)

Modern Period (1930-present)

Prehistoric/Historic Period Theme (s):

Architecture, Landscape, and Community
Planning

RESOURCE TYPE(S)

Category:

Building

Historic Environment:

Rural

Historic Function (s):

DOMESTIC/ Single Dwelling

AGRICULTURE/ Agricultural Outbuildings

Known Design Source:

Unknown

RESOURCE SKETCH MAP

HO-709

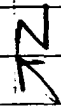

10750 Scaggsville Rd,
Laurel, Howard County, MD

1980s pre-fab
metal machine shed

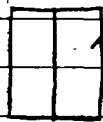

dilapidated
frame shed

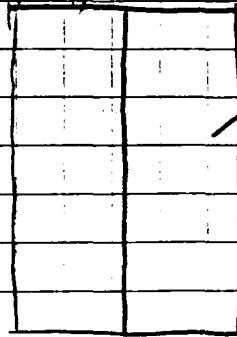

2-story
1950s
concrete
block barn

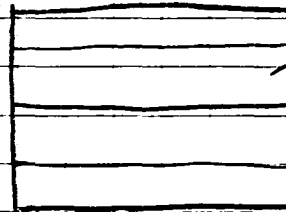
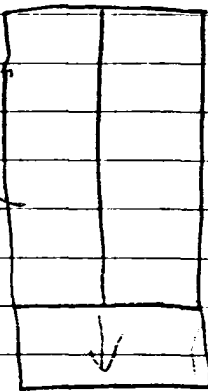

1910s-20s
frame
barn

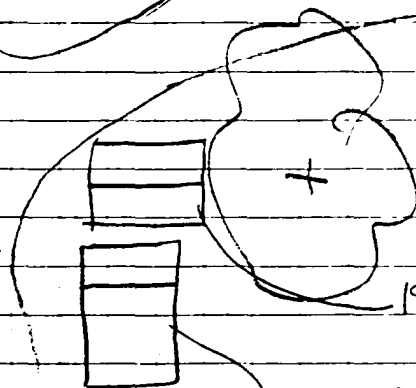
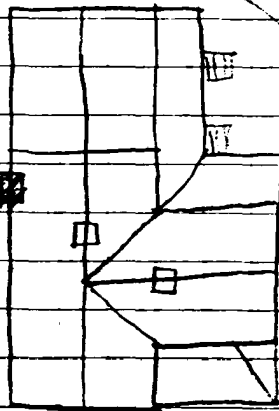

1920s frame
shed

1920s frame shed

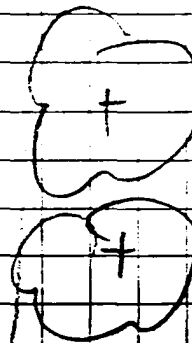
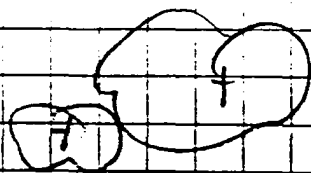

Scaggsville Rd

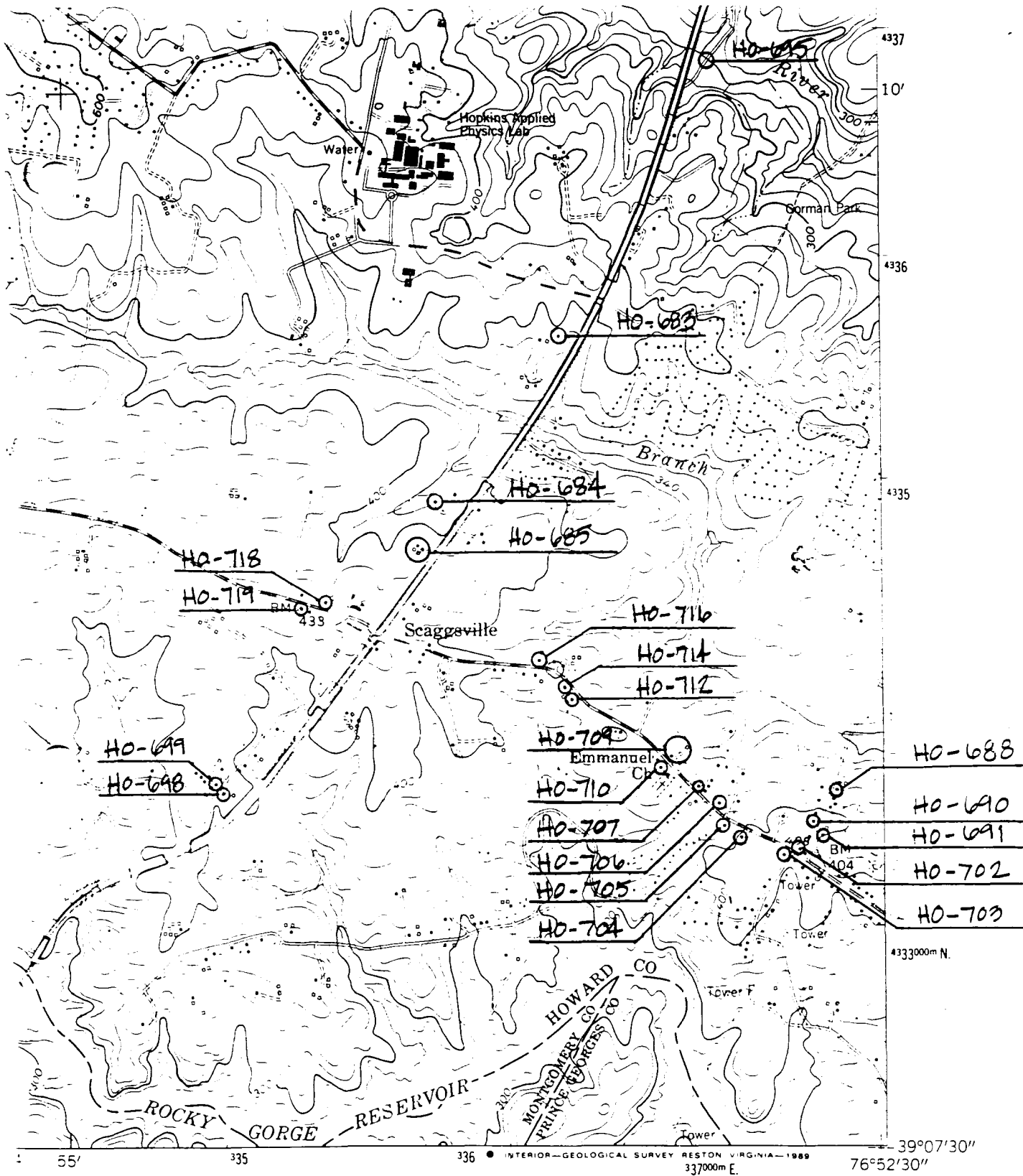

1:10,000
1/4 MILE

ROAD CLASSIFICATION

Heavy-duty		Light-duty	
Medium-duty		Unimproved dirt	
U. S. Route		State Route	

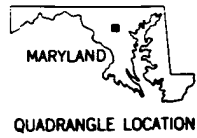

CLARKSVILLE, MD.
NW/4 LAUREL 15' QUADRANGLE
39076-B8-TF-024

1957
PHOTOREVISED 1979
DMA 5662 III NW-SERIES V833

To place on the predicted North American Datum 1983
move the projection lines 8 meters south and
26 meters west as shown by dashed corner ticks

(LAUREL)
5662 III SE



HO-709

10756 Scaggsville Rd,
Howard County, MD

Traceries

September 1997

Maryland SHPO

HOUSE, SOUTH CORNER

1 OF 11



Ho-709

10756 Scaggsville Rd.

Howard County, MD

Traceries

September 1997

Maryland SHPO

House, W Corner

2 OF 11



HO-709

10756 Scaggsville Rd.

Howard County, MD

Traceries

September 1997

Maryland SHPO

House, NW Elevation

3 of 11



HO-709

10750 Scaggsville Rd.

Howard County, MD

Traceries

September 1997

Maryland SHPO

House, NE // Elevation

4 of 11



HO-709
10756 Scaggsville Rd.
Howard County, MD
Tracenes
September 1997
Maryland SHPO
House, SE Elevation
5 of 11



Ho-709

10756 Scaggsville Rd.

Howard County, MD

Traces

September 1997

Maryland SHPO

Barn, W corner

6 of 11



Ho-709

10756 Scaggsville Rd.

Howard County, MD

Traceries

September 1997

Maryland SHPO

Barn, NW Elevation

7 of 11

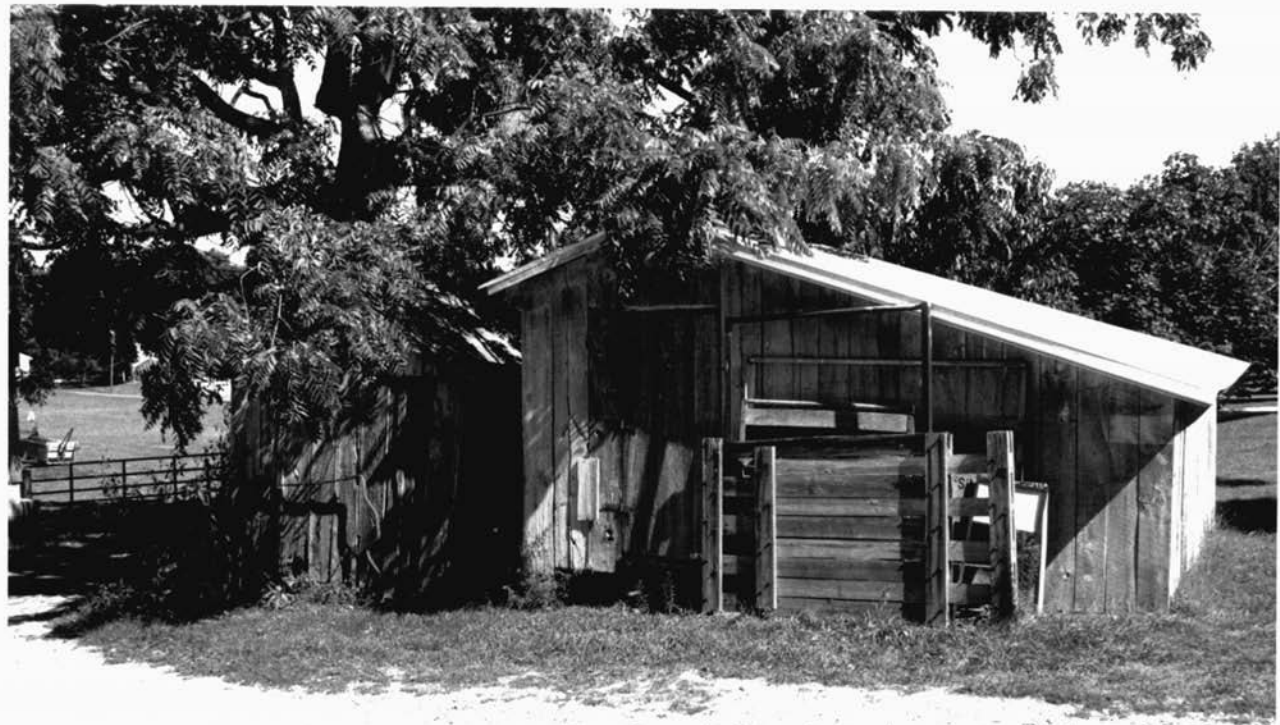

HO-709

10756 Scaggsville Rd.

Howard County, MD

Traceries

September 1997

Maryland SHPO

Sheds, NW Elevation

8 of 10



HO-709

10756 Scaggsville Rd

Howard County, MD

Tracenes

September 1997

Maryland SHPO

Barn, W corner

9 of 14



HO-709

10756 Scaggsville Rd.

Howard County, MD

Traceries

September 1997

Maryland SHPO

Shed, SS corner

10 of 10



HO-709

10756 Scaggsville Rd.

Howard County, MD

Traceries

September 1997

Maryland SHPO

Machine Shed, SE Elevation

11 of 11