

HO-532

John Holland House

Architectural Survey File

This is the architectural survey file for this MIHP record. The survey file is organized reverse-chronological (that is, with the latest material on top). It contains all MIHP inventory forms, National Register nomination forms, determinations of eligibility (DOE) forms, and accompanying documentation such as photographs and maps.

Users should be aware that additional undigitized material about this property may be found in on-site architectural reports, copies of HABS/HAER or other documentation, drawings, and the “vertical files” at the MHT Library in Crownsville. The vertical files may include newspaper clippings, field notes, draft versions of forms and architectural reports, photographs, maps, and drawings. Researchers who need a thorough understanding of this property should plan to visit the MHT Library as part of their research project; look at the MHT web site (mht.maryland.gov) for details about how to make an appointment.

All material is property of the Maryland Historical Trust.

Last Updated: 05-03-2004

HO-532

The John Holland House
Laurel
Private

circa 1841

The John Holland House faces east on the west side of Washington Boulevard 0.4 miles north of Whiskey Bottom Road. It is a three bay wide, one room deep, two story high, gabled roof (running north-south) stone (covered with stucco) building, resting on a stone foundation, with brick chimneys inset into its north and west walls and a four bay wide, one room deep, two story high, shed roofed, brick (laid in English Garden Wall brick bond) west wing, creating an "L" plan.

Fenestration for the house is vertically aligned, rectangular and double-hung, holding six-over-six lights. The east and west rectangular entrances of the stone house are located in the building's south end bay, while the south rectangular entrance for the brick section is located in the west end bay.

An unusual placement of chimneys and floor plan are seen in the stone section which features a not unusual end bay staircase and hall, coupled with two one bay wide, one room deep rooms leading into one another, which feature original mantelpieces, located in the centre of the west and the north walls.

Steeped in Howard County folklore which claims the building to have been constructed by the Snowden family in the eighteenth century, the building does stand on land once a part of a tract called "Snowden's New Birmingham Manor", which was deeded "with premises" to John Holland by the Savage Manufacturing Company in 1841.

HO-532

Dist. 6

C.C.

MAGI # 1A05325404

MARYLAND HISTORICAL TRUST

INVENTORY FORM FOR STATE HISTORIC SITES SURVEY

1 NAME

HISTORIC

The John Holland House

AND/OR COMMON

2 LOCATION

STREET & NUMBER

U.S. Route 1 - 9700 Blk. of W.S. & Washington Boulevard, U.S. Rt. 1

CITY, TOWN

Laurel

CONGRESSIONAL DISTRICT

6th

STATE

Maryland

COUNTY

Howard

3 CLASSIFICATION

CATEGORY

- DISTRICT
- BUILDING(S)
- STRUCTURE
- SITE
- OBJECT

OWNERSHIP

- PUBLIC
- PRIVATE

PUBLIC ACQUISITION

- IN PROCESS
- BEING CONSIDERED

STATUS

- OCCUPIED
- UNOCCUPIED
- WORK IN PROGRESS
- ACCESSIBLE
- YES RESTRICTED
- YES UNRESTRICTED
- NO

PRESENT USE

- AGRICULTURE
- COMMERCIAL
- EDUCATIONAL
- ENTERTAINMENT
- GOVERNMENT
- INDUSTRIAL
- MILITARY
- MUSEUM
- PARK
- PRIVATE RESIDENCE
- RELIGIOUS
- SCIENTIFIC
- TRANSPORTATION
- OTHER

4 OWNER OF PROPERTY

NAME

Mr. and Mrs. A. W. Sherwood

Telephone #:

STREET & NUMBER

Route 1 Aerolab

CITY, TOWN

Laurel

VICINITY OF

STATE, zip code

Maryland 20810

5 LOCATION OF LEGAL DESCRIPTION

COURTHOUSE, REGISTRY OF DEEDS, ETC

Tax Map 47, p. 764
Hall of Records

Liber #: 392

Folio #: 89

STREET & NUMBER

Howard County Court House

CITY, TOWN

Ellicott City

STATE

Maryland

6 REPRESENTATION IN EXISTING SURVEYS

TITLE

Howard County Historic Sites Inventory

DATE

1978-1979

FEDERAL STATE COUNTY LOCAL

DEPOSITORY FOR SURVEY RECORDS

Maryland Historical Trust

CITY, TOWN

21 State Circle, Annapolis

STATE

Maryland

7 DESCRIPTION

CONDITION		CHECK ONE	CHECK ONE
<input type="checkbox"/> EXCELLENT	<input type="checkbox"/> DETERIORATED	<input type="checkbox"/> UNALTERED	<input checked="" type="checkbox"/> ORIGINAL SITE
<input checked="" type="checkbox"/> GOOD	<input type="checkbox"/> RUINS	<input checked="" type="checkbox"/> ALTERED	<input type="checkbox"/> MOVED DATE _____
<input type="checkbox"/> FAIR	<input type="checkbox"/> UNEXPOSED		

DESCRIBE THE PRESENT AND ORIGINAL (IF KNOWN) PHYSICAL APPEARANCE

The John Holland House faces east on the west side of Washington Boulevard, 0.4 miles north of Whiskey Bottom Road, behind the Aerolab Building. It is a three bay wide, one room deep, two story high, gabled roof (running north-south) stone (covered with Stucco) building, resting on a stone foundation, with square brick chimney inset into its north wall and a tall, wide, brick chimney inset into the south side of its west wall. A four bay wide, one room deep, two story high, shed roofed brick (laid in English garden wall brick bond) west wing creates an "L" plan. It rests on a stone foundation and runs from the north side of the building's west wall, with wide brick chimney inset into its central interior dividing wall.

Fenestration for the entire house is vertically aligned, rectangular and double-hung, holding six-over-six lights, underlined by flat wooden sills. The windows of the brick section are decorated with flat arched, stretcher brick lintels and its second floor windows on the south wall are decorated with wooden shutters. Two six-light basement windows are located in the central and north bays of the building's east wall. Windows on this elevation are decorated with green wooden shutters.

An open bible and cross paneled south bay entrance is located on the west wall of the old stone house, covered by a hipped roof hood and fronted by a cement and stone patio, which connects with that brick patio along the entire south wall of the brick section of the house, which is laid on a stone foundation, with three semi-circular stone and brick steps on the south elevation. Four open wooden steps, flanked by a wooden railing, lead to a one story high, open porch on the south bay of the building's east wall, which holds the rectangular paneled east entrance, surmounted by a three light transom and covered by a hipped roof hood. The south wall of the stone house holds a single, rectangular, attic window, while its north wall holds two such attic windows. This latter wall is covered with ivy, and difficult to discern.

The south wall of the brick section of the house holds a rectangular, open bible and cross paneled entrance door, surmounted by a three light transom and decorated with a flat arched, stretcher brick lintel, in its west bay.

The west wall of the brick section holds two first and second floor windows, while the north wall holds four second floor windows. Two first floor windows rest in its two east bays. A square, four light window is located in its second west bay with another window now placed in its end west bay.

A rectangular, cellar entrance is set into the east bay of this north wall, covered with a gabled roof, placed over the brick welled entrance, which holds eight, poured in place, cement steps.

A hall has been created along the brick section's south wall. Otherwise, the building's original plan remains intact. The huge cooking fireplace inset into the kitchen's east interior wall can still be seen, while the ceiling joists have been exposed in the kitchen to reveal the wide, random width floor boards of the second floor.

CONTINUE ON SEPARATE SHEET IF NECESSARY

The interior is divided, then into two, two bay wide rooms, whose dividing wall originally held a mantle on each side, serving each room. Today, that on the east side has been blocked in and an east-west wall along its south wall created, leading into the old stone house, which is believed to be a later addition.

The stone section's plan is almost unique for Howard County. It features an end staircase and hall with two rooms to the north, one bay wide, one room deep, leading from one to another. Each has its own chimney. That on the north end featuring a central chimney inset into the building's north wall and that room, located in the middle bay featuring a large mantelpiece on its west wall, quite unusual for Howard County, which features either a central hall plan with rooms on either side and end chimneys and mantelpieces or a central hall plan with rooms on either side and chimneys rising from either side of the central hall. Even early double pile organization generally features a bit of symmetry in the placement of central mantelpieces on end walls, rising to create one very wide stone or brick chimney.

The stone section of the building retains its wide, random width pine floors and first floor mantelpieces.

A frame tenant house and some auxiliary buildings lie west of the house.

In addition, the Aerolab Building has used stones from a stone foundation found on the property, which may have at one time been used as the foundation for a barn. The office entrance is made extremely handsome by this exposed stone west wall and a curved open staircase on the north side of the entrance vestibule.

8 SIGNIFICANCE

HO - 532

Dist. 6

PERIOD	AREAS OF SIGNIFICANCE -- CHECK AND JUSTIFY BELOW			
<input type="checkbox"/> PREHISTORIC	<input type="checkbox"/> ARCHEOLOGY-PREHISTORIC	<input type="checkbox"/> COMMUNITY PLANNING	<input type="checkbox"/> LANDSCAPE ARCHITECTURE	<input type="checkbox"/> RELIGION
<input type="checkbox"/> 1400-1499	<input type="checkbox"/> ARCHEOLOGY-HISTORIC	<input type="checkbox"/> CONSERVATION	<input type="checkbox"/> LAW	<input type="checkbox"/> SCIENCE
<input type="checkbox"/> 1500-1599	<input type="checkbox"/> AGRICULTURE	<input type="checkbox"/> ECONOMICS	<input type="checkbox"/> LITERATURE	<input type="checkbox"/> SCULPTURE
<input type="checkbox"/> 1600-1699	<input checked="" type="checkbox"/> ARCHITECTURE	<input type="checkbox"/> EDUCATION	<input type="checkbox"/> MILITARY	<input type="checkbox"/> SOCIAL/HUMANITARIAN
<input type="checkbox"/> 1700-1799	<input type="checkbox"/> ART	<input type="checkbox"/> ENGINEERING	<input type="checkbox"/> MUSIC	<input type="checkbox"/> THEATER
<input checked="" type="checkbox"/> 1800-1899	<input type="checkbox"/> COMMERCE	<input type="checkbox"/> EXPLORATION/SETTLEMENT	<input type="checkbox"/> PHILOSOPHY	<input type="checkbox"/> TRANSPORTATION
<input type="checkbox"/> 1900-	<input type="checkbox"/> COMMUNICATIONS	<input type="checkbox"/> INDUSTRY	<input type="checkbox"/> POLITICS/GOVERNMENT	<input checked="" type="checkbox"/> OTHER (SPECIFY) (local history)
		<input type="checkbox"/> INVENTION		

SPECIFIC DATES Circa 1841

BUILDER/ARCHITECT

STATEMENT OF SIGNIFICANCE The Holland House is significant architecturally, as a representative of the vernacular style in Howard County stone architecture of the early nineteenth century, featuring a degree of uniqueness in the placement of its wide brick chimneys and the floor plan of the stone section of the house, which features eighteen inch wide exterior stone walls, covered with stucco. Otherwise, it is rather typical of the two story high, three bay wide, one room deep, gabled roof, stone houses, with kitchen wings, forming an "L" or "T" plan, which are seen throughout Howard County, Maryland.

Historically, it is significant to the residents of the Laurel area and Howard County as a focal point for a great deal of folklore associated with the Snowden family, a family of prominence and influence in this part of Maryland. Stories surround the house and are impossible to prove, but are an integral part of the social fabric of this section of the County. Money is said to have been buried and dug up in the dirt floor basement of the house by previous residents while "George Washington is reputed to have spent a week-end here." This latter story may be associated truly with Montpelier, but there is presently no evidence in behalf of this house. Since the house is believed to date from the early nineteenth century, rather than an eighteenth century date, all these stories are pure conjecture and are passed on as a part of the folklore associated with the house.

Every stone house in Howard County today has importance architecturally. Where there were once hundreds of such houses, today their number has dwindled. This house, too, differs from the more modest stone houses, located on larger farms and used as slave-tenant houses for those working the land.

The scale and interior detail of the house is indicative of a finer residence, where guests were entertained and warmth and comfort were provided. The end hall and staircase created space for receptions and an architectural focal point for the house, while mantles in each room created comfort and warmth for that period.

Recently, the building's history has been tied to the industrialization of the Route 1 corridor and by its purchase for use primarily as an industrial site, upon which AERO LAB has been constructed, by Mr. and Mrs. A. W. Sherwood, present owners.

The old stone house, which is perched upon a hill, is partially hidden from view by the trees and tall shrubs which surround it and act as a screening devise, in conjunction with the slope of ground, from the modern building below and east of the house.

Where the house shares its eight acre site with its industrial neighbor, it once commanded some one hundred and eighty-one (181) acres of land in 1875, when a map of the land was made in an Equity court case between the family of John Holland and his creditors.

CONTINUE ON SEPARATE SHEET IF NECESSARY

During the mid-twentieth century the building was owned and occupied by Anna and Walter Schmidt, acquired from Mr. Thomas R. Keeseey, who bought the house on February 17, 1931 from Clay T. and Eliza Halverson.

The house and some surrounding land were part of the same property conveyed by Mary A. Hartsock to Clay T. Halverson on October 31, 1917 (libev 104 folio 420). This property was part of the same land deeded from George W. King to Sarah W. Smith for \$175.00 on April 3, 1883, and included Lot #3 (37 acres of land) and what was referred to as the widow's dower of 30 acres, both of which are noted on the map of 1875. (Please see Attachment 5). See also a release made by Nathan Pumphrey to George A. and Susan C. King on August 4, 1883, which was tied into a former transaction on March 31, 1879, in which George and Susan King assured the land and premises to Nathan Pumphrey.

At this point, between 1875 and 1883, several mortgages and releases occur, as well as a public auction on Jan 18, 1879 when Nathan Pumphrey acquired the house for \$3400. During this time the Hollands, a Thomas Hunt and Nathan Pumphrey were all involved. In the release to Sarah Smith, wife of Rodmond Smith on December 31, 1883, the ground and premises were included under the Widow's dower of thirty acres, as well as Lot #3 of 37 acres, and lot #4 of 71 acres. See Attachment 5 for a Map of this estate.

At the time it may be important to point out that this reference to a widow's dower stems from the Equity case of 1875, in which the court created a commission to lay out the estate of John Hilland as a Widow's dower to be given to Margaret Holland, as a life estate.

Before laying out the dower, the Commissioners, Jerome G. Berry, Seth W. Warfield, Thomas Marriott and A. H. Curtis had to swear the following oath before Thomas I. White, who was in turn sworn in due form of law:

You shall according to the best of your skill and judgment, lay off the dower, as directed by the foregoing commission and in all things truly and faithfully execute the powers given and perform the duties required of you by the said commission without favor or partiality to, or prejudice or ill will against any person interested therein, so help you God.

This information is inserted as an example of the moral rectitude of that day and age. Such an oath might be broken but it would not be done so lightly. A sworn oath with the words "so help you God" would cause men of that day to pause, as well as the words "best of your skill and judgment" and "perform...without favor...partiality...or ill will...."

Such legal procedures give us a mental picture of the ideals of the society of the nineteenth century, where a man's word was his bond and where high moral character, honesty, and integrity were the marks by which a man was judged worthy, not social and monetary prominence alone.

The land on which the present house sits is a part of the 30 acres, mentioned as the "Widow's Dower", which was described as being "on the South-West bank of Hammonds Branch".

In the 1841 deed from Savage Manufacturing Company to John Holland, the six and a quarter acre tract of land on which the house sat was called "Snowden's Birmingham Manor" and the one boundary of the property is "within ten feet of Hammonds Branch running down said branch and ten feet distant there from to the Washington Turnpike Road." This small piece of land "and premises" which John Holland purchased in 1841 is believed to be a part of the same land and premises we see today behind AEROLAB and which is noted on both the 1860 Martennet Map and the 1878 Hopkin's Atlas as the property of J. Holland.

From historic fact and a degree of solid evidence we go on to pure conjecture when we pass from the history of the Holland family home where six children (Jesse, Joseph F., Charles, John R., James A., and Mary E.) were raised to the folklore which surrounds the house, claiming it to have belonged to the Snowden family.

Mr. William Cook's book on Montpelier and the Snowden family relates that the house is believed to have been built between 1775 and 1780, for the daughter of a Snowden and that a Colonel Snowden, very rich, did reside there at one time.

No reference is made to "New Birmingham Manor." Three references are made to "Birmingham Manor" in Laurel, but none to New Birmingham. Among the private papers of the present owners is a copy of the will of a Samuel Snowden, who mentions his granddaughters, Rachel and Elizabeth. In Mr. William Cook's book we find a Samuel Snowden, b. Nov 2, 1728 who died on June 27, 1801 with two granddaughters Elizabeth and Rachel. The will is dated September 17, 1800 and its sixth item is as follows:

I give and devise to my two granddaughters, Elizabeth and Rachel Snowden - daughters of my deceased son Richard Snowden and to their respective heirs all my lot or parcel of land being my part of Birmingham Manor, lying in Anne Arundel County and containing 1335 acres to be divided between my said granddaughters and their heirs by a line drawn from the end at the eighth course of the said lot South 3° West to intersect the 65th course of the 8 lot - The Northern part of my said lot thus divided containing about 855 acres
I give to my said Granddaughter Elizabeth and to her heirs forever, The Southern most part of my said lot - This contains about 480 acres I give to my said granddaughter Rachel and to her heirs forever....

The will was witnessed by John Snowden, Thomas Snowden and John Chew Thomas.

Whether Rachel sold this land to the Savage Manufacturing Company, who in turn sold a piece of it, the house and land to John Holland, at this time, with the information available, is impossible to determine. No mention, either, is made in item six of a dwelling house on this property. The story remains a

piece of folklore until more proof can be made. Perhaps one of the granddaughters constructed a dwelling house there and called it "Snowden's New Birmingham Manor" or perhaps Richard Snowden, their deceased father, who married Hannah Moore Hopkins, constructed a dwelling house on his father's land. At this time we do not know. It is safe to assume the house stood there as "the premises" sold to John Holland, constructed sometime prior to 1841.

This bit of folklore is passed on to help furnish leads for those who may wish to investigate the history of the house further.

The house is significant to Howard County, Maryland and to the State as representative of a Howard County Stone house, constructed on a grand scale and as a house with associations with the prominent Snowden family.

For these reasons the house should be considered for inclusion to the National Register, the State Critical Areas Program and any local land mark legislation, should its owners so desire.

9 MAJOR BIBLIOGRAPHICAL REFERENCES

Land Records of Howard County and Equity Records
Interview with Mr. & Mrs. Sherwood, owners of the house, and examination of their private papers.
Warfield, J.D. Founders of Anne Arundel and Howard Counties, Maryland. Baltimore, 1973.
Interview with Mr. and Mrs. Walter Schmidt, previous owners of the house. *
CONTINUE ON SEPARATE SHEET IF NECESSARY

10 GEOGRAPHICAL DATA

ACREAGE OF NOMINATED PROPERTY 7.71

Please see Attachment 1, Tax Map 47

VERBAL BOUNDARY DESCRIPTION

Please see Howard County Land Records, Liber 392 Folio 89

LIST ALL STATES AND COUNTIES FOR PROPERTIES OVERLAPPING STATE OR COUNTY BOUNDARIES

STATE	Maryland	COUNTY	Howard
STATE		COUNTY	

11 FORM PREPARED BY

NAME / TITLE

Cleora Barnes Thompson, Archivist

ORGANIZATION

Office of Planning & Zoning-Comprehensive Planning Section

DATE

STREET & NUMBER

3450 Court House Drive

TELEPHONE

CITY OR TOWN

Ellicott City

STATE

Maryland

The Maryland Historic Sites Inventory was officially created by an Act of the Maryland Legislature, to be found in the Annotated Code of Maryland, Article 41, Section 181 KA, 1974 Supplement.

The Survey and Inventory are being prepared for information and record purposes only and do not constitute any infringement of individual property rights.

RETURN TO: Maryland Historical Trust
The Shaw House, 21 State Circle
Annapolis, Maryland 21401
(301) 267-1438

* Interview with Mr. John Brennan, 513 Main Street, Laurel, Md. (301-498-1515), writer for The Laurel Leader, who investigated the history of the house. Cook, William G. Montpelier and the Snowden Family. PS-1108

HO-532
The John Holland House
Part 1 of a map of the Estate
of J. C. Holland, 1875
Howard County Equity
Records

OF THE ESTATE OF THE LATE

J. C. HOLLAND

Area 181 A IR 37P

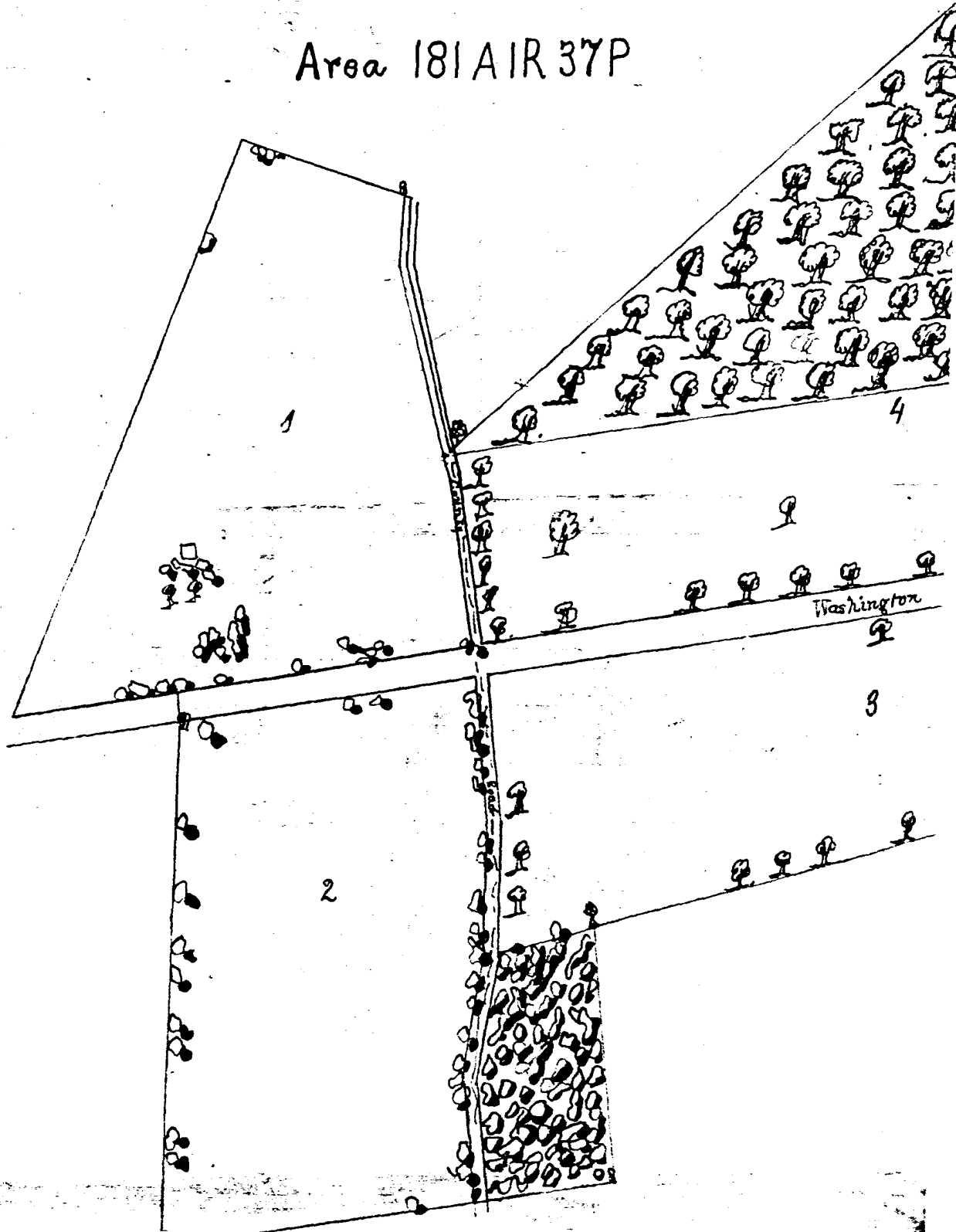

Attachment 5
HO-532
The John Holland House
Part 2 of a map of the Estate of
J. C. Holland, 1875
Howard County Equity Records

ATE
ND

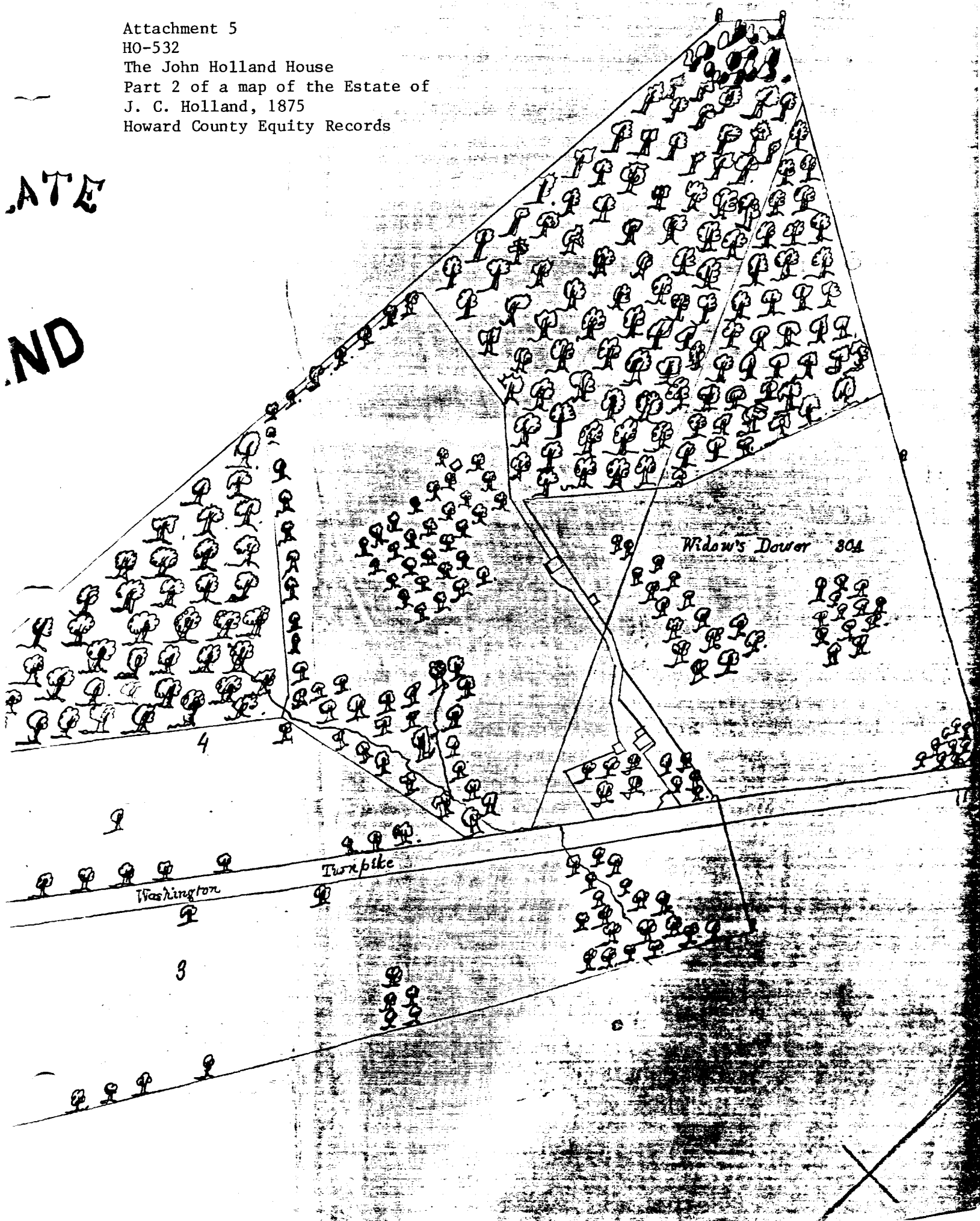

Attachment 1
 HO-532
 The John Holland House
 Tax Map 47.

HUTCHISON, JR., ET. AL
 497/577
 266.73A.
 RMH

LAUREL HARNES RACING ASSOC INC
 305/172
 89.89A.
 P.142

TRAVENOL
 LAB., INC.
 634/749
 11.50A.
 P.145

TRAVENOL L
 639/180
 23.24A.
 P.197

PAR (B)
 30.09A.

HO. CO. TITLE
 HOLDING CO.
 Δ-26/43
 P.886

BALTO. GAS & ELE.
 CO.
 588/166
 14.83A.
 R.863

P.910

WM. A. HALL, SR
 ET. AL.
 04/435
 7.63A.
 P.756

CLARA D.
 DIDWICK
 522/297 - ET. AL.
 3.86A
 P.179

R. GALVIN
 98/301
 20A.
 P.150

ANDREW SCOVITCH
 204/304
 58.0A.
 P.543

668/327
 3.71A.
 P.193
 A.W. SHERWOOD
 392/89
 7.71
 P.764

623/174
 5.74A.
 P.877
 R.E. OGBURN
 412/305
 6.82A.
 P.540

BALTO. GAS & ELECTRIC CO.
 572/712
 10.88A. P.859

787/457
 8.00A.
 P.776

MAP 50
 Δ-2.435

TAM
 REALTY
 CO. COMM. OF MD. CO.
 274/525 362/599 495/667
 R.303 R.302 P.542

P.873

885

TAXATION	PROPERTY LINE		
	SUB-DIVISION BOUNDARY		
CONTINUING OWNERSHIP	PARCEL NUMBER	P. 548 (ASSIGNED TO IDENTIFY AND INDEX OWNERSHIP. MUST BE PRECEDED BY MAP NUMBER.)	600
	SCALE: 1" = 600'		
LIBRARY	BY R.B.W.	LAST P. NO. 919	PHOTO 3DD-69-57
		QUADRANGLE	E.D.-6

R. B. Gray Sr.



Attachment 3
 Ho- 532
 The John Holland House
 Martennet Map of 1860

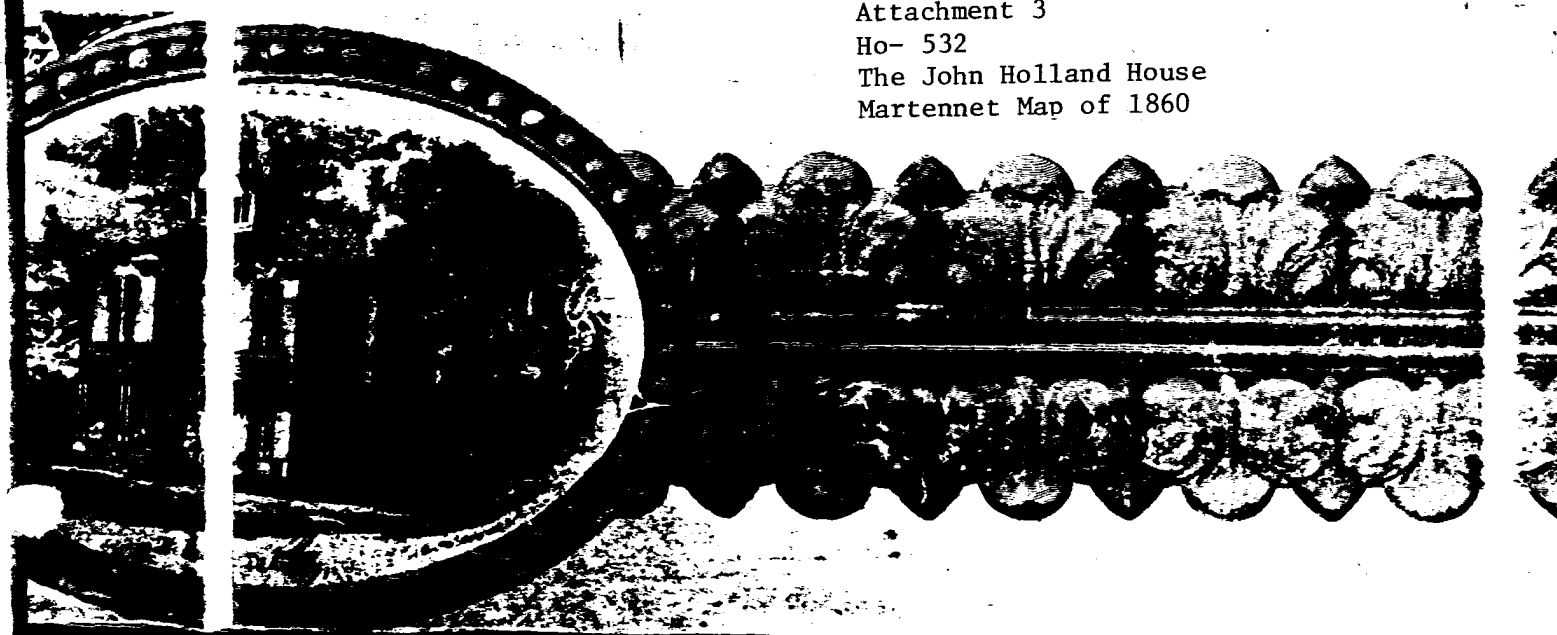

PRINCE

GEORGE

COUNTY

Sixth District.
GENERAL MERCHANT.
A. J. GALL,
 Dealer in Groceries, Provisions, Liquors,
 &c.
 Hooversville.

EXPLANATIONS
 Dist. & Co. Lines ---
 County Roads ---
 Private " ---
 Turnpike " ---
 Rail Roads ---
 Streams ---
 The figures along the Roads
 shows the distance in Rods,
 from junction to junction thereof

Attachment 4
 HO-532
 The John Holland House
 Hopkin's Atlas of 1878

GUILFORD DISTRICT

HOWARD COUNTY

Scale 2 1/4 Inches per Mile



Entered, according to Act of Congress in the year 1878 by G.M. Hopkins in the Office of the Librarian of Congress at Washington.



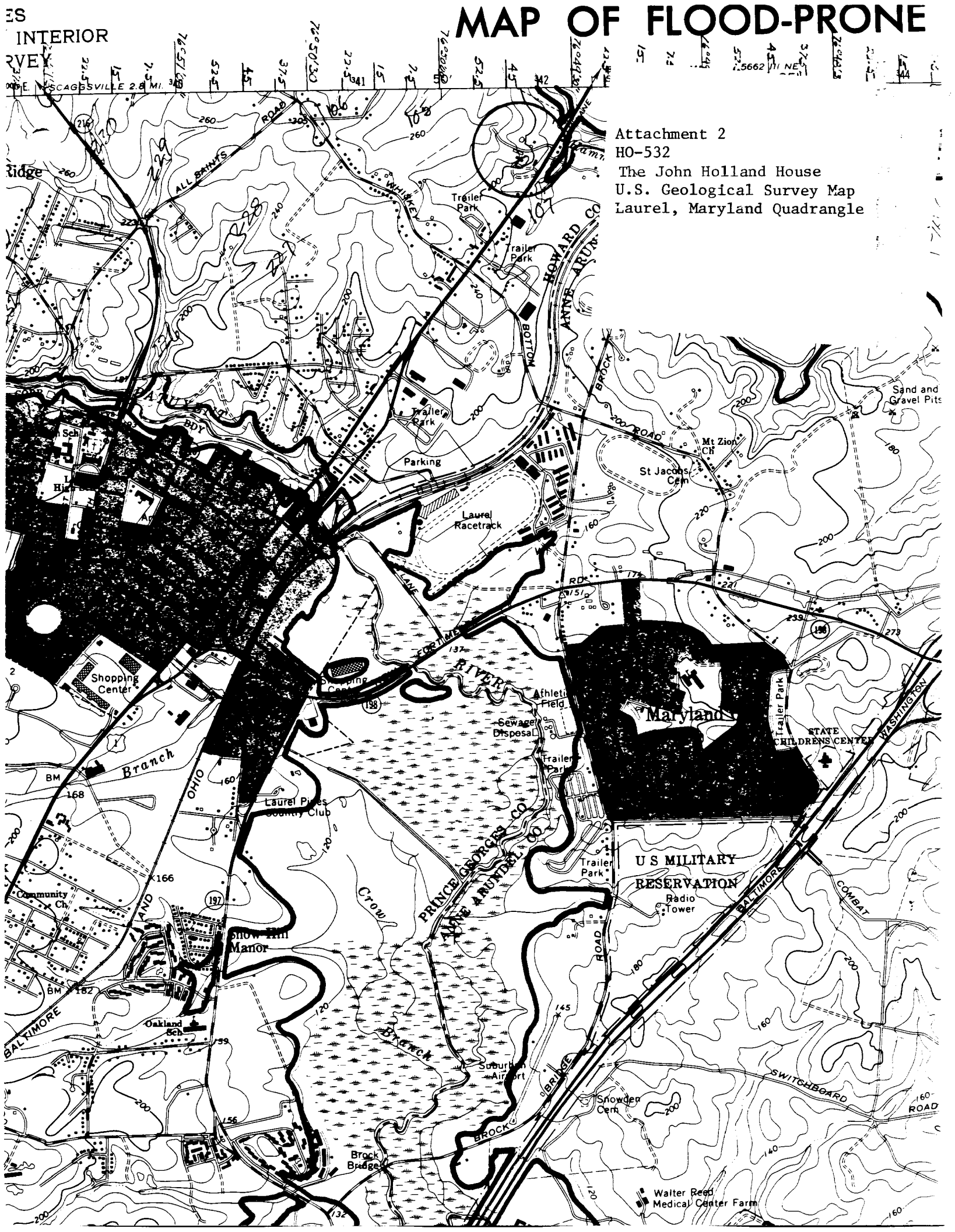

U.S. GEOLOGICAL SURVEY
INTERIOR
DEPARTMENT OF THE INTERIOR
GEOLOGICAL SURVEY

MAP OF FLOOD-PRONE

Attachment 2
HO-532
The John Holland House
U.S. Geological Survey Map
Laurel, Maryland Quadrangle

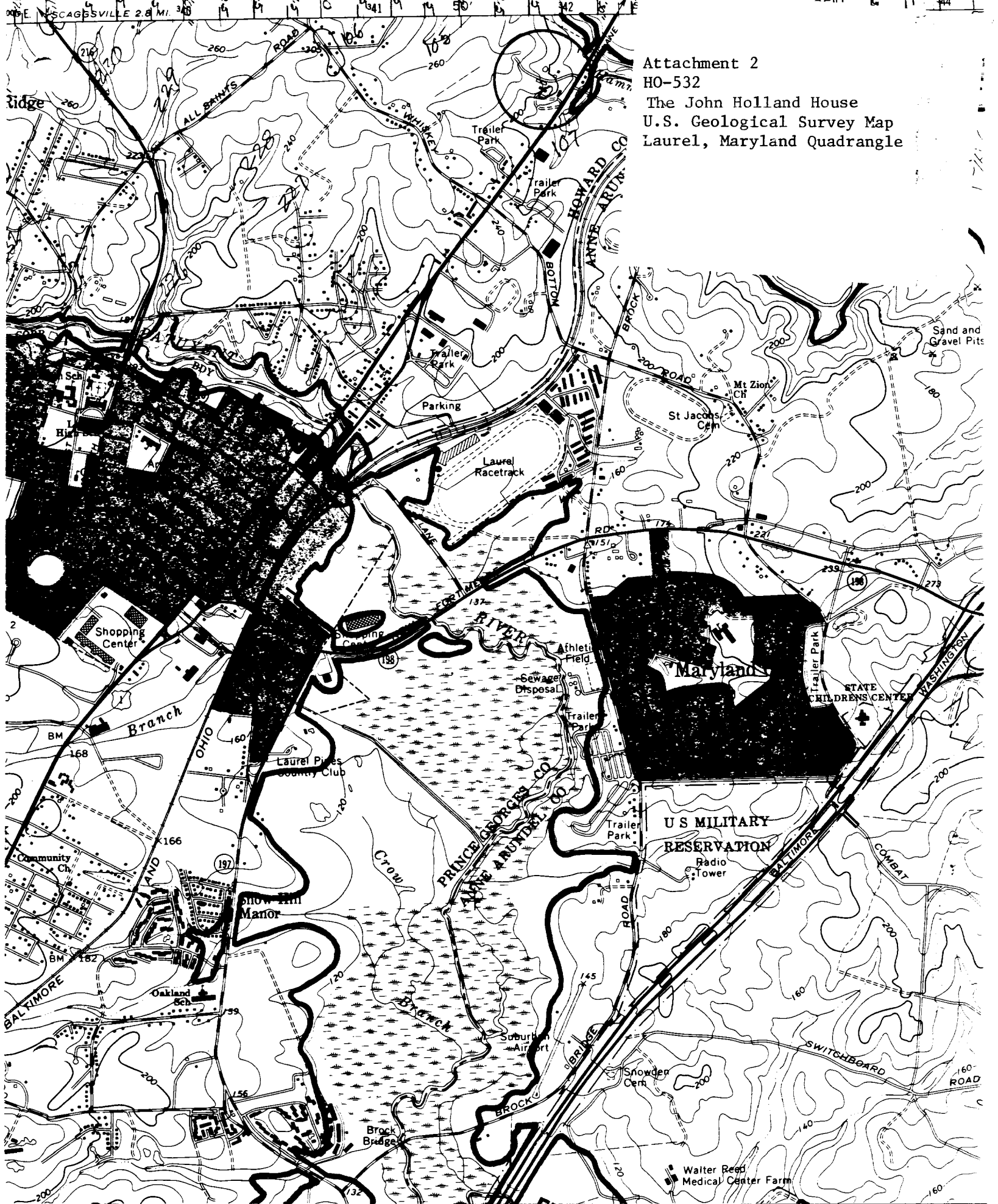

Walter Reed
Medical Center Farm



Ho. 532
The John Holland House
WEST

May, 1979
CB Thompson, ALCP