

HO-523

Inglehart House

Architectural Survey File

This is the architectural survey file for this MIHP record. The survey file is organized reverse-chronological (that is, with the latest material on top). It contains all MIHP inventory forms, National Register nomination forms, determinations of eligibility (DOE) forms, and accompanying documentation such as photographs and maps.

Users should be aware that additional undigitized material about this property may be found in on-site architectural reports, copies of HABS/HAER or other documentation, drawings, and the “vertical files” at the MHT Library in Crownsville. The vertical files may include newspaper clippings, field notes, draft versions of forms and architectural reports, photographs, maps, and drawings. Researchers who need a thorough understanding of this property should plan to visit the MHT Library as part of their research project; look at the MHT web site (mht.maryland.gov) for details about how to make an appointment.

All material is property of the Maryland Historical Trust.

Last Updated: 05-03-2004

HO-523
The IglehartHouse
Columbia
Private

Circa 1846

The Iglehart House faces west on the northwest corner of Owen Brown Road and Broken Land Parkway. It is a three bay wide, two bay deep, two and a half story high, gabled roof (running north-south) stone (covered with stucco) building, resting on a stone foundation, with two wide brick chimneys inset into either side of its south wall, and a two bay wide, one room deep, one story high, gabled roof (running east-west) stone (covered with stucco) east kitchen wing, with square brick chimney inset into its east wall.

MARYLAND HISTORICAL TRUST

HO-523
Dist. 6

MAEI # 1409235704

INVENTORY FORM FOR STATE HISTORIC SITES SURVEY

1 NAME

HISTORIC The Iglehart House

AND/OR COMMON

2 LOCATION

STREET & NUMBER N.W. Corner of Broken Land Parkway & Owen Brown Road

CITY, TOWN Simpsonville VICINITY OF 6th CONGRESSIONAL DISTRICT

STATE Maryland COUNTY Howard

3 CLASSIFICATION

CATEGORY	OWNERSHIP	STATUS	PRESENT USE
<input type="checkbox"/> DISTRICT	<input type="checkbox"/> PUBLIC	<input checked="" type="checkbox"/> OCCUPIED	<input type="checkbox"/> AGRICULTURE <input type="checkbox"/> MUSEUM
<input checked="" type="checkbox"/> BUILDING(S)	<input checked="" type="checkbox"/> PRIVATE	<input type="checkbox"/> UNOCCUPIED	<input type="checkbox"/> COMMERCIAL <input type="checkbox"/> PARK
<input type="checkbox"/> STRUCTURE	<input type="checkbox"/> BOTH	<input type="checkbox"/> WORK IN PROGRESS	<input type="checkbox"/> EDUCATIONAL <input checked="" type="checkbox"/> PRIVATE RESIDENCE
<input type="checkbox"/> SITE	PUBLIC ACQUISITION	ACCESSIBLE	<input type="checkbox"/> ENTERTAINMENT <input type="checkbox"/> RELIGIOUS
<input type="checkbox"/> OBJECT	<input type="checkbox"/> IN PROCESS	<input checked="" type="checkbox"/> YES: RESTRICTED	<input type="checkbox"/> GOVERNMENT <input type="checkbox"/> SCIENTIFIC
	<input type="checkbox"/> BEING CONSIDERED	<input type="checkbox"/> YES: UNRESTRICTED	<input type="checkbox"/> INDUSTRIAL <input type="checkbox"/> TRANSPORTATION
		<input type="checkbox"/> NO	<input type="checkbox"/> MILITARY <input type="checkbox"/> OTHER

4 OWNER OF PROPERTY

NAME Howard Research and Development

Telephone #:

STREET & NUMBER P. O. Box 833

CITY, TOWN Columbia VICINITY OF STATE, zip code Maryland 21044

5 LOCATION OF LEGAL DESCRIPTION

COURTHOUSE, REGISTRY OF DEEDS, ETC. Tax Map 36, p/o 431 Hall of Records

Liber #: 463
Folio #: 196

STREET & NUMBER Howard County Court House

CITY, TOWN Ellicott City STATE Maryland

6 REPRESENTATION IN EXISTING SURVEYS

TITLE Howard County Historic Sites Inventory

DATE 1978-1979 FEDERAL STATE COUNTY LOCAL

DEPOSITORY FOR SURVEY RECORDS Maryland Historical Trust

CITY, TOWN 21 State Circle, Annapolis STATE Maryland

7 DESCRIPTIONHO-523
Dist. 6

CONDITION		CHECK ONE	CHECK ONE
<input type="checkbox"/> EXCELLENT	<input type="checkbox"/> DETERIORATED	<input checked="" type="checkbox"/> UNALTERED	<input checked="" type="checkbox"/> ORIGINAL SITE
<input checked="" type="checkbox"/> GOOD	<input type="checkbox"/> RUINS	<input type="checkbox"/> ALTERED	<input type="checkbox"/> MOVED DATE _____
<input type="checkbox"/> FAIR	<input type="checkbox"/> UNEXPOSED		

DESCRIBE THE PRESENT AND ORIGINAL (IF KNOWN) PHYSICAL APPEARANCE

The Iglehart House faces west on the northwest corner of Owen Brown Road and Broken Land Parkway. It is a three bay wide, two bay deep, two and a half story high, gabled roof (running north-south) stone (covered with stucco) building, resting on a stone foundation, with two wide brick chimneys inset into either side of its south wall, and a two bay wide, one room deep, one story high, gabled roof (running east-west) stone (covered with stucco) east kitchen wing, with square brick chimney inset into its east wall.

Three wide steps lead to the rectangular, nine light kitchen entrance on the building's south wall. It features an ashlar cut stone landing step which has been worn from usage.

Fenestration for the entire building is proportionally scaled and vertically aligned. Windows are double-hung, holding six-over-six lights, underlined by projecting stone sills and decorated by green wooden shutters. Two tall, rectangular attic windows, holding four-over-two lights are placed in the north and south walls, while the east elevations feature central, gabled roof, dormer windows with rectangular, double-hung, six-over-six light windows.

A flagstone terrace, some two to three feet high, is placed on this front facade of the building with three wide steps on its south side.

The wooden open bible and cross paneled entrance door is located in the north bay of the west wall, surmounted by a three light transom, and flanked by iron lanterns inset into its front wall. The entrance is deeply inset, featuring fine paneling and revealing a two foot wide depth in the building's stone wall.

An additional cellar entrance is located in the center of the south wall which features two first and second floor windows on its east side.

CONTINUE ON SEPARATE SHEET IF NECESSARY

8 SIGNIFICANCE

HO-523

Dist 6

PERIOD	AREAS OF SIGNIFICANCE -- CHECK AND JUSTIFY BELOW			
<input type="checkbox"/> PREHISTORIC	<input type="checkbox"/> ARCHEOLOGY-PREHISTORIC	<input type="checkbox"/> COMMUNITY PLANNING	<input type="checkbox"/> LANDSCAPE ARCHITECTURE	<input type="checkbox"/> RELIGION
<input type="checkbox"/> 1400-1499	<input type="checkbox"/> ARCHEOLOGY-HISTORIC	<input type="checkbox"/> CONSERVATION	<input type="checkbox"/> LAW	<input type="checkbox"/> SCIENCE
<input type="checkbox"/> 1500-1599	<input type="checkbox"/> AGRICULTURE	<input type="checkbox"/> ECONOMICS	<input type="checkbox"/> LITERATURE	<input type="checkbox"/> SCULPTURE
<input type="checkbox"/> 1600-1699	<input checked="" type="checkbox"/> ARCHITECTURE	<input type="checkbox"/> EDUCATION	<input type="checkbox"/> MILITARY	<input type="checkbox"/> SOCIAL/HUMANITARIAN
<input type="checkbox"/> 1700-1799	<input type="checkbox"/> ART	<input type="checkbox"/> ENGINEERING	<input type="checkbox"/> MUSIC	<input type="checkbox"/> THEATER
<input checked="" type="checkbox"/> 1800-1899	<input type="checkbox"/> COMMERCE	<input type="checkbox"/> EXPLORATION/SETTLEMENT	<input type="checkbox"/> PHILOSOPHY	<input type="checkbox"/> TRANSPORTATION
<input type="checkbox"/> 1900-	<input type="checkbox"/> COMMUNICATIONS	<input type="checkbox"/> INDUSTRY	<input type="checkbox"/> POLITICS/GOVERNMENT	<input checked="" type="checkbox"/> OTHER (SPECIFY) Local history
		<input type="checkbox"/> INVENTION		

SPECIFIC DATES circa 1846

BUILDER/ARCHITECT

STATEMENT OF SIGNIFICANCE

The Iglehart House is significant to Howard County, the State of Maryland, and the nation in two areas.

First and foremost, it is a formidable architectural landmark, which may well date from the early nineteenth century. Its floor plan of end bay hall and staircase with two rooms to its side is similar to that found in Hickory Ridge, HO-20 in Highland and HO-301, Tuten's College in Ellicott City.

Located on a high ridge line, it has a commanding view of its surrounding area and from this vantage point, its massive stone architecture, blending fine lines and proportion, can be appreciated. The kitchen wing, possibly antedating the two and half story high, front section of the building, blends successfully with it, completing and adding interest and variety to the north and south elevations of the building.

The interior hall is one of the main features of the building, with a staircase, which rises from the first floor to the attic and holds rectangular spindles, usually associated with eighteenth or early nineteenth century buildings. Two wide brick chimneys, located in its south wall, provide two fireplaces on the first and second floors as well as the attic. Wide random width floors, as well as simply crafted door and window frames, featuring flat pilasters and lintels, joined by square corners also bespeak an early construction date.

Historically, the building now belongs to Howard Research and Development, which is presently selling the property and has already sold a section south of the house to Exxon Corporation for development purposes. In the early twentieth century the farm was occupied by Mr. and Mrs. Peter Johnson; whose daughter Elizabeth married C. Ferdinand Sybert, prominent attorney of Howard County.

In regard to the historical significance of the house, more thorough research needs to be undertaken for this outstanding architectural landmark.

It is possible that it stands on what was once the 119-acre tract of land willed to Susannah Harding by her father, Edward T. Iglehart, on January 27, 1846. This house was not his residence but a tract of land called "Joseph's Gift". Should this be true, the house is probably the same one noted on both the Hopkin's Atlas of 1878 and the 1860 Martennet map as the property of William Harding. See attachments 3 and 4. The architectural detail and stylistic elements of the house would substantiate a construction date of circa 1846.

CONTINUE ON SEPARATE SHEET IF NECESSARY

Of outstanding architectural merit, with a substantial history, the Iglehart House should, if its owners so desire, be placed on the National Register of Historic Places, the State Critical Areas program and any local landmark ordinance which the citizens of Howard County might seek to initiate.

9 MAJOR BIBLIOGRAPHICAL REFERENCESHO-523
Dist 6

1. Interview with Mrs. Lewis Brown, March 22, 1979.
2. Interview with Mrs. Elizabeth Johnson Sybert, daughter of Mr. and Mrs. Peter Johnson, former owners, March 22, 1979.
3. Land Records of Howard County.

CONTINUE ON SEPARATE SHEET IF NECESSARY**10 GEOGRAPHICAL DATA**ACREAGE OF NOMINATED PROPERTY 1.39 acres (Parcel B of 431)

Please see Attachment 1, Tax Map 36

VERBAL BOUNDARY DESCRIPTIONPlease see Howard County Land Records, Liber 463 Folio 196**LIST ALL STATES AND COUNTIES FOR PROPERTIES OVERLAPPING STATE OR COUNTY BOUNDARIES**STATE Maryland COUNTY Howard

STATE _____ COUNTY _____

11 FORM PREPARED BY

NAME / TITLE

Cleora Barnes Thompson, Archivist

ORGANIZATION

Office of Planning & Zoning-Comprehensive Planning Section

DATE

STREET & NUMBER

3450 Court House Drive

TELEPHONE

CITY OR TOWN

Ellicott City

STATE

Maryland

The Maryland Historic Sites Inventory was officially created by an Act of the Maryland Legislature, to be found in the Annotated Code of Maryland, Article 41, Section 181 KA, 1974 Supplement.

The Survey and Inventory are being prepared for information and record purposes only and do not constitute any infringement of individual property rights.

RETURN TO: Maryland Historical Trust
The Shaw House, 21 State Circle
Annapolis, Maryland 21401
(301) 267-1438

Attachment 1
HO-523
The Iglehart House
Tax Map 36

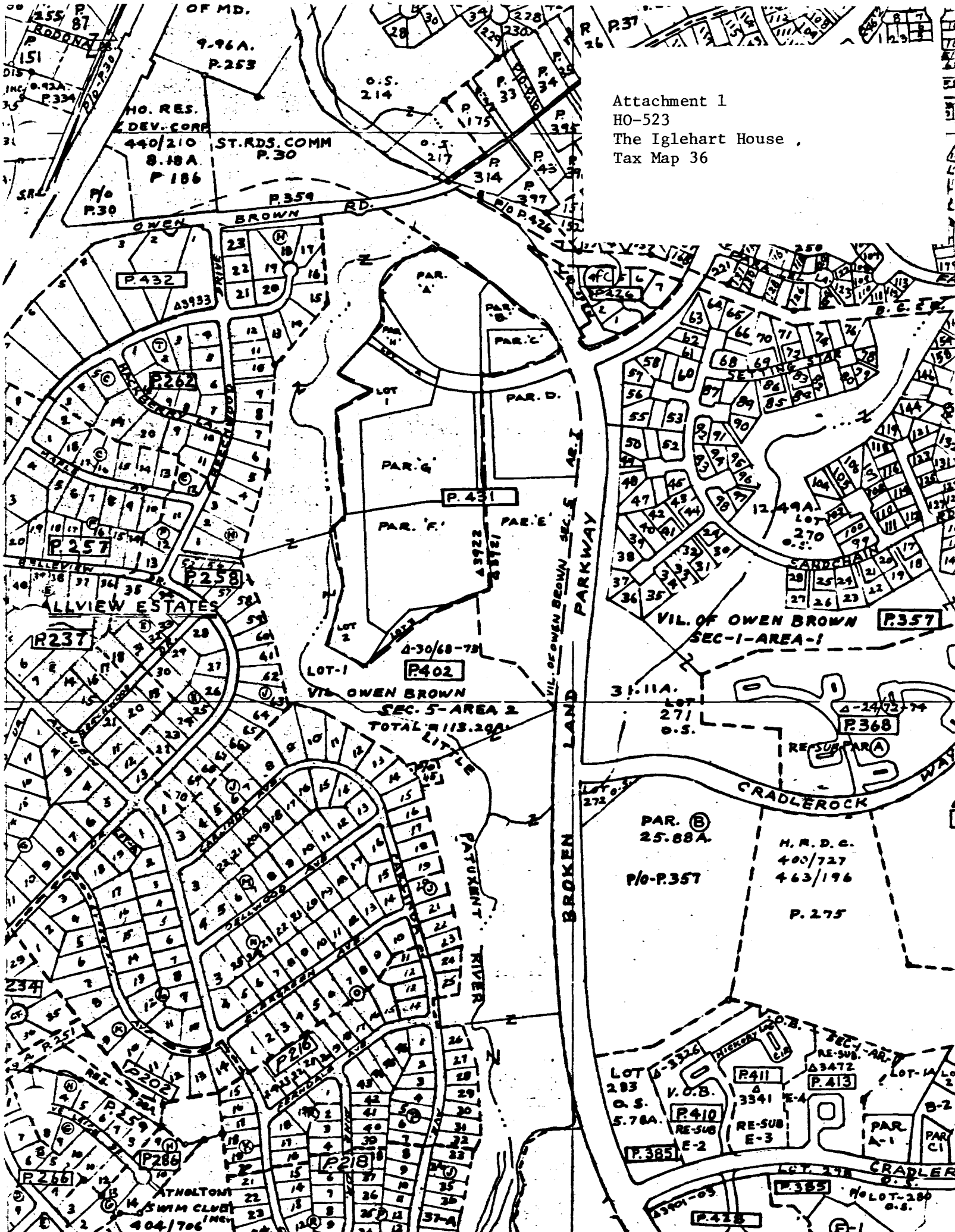

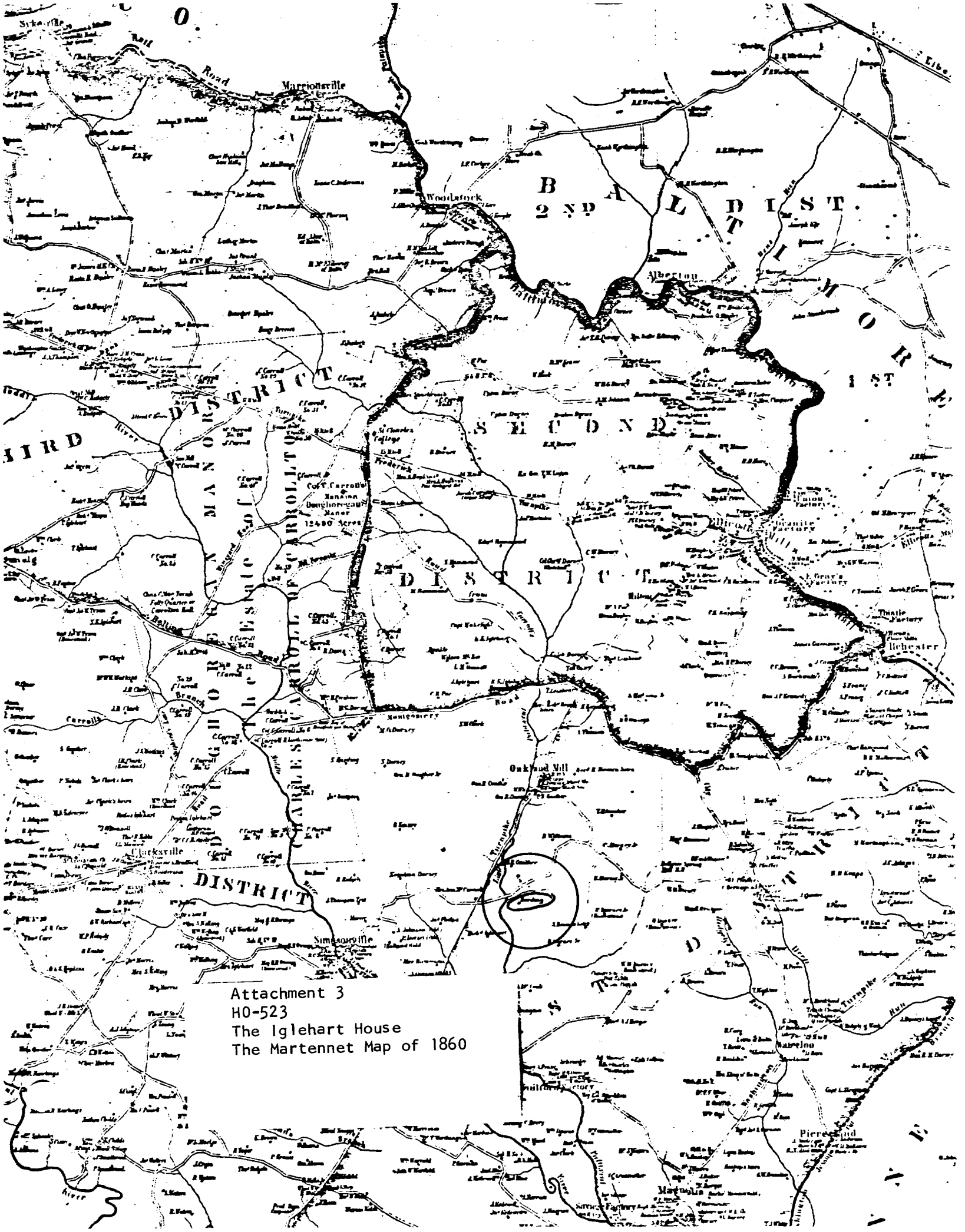

Attachment 3
H0-523
The Iglehart House
The Martennet Map of 1860

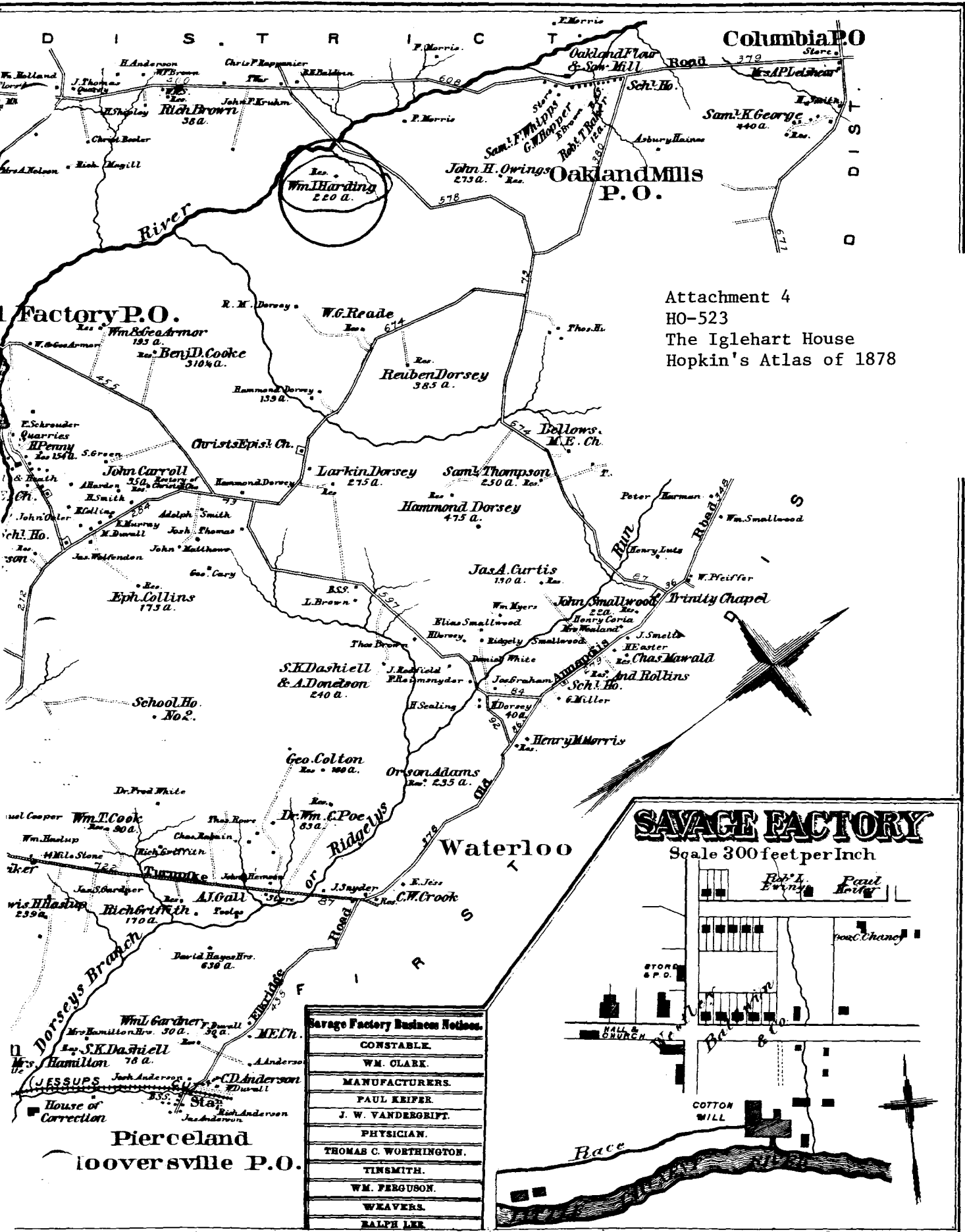

Attachment 4
 HO-523
 The Iglehart House
 Hopkin's Atlas of 1878

SAVAGE FACTORY

Scale 300 feet per Inch

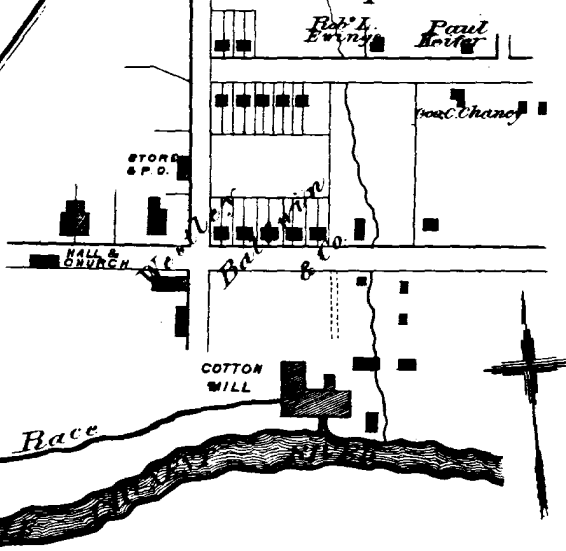

Savage Factory Business Notions.	
CONSTABLE.	WM. CLARK.
MANUFACTURERS.	PAUL KEIFER.
PHYSICIAN.	J. W. VANDERGRIFT.
TINSMITH.	THOMAS C. WORTHINGTON.
WEAVERS.	WM. FERGUSON.
	RALPH LEE.

Attachment 2
HO-523
The Iglehart House
U. S. Geological Survey Map
Savage, Maryland Quadrangle

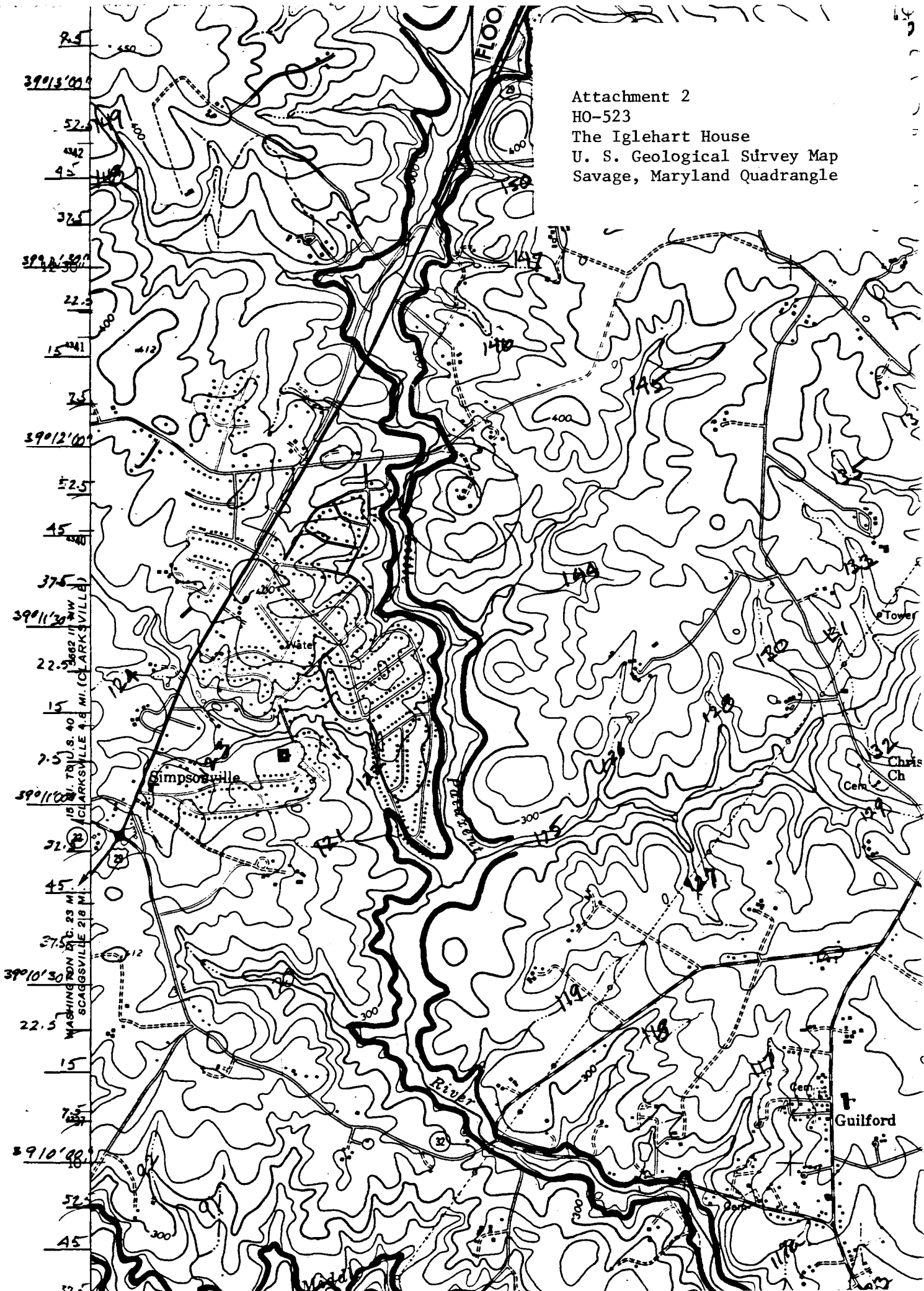



HO-523
THE IGHART HOUSE
SOUTHWEST

CB THOMPSON, AICP
MAR 79