

HO-477

Thompson Farm Outbuildings

Architectural Survey File

This is the architectural survey file for this MIHP record. The survey file is organized reverse-chronological (that is, with the latest material on top). It contains all MIHP inventory forms, National Register nomination forms, determinations of eligibility (DOE) forms, and accompanying documentation such as photographs and maps.

Users should be aware that additional undigitized material about this property may be found in on-site architectural reports, copies of HABS/HAER or other documentation, drawings, and the “vertical files” at the MHT Library in Crownsville. The vertical files may include newspaper clippings, field notes, draft versions of forms and architectural reports, photographs, maps, and drawings. Researchers who need a thorough understanding of this property should plan to visit the MHT Library as part of their research project; look at the MHT web site (mht.maryland.gov) for details about how to make an appointment.

All material is property of the Maryland Historical Trust.

Last Updated: 05-03-2004

HO-477
THE THOMPSON FARM OUTBUILDINGS
Ellicott City
Public

Nineteenth Century

These outbuildings face south on the north west corner of Manor Lane and Route 108. They consist of a one and a half story high, gabled roof (running east-west), two bay wide, one room deep, stone spring house facing south on whose north and east elevations extend two additional structures.

A batten wood second floor door is centered into its west wall while the two story high, gabled roof (running north-south) frame building, once reputed to be a slave quarters, extends from the north wall of the spring house and a twentieth century, one and one half story high, gabled roof (running east-west), two car garage stone addition, lies on its east wall.

INVENTORY FORM FOR STATE HISTORIC SITES SURVEY

1 NAME

HISTORIC

AND/OR COMMON

The Thompson Farm Outbuildings

2 LOCATION

STREET & NUMBER

10820 Route 108, Clarksville Pike

CITY, TOWN

Ellicott City

___ VICINITY OF

CONGRESSIONAL DISTRICT

6th

STATE

Maryland

COUNTY

Howard

3 CLASSIFICATION

CATEGORY	OWNERSHIP	STATUS	PRESENT USE	
<input checked="" type="checkbox"/> DISTRICT	<input checked="" type="checkbox"/> PUBLIC	<input checked="" type="checkbox"/> OCCUPIED	<input checked="" type="checkbox"/> AGRICULTURE	___ MUSEUM
___ BUILDING(S)	___ PRIVATE	___ UNOCCUPIED	___ COMMERCIAL	___ PARK
___ STRUCTURE	___ BOTH	___ WORK IN PROGRESS	___ EDUCATIONAL	<input checked="" type="checkbox"/> PRIVATE RESIDENCE
___ SITE	PUBLIC ACQUISITION	<input checked="" type="checkbox"/> ACCESSIBLE	___ ENTERTAINMENT	___ RELIGIOUS
___ OBJECT	___ IN PROCESS	___ YES: RESTRICTED	___ GOVERNMENT	___ SCIENTIFIC
	___ BEING CONSIDERED	___ YES: UNRESTRICTED	___ INDUSTRIAL	___ TRANSPORTATION
		___ NO	___ MILITARY	___ OTHER

4 OWNER OF PROPERTY

NAME

Board of Education of Howard County

Telephone #: 531-5744

STREET & NUMBER

Route 32

CITY, TOWN

Clarksville

___ VICINITY OF

STATE, zip code

MD

5 LOCATION OF LEGAL DESCRIPTION

COURTHOUSE. Tax Map 29, p. 100
REGISTRY OF DEEDS, ETC. Hall of Records

Liber #: 750

Folio #: 528

STREET & NUMBER

Howard County Court House

CITY, TOWN

Ellicott City

STATE

Maryland

6 REPRESENTATION IN EXISTING SURVEYS

TITLE

Howard County Historic Sites Inventory

DATE

1978

___ FEDERAL STATE ___ COUNTY ___ LOCAL

DEPOSITORY FOR SURVEY RECORDS

Maryland Historical Trust

CITY, TOWN

21 State Circle, Annapolis

STATE

Maryland

7 DESCRIPTION

	CONDITION		CHECK ONE		CHECK ONE	
X	<input type="checkbox"/> EXCELLENT	<input type="checkbox"/> DETERIORATED	<input checked="" type="checkbox"/> UNALTERED	<input checked="" type="checkbox"/> ORIGINAL SITE	<input type="checkbox"/> MOVED	DATE _____
	<input type="checkbox"/> GOOD	<input type="checkbox"/> RUINS	<input type="checkbox"/> ALTERED			
	<input type="checkbox"/> FAIR	<input type="checkbox"/> UNEXPOSED				

DESCRIBE THE PRESENT AND ORIGINAL (IF KNOWN) PHYSICAL APPEARANCE

THE THOMPSON FARM

The Outbuildings face south on the north west corner of Manor Lane and Route 108, just east of the main twentieth century stone house.

They consist of a barn which has been converted to a residence, and a one and a half story high, gabled roof (running east-west), two bay wide, one room deep, stone spring house facing south. It holds an interior water trough and features flat stone lintels and sills as well as fine quoining.

A rectangular open bible and cross paneled door is located in the west bay of the south wall and east of it a three light, rectangular window. Another three light window is located in the north and in the east wall.

Along the north wall of this stone spring house extends a two story high, gabled roof (running north-south) frame building, once believed to be used as slave quarters for the main house, with east and west rectangular entrances. A six light window is located on the second floor of the east and west wall and an enclosed staircase with batten wood door entrance in the north west corner of the building, ascending along the north wall, which holds a second floor six light window. The interior features wide, random width boards and log supporting beams holding the second floor.

Along the east wall of the old stone dairy, a one and a half story high gabled roof (running east-west) stone, two car garage has been constructed with wide garage doors facing south. This is a twentieth century addition which has been constructed to blend with the original stone dairy. It's east elevation is exceptional in this respect, featuring rectangular, double-hung windows, holding six-over-six lights with a central four light attic window. This building also features cement sills and fine flat lintels.

CONTINUE ON SEPARATE SHEET IF NECESSARY

8 SIGNIFICANCE

PERIOD		AREAS OF SIGNIFICANCE -- CHECK AND JUSTIFY BELOW				
<input type="checkbox"/> PREHISTORIC	<input type="checkbox"/> ARCHEOLOGY-PREHISTORIC	<input type="checkbox"/> COMMUNITY PLANNING	<input type="checkbox"/> LANDSCAPE ARCHITECTURE	<input type="checkbox"/> RELIGION		
<input type="checkbox"/> 1400-1499	<input type="checkbox"/> ARCHEOLOGY-HISTORIC	<input type="checkbox"/> CONSERVATION	<input type="checkbox"/> LAW	<input type="checkbox"/> SCIENCE		
<input type="checkbox"/> 1500-1599	<input type="checkbox"/> AGRICULTURE	<input type="checkbox"/> ECONOMICS	<input type="checkbox"/> LITERATURE	<input type="checkbox"/> SCULPTURE		
<input type="checkbox"/> 1600-1699	<input checked="" type="checkbox"/> ARCHITECTURE	<input type="checkbox"/> EDUCATION	<input type="checkbox"/> MILITARY	<input type="checkbox"/> SOCIAL/HUMANITARIAN		
<input type="checkbox"/> 1700-1799	<input type="checkbox"/> ART	<input type="checkbox"/> ENGINEERING	<input type="checkbox"/> MUSIC	<input type="checkbox"/> THEATER		
<input checked="" type="checkbox"/> 1800-1899	<input type="checkbox"/> COMMERCE	<input type="checkbox"/> EXPLORATION/SETTLEMENT	<input type="checkbox"/> PHILOSOPHY	<input type="checkbox"/> TRANSPORTATION		
<input type="checkbox"/> 1900-	<input type="checkbox"/> COMMUNICATIONS	<input type="checkbox"/> INDUSTRY	<input type="checkbox"/> POLITICS/GOVERNMENT	<input checked="" type="checkbox"/> OTHER (SPECIFY) Local History		
		<input type="checkbox"/> INVENTION				

SPECIFIC DATES Nineteenth Century BUILDER/ARCHITECT

STATEMENT OF SIGNIFICANCE

The Thompson Farm Outbuildings are notable historically and architecturally to Howard County and the state of Maryland.

Historically they adjoin Doughoregan Manor, located on the northwest corner of Route 108 and Manor Lane, which leads to the old estate of Charles Carroll of Carrollton.

Architecturally the dairy is representative of the fine stone buildings which are found throughout Howard County and which feature fine stone quoining, projecting stone sills and flat stone lintels as well as fine scale and proportions. An interesting water trough is also featured here.

The buildings constructed off this gabled roof spring house are also noteworthy. They consist of a nineteenth century two story high, frame building, believed to have been used as a slave quarters, and a twentieth century stone, two car garage, which has been constructed to blend with the early nineteenth century stone dairy. The latter features an east wall holding two rectangular, double-hung windows with six-over six lights and a four light attic window, so typical of early stone buildings.

These century old outbuildings are located on the Hopkins Atlas of 1878 as part of the farm of Michael Dorsey. At one time many of these stone buildings were located on adjoining Doughoregan Manor and other farms and estates. As time went by and the property was taxed on the basis of these buildings, those which were unnecessary to the operation of those estates or farms were dismantled. Some few dozen or so remain where hundreds once stood. The importance of identifying and preserving those which remain becomes more and more important as planned high density development becomes more and more threatening. Only one example of this threat is the present plan to raze the stone house and main house at Gray Rock, located off Route 144, for a modern subdivision.

The Thompson Farm is presently owned by the Board of Education of Howard County. These outbuildings may be in future jeopardy and should be placed on the National Register of Historic Places to help insure their continued presentation.

9 MAJOR BIBLIOGRAPHICAL REFERENCES

Interview with Mrs. Thompson, former owner, June , 1978

CONTINUE ON SEPARATE SHEET IF NECESSARY

10 GEOGRAPHICAL DATA

ACREAGE OF NOMINATED PROPERTY 19.33 acres

Please see Attachment 1, Tax Map 29

VERBAL BOUNDARY DESCRIPTION

Please see Howard County Land Records liber, 750, folio, 528

LIST ALL STATES AND COUNTIES FOR PROPERTIES OVERLAPPING STATE OR COUNTY BOUNDARIES

STATE Maryland COUNTY Howard

STATE COUNTY

11 FORM PREPARED BY

NAME / TITLE

Cleora Barnes Thompson, Archivist

ORGANIZATION

Office of Planning & Zoning-Comprehensive Planning Section 465-5000 x257

DATE

STREET & NUMBER

3450 Court House Drive

TELEPHONE

CITY OR TOWN

Ellicott City

STATE

Maryland

The Maryland Historic Sites Inventory was officially created by an Act of the Maryland Legislature, to be found in the Annotated Code of Maryland, Article 41, Section 181 KA, 1974 Supplement.

The Survey and Inventory are being prepared for information and record purposes only and do not constitute any infringement of individual property rights.

RETURN TO: Maryland Historical Trust
The Shaw House, 21 State Circle
Annapolis, Maryland 21401
(301) 267-1438

11 CARROLL
444/35
118.32A.
P. 21

WILLIAM E. JOHNSON
143/9
112.61A.
P. 2

JAMES CLARK
278/515
336A.
P. 3

Attachment 1
HO-477
The Thompson Farm
Outbuildings
Tax Map 29

E.D. 3
E.D. 2

P. 4
P. 112
P. 22
P. 101
P. 102
P. 103
P. 104

P. 78
P. 6
P. 285
P. 5
P. 80
P. 79
P. 107
P. 7
HM. COLBURN
320/440

DUANE F. ALEXANDER
- 489/367
14.63A.
P. 8

LOT 5
27.86A.

KLINE & LINN PROPERTY
10
P. 327

LOT 4
26.81A.

6
7
8
9
43811

LOT 3
KLINE & LINN
PROPERTY
Δ-3405
20.16A. P. 322

WM. C. STEVENS
220/182
P. 11

P. 96
P. 292
P. 9
E.W. KIRKHAM
217/18
2.55A.
P. 121
P. 10
P. 130

P. 304
P. 297
P. 269
P. 13
P. 14
P. 12
P. 93

P. U.C. CURTIS
301 HORNEY
583/556
2.00A.

BD. OF ED.
OF HO. CO.
465/577
25.32A.
P. 99

BD. OF ED.
OF HO. CO.
750/528
19.33A.
P. 100

P. 16
P. 17

E.D. 2

E.D. 3

339/381
P. 115
P. 65
P. 25

P. 29
P. 30
P. 31
FREDERICK REITZ
280/401
21.37A.
P. 66

ALAN C. BORG
823/157
5.40A.
P. 83

J.W. GARDNER
460/774
460/774
P. 133
8.65A.
P. 134

GEO. J. PHILLIPS
481/27
30.00A.
P. 137

ROBT. W. DOUGLAS, ET AL
560/118

HOWARD

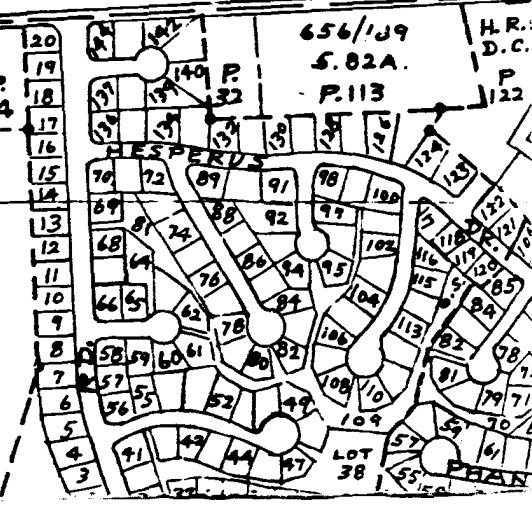



HO-477
THE THOMPSON FARM
OUTBUILDINGS
SOUTHWEST
JULY, 1978
CHEORA THOMPSON, A/P