

HO-186

## Clarkland Farm & Log Smokehouse (Charles R. Pue Farm/Hammond's Inheritance)

### **Architectural Survey File**

This is the architectural survey file for this MIHP record. The survey file is organized reverse-chronological (that is, with the latest material on top). It contains all MIHP inventory forms, National Register nomination forms, determinations of eligibility (DOE) forms, and accompanying documentation such as photographs and maps.

Users should be aware that additional undigitized material about this property may be found in on-site architectural reports, copies of HABS/HAER or other documentation, drawings, and the “vertical files” at the MHT Library in Crownsville. The vertical files may include newspaper clippings, field notes, draft versions of forms and architectural reports, photographs, maps, and drawings. Researchers who need a thorough understanding of this property should plan to visit the MHT Library as part of their research project; look at the MHT web site ([mht.maryland.gov](http://mht.maryland.gov)) for details about how to make an appointment.

All material is property of the Maryland Historical Trust.

***Last Updated: 02-07-2013***

MARYLAND HISTORICAL TRUST  
DETERMINATION OF ELIGIBILITY FORM

NR Eligible: yes   
no

Property Name: Clarkland Farm and Log Smoke House Inventory Number: HO-186

Address: 10380 MD 108 Clarksville Road *Pike* Historic district:  yes  no

City: Ellicott City Zip Code: 21042 County: Howard

USGS Quadrangle(s): Savage

Property Owner: James Clark, Jr. Tax Account ID Number: 200910

Tax Map Parcel Number(s): 18 Tax Map Number: 29

Project: MD 108: West of Centennial Lane to Woodland Road Agency: Maryland State Highway Administration

Agency Prepared By: Maryland State Highway Administration

Preparer's Name: Stephanie Foell Date Prepared: 01/04/2007

Documentation is presented in: Maryland Historical Trust Inventory Form for State Historic Sites Survey (HO-186)

Preparer's Eligibility Recommendation:  Eligibility recommended  Eligibility not recommended

Criteria:  A  B  C  D Considerations:  A  B  C  D  E  F  G

*Complete if the property is a contributing or non-contributing resource to a NR district/property:*

Name of the District/Property: \_\_\_\_\_

Inventory Number: \_\_\_\_\_ Eligible:  yes Listed:  yes

Site visit by MHT Staff  yes  no Name: \_\_\_\_\_ Date: \_\_\_\_\_

Description of Property and Justification: *(Please attach map and photo)*

Architectural Description

The property containing the Clarkland Farm and Log Smoke House was documented on a detailed Maryland Historical Trust Inventory Form for State Historic Sites Survey in 1978. The form presents both an architectural description and historic context statement. Although repeated requests to enter the property went unanswered, an on-site visual assessment from public right-of-way indicated that little has changed on the property since the completion of the previous form. Please refer to the form for the architectural descriptions of the farm house and log smoke house and historic context information. However, three barns from various eras were not described. All are located to the east of the farmhouse across the driveway. A frame gable-roof barn with a standing-seam metal roof and a shed-roof extension with open sides is present on the site. Original openings on the barn have been altered and filled in. Another frame barn with a low-pitched gable roof is located to the north of the previously mentioned barn. Finally, to the east of both of these barns is a small gable-roof animal barn.

Landscape features not described in the previous form include a woven-wire fence that encircles portions of the parcel. A split-rail fence encompasses other areas. The parcel contains mainly open fields, although there are deciduous and evergreen trees located

**MARYLAND HISTORICAL TRUST REVIEW**

Eligibility recommended  Eligibility not recommended

Criteria:  A  B  C  D Considerations:  A  B  C  D  E  F  G

MHT Comments:

Jim Paulsen ✓ 2/2/2007  
Reviewer, Office of Preservation Services Date

Bluntz 2/2/07  
Reviewer, National Register Program Date

primarily near the collection of buildings. A novelty well is located directly to the east of the house.

An associated parcel of land containing the related Clarkland Farm Stone Tenant House (HO-314) was determined to be not eligible for listing in the National Register of Historic Places in 2002 due to a loss of integrity.

Significance Evaluation

The property containing the Clarkland Farm and Log Smoke House is not eligible for listing in the National Register of Historic Places under Criterion A. It is not the site of any significant historic events in the past. It is an example of a late-nineteenth and early twentieth-century farm and is noteworthy for its large 157.41-acre agricultural parcel and was evaluated for its potential eligibility as an example of a farm that represented significant agricultural trends in Howard County. However, research did not indicate that any technologically innovative or significant farming methods were practiced there. Furthermore, the property does not retain integrity to convey its association with local agricultural history from a distinct period of significance.

The Clarkland Farm and Log Smoke House are not eligible under Criterion B. The property has been owned by former State Senator James Clark, Jr., since 1951 and occupied by him since 1957; therefore, Clark's association with the property occurs primarily within the past 50 years. At this time, Clark's contributions and his association with the property do not qualify as exceptionally significant under Criterion Consideration G; therefore, the property is not eligible under Criterion B.

The property is not eligible under Criterion C. Components of the property have been changed considerably, resulting in a loss of integrity. The farmhouse has been substantially altered. The orientation of the house has been changed, an attached log kitchen was removed, a large frame addition and a smaller shed-roof addition were constructed, siding covers a portion of the house, and the original entrance has been obliterated by the installation of a large brick exterior chimney that covers the original doorway. The combination of all of these changes result in a house form that is does not retain integrity and is not easily identifiable as historic. The outbuildings retain varying degrees of integrity. The smoke house has a replacement roof. Barns and sheds on the property as typical examples of twentieth-century frame agricultural buildings in Maryland, and some have been altered.

The property was not assessed for eligibility under Criterion D as part of this evaluation.

<b>MARYLAND HISTORICAL TRUST REVIEW</b>	
Eligibility recommended _____	Eligibility not recommended _____
Criteria: ___A ___B ___C ___D	Considerations: ___A ___B ___C ___D ___E ___F ___G
MHT Comments:	
_____ Reviewer, Office of Preservation Services	_____ Date
_____ Reviewer, National Register Program	_____ Date

HO-186  
Clarkland Farm Log Smoke House  
10380 MD 108/Clarksville Road  
Howard County, MD

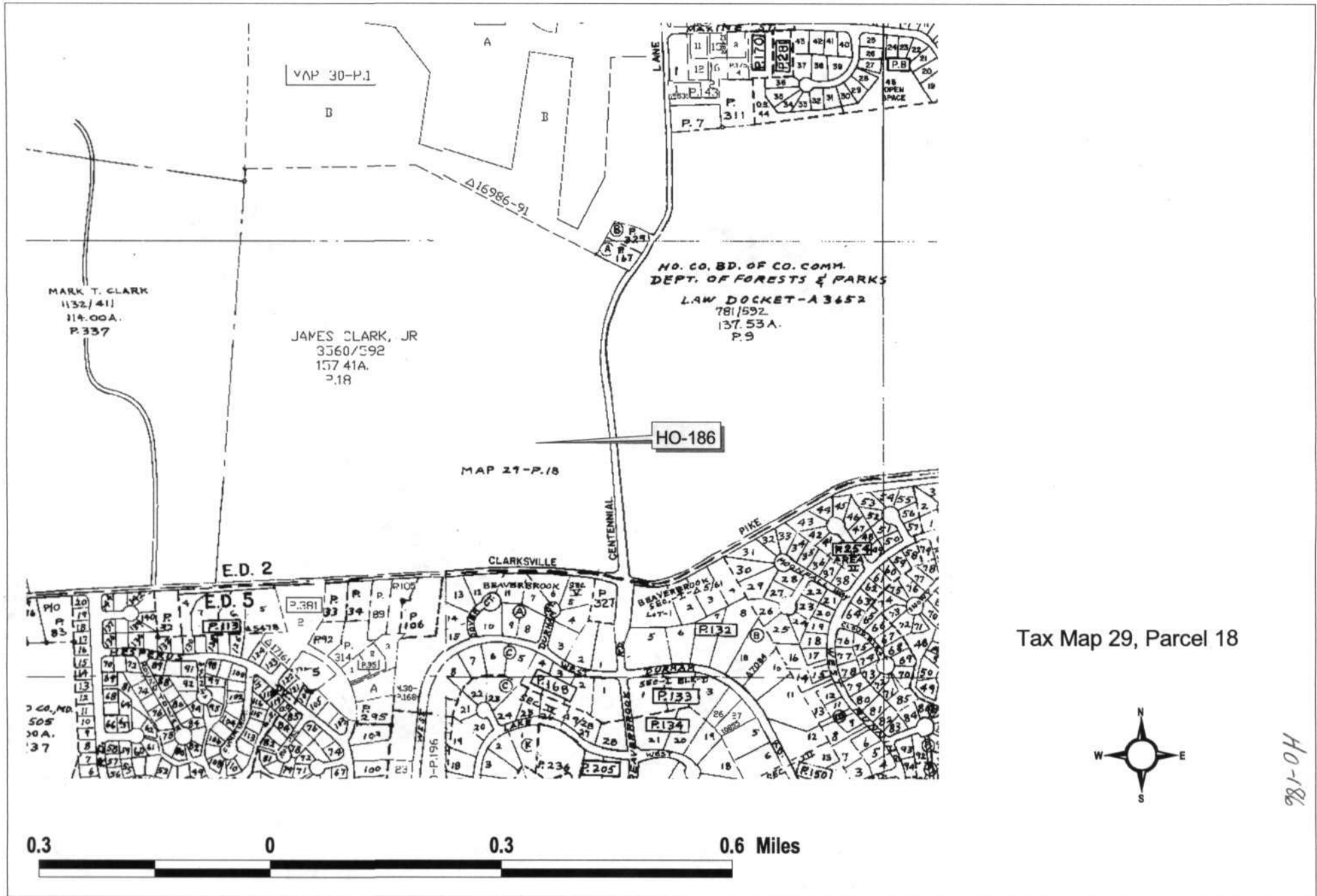

Tax Map 29, Parcel 18



HO-186

**HO-186**  
**Clarkland Farm and Log Smoke House**  
**10380 MD 108/Clarksville Road**  
**Howard County, MD**

UNITED STATES  
DEPARTMENT OF THE INTERIOR  
GEOLOGICAL SURVEY

5060 N. SW  
(SYKESVILLE)



USGS Savage Quadrangle Map  
1:24,000

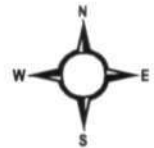

0.9 0 0.9 1.8 Miles

HO-186



HO-186

Clarkland Farm and Log Smoke House

Howard County, MD

S. Foell

3/2006

MD SHPO

Overview of buildings on the property; view  
to the west

1/4



H0-186

Clarkland Farm and Log Smoke House

Howard County, MD

S. Foell

3/2006

MD SHPO

View of farmhouse; view to the west

2/4



H0 - 156

Clarkland Farm and Log Smoke House  
Howard County, MD

J. Foell

3/2006

MD SHPO

Barns, fencing, landscape; view to the  
west

3/4



H0-186

Clarkland Farm and Log Smoke House

Howard County, MD

S. Fell

3/2006

MD SHPO

Barns, view to the west

4/4

Ho-186  
Clarkland Farm and Log Smoke House  
Ellicott City  
Private

eighteenth and  
nineteenth centuries

Clarkland Farm, present residence of State Senator and Mrs. James Clark, Jr., faces east on the north west corner of Centennial Lane and Route 108. It consists of a comfortable white stone and frame farm house, a log smoke house, barn, and auxiliary buildings.

The log smoke house faces south, a one story high log building with gabled roof (running north-south) and central rectangular south entrance door.

Existing for over 100 years as a working farm, it was owned in 1850 by Charles R. Pue who conveyed the deed to the farm to Charles R. Carroll, retaining the operation and management of it to himself and his heirs.

# MARYLAND HISTORICAL TRUST

## INVENTORY FORM FOR STATE HISTORIC SITES SURVEY

### 1 NAME

HISTORIC Charles R. Pue Farm/Hammond's Inheritance

AND/OR COMMON

Clarkland Farms and Log Smoke House

### 2 LOCATION

STREET & NUMBER

Clarkland Farm, Route 108

6th

CITY, TOWN

Ellicott City

— VICINITY OF

CONGRESSIONAL DISTRICT

Howard

STATE

Maryland

COUNTY

### 3 CLASSIFICATION

CATEGORY	OWNERSHIP	STATUS	PRESENT USE
<input checked="" type="checkbox"/> DISTRICT	<input type="checkbox"/> PUBLIC	<input checked="" type="checkbox"/> OCCUPIED	<input checked="" type="checkbox"/> AGRICULTURE
<input type="checkbox"/> BUILDING(S)	<input checked="" type="checkbox"/> PRIVATE	<input type="checkbox"/> UNOCCUPIED	<input type="checkbox"/> MUSEUM
<input type="checkbox"/> STRUCTURE	<input type="checkbox"/> BOTH	<input type="checkbox"/> WORK IN PROGRESS	<input type="checkbox"/> COMMERCIAL
<input type="checkbox"/> SITE	<input type="checkbox"/> PUBLIC ACQUISITION	<input type="checkbox"/> ACCESSIBLE	<input type="checkbox"/> EDUCATIONAL
<input type="checkbox"/> OBJECT	<input type="checkbox"/> IN PROCESS	<input checked="" type="checkbox"/> YES: RESTRICTED	<input checked="" type="checkbox"/> PRIVATE RESIDENCE
	<input type="checkbox"/> BEING CONSIDERED	<input type="checkbox"/> YES: UNRESTRICTED	<input type="checkbox"/> ENTERTAINMENT
		<input type="checkbox"/> NO	<input type="checkbox"/> GOVERNMENT
			<input type="checkbox"/> INDUSTRIAL
			<input type="checkbox"/> MILITARY
			<input type="checkbox"/> PARK
			<input type="checkbox"/> RELIGIOUS
			<input type="checkbox"/> SCIENTIFIC
			<input type="checkbox"/> TRANSPORTATION
			<input type="checkbox"/> OTHER

### 4 OWNER OF PROPERTY

NAME

Senator and Mrs. James Clark, Jr.

Telephone #: 730-8973

STREET & NUMBER

Clarkland Farms, Rt. 108

CITY, TOWN

Ellicott City

— VICINITY OF

STATE, zip code

Maryland 21043

### 5 LOCATION OF LEGAL DESCRIPTION

COURTHOUSE,  
REGISTRY OF DEEDS, ETC.

Tax Map 29 & 30, p. 18  
Hall of Records

Liber #: 299

Folio #: 001

STREET & NUMBER

Howard County Court House

CITY, TOWN

Ellicott City

STATE

Maryland

### 6 REPRESENTATION IN EXISTING SURVEYS

TITLE

Howard County Historic Sites Inventory

DATE

1978

— FEDERAL  STATE — COUNTY — LOCAL

DEPOSITORY FOR  
SURVEY RECORDS

Maryland Historical Trust

CITY, TOWN

21 State Circle, Annapolis

STATE

Maryland

**7 DESCRIPTION**Ho-186  
Dist 2

CONDITION		CHECK ONE	CHECK ONE
<input checked="" type="checkbox"/> EXCELLENT	<input type="checkbox"/> DETERIORATED	<input type="checkbox"/> UNALTERED	<input checked="" type="checkbox"/> ORIGINAL SITE
<input type="checkbox"/> GOOD	<input type="checkbox"/> RUINS	<input checked="" type="checkbox"/> ALTERED	<input type="checkbox"/> MOVED      DATE _____
<input type="checkbox"/> FAIR	<input type="checkbox"/> UNEXPOSED		

**DESCRIBE THE PRESENT AND ORIGINAL (IF KNOWN) PHYSICAL APPEARANCE**

The entrance road to Clarkland Farm, residence of Senator and Mrs. James Clark, Jr., is located several yards west of Centennial Lane on the north side of Route 108. It faces east and consists of a comfortable white stone and frame farm house, a barn, log smoke house, and outer buildings.

It sits back off the road on a gentle slope of ground overlooking some 160 acres of some of Howard County's most valuable and productive farm land. Part of a tract of land which was originally called "Hammond's Inheritance", the Clarkland Farm was once operated by J. Dallas Brown and his wife, Mollie, who on November 30, 1850, conveyed it to Charles R. Carroll. The log smoke house which sits east of the house existed at that time and may go back to the eighteenth century. It is a rectangular, one story high log building with gable roof (running north-south) and a single aperture, a central rectangular south entrance door.

The residence of Senator and Mrs. James Clark incorporates the large three bay wide, one room deep, two story high, gabled roof (running east-west) stone house which was once occupied by Charles R. Pue a hundred years ago. The gabled roof line was changed to run north-south by Mollie and Dallas Brown when remodeling the original stone house circa 1903. A log kitchen running from the north wall of the stone house was also removed at that time and the present two bay wide, one room deep, two and a half story high, gabled roof (running east-west) frame addition constructed along and extending eastward one bay from the north wall of the original stone house. This addition was constructed of lumber taken off the property. It holds a hall and staircase as well as large kitchen and dining room and is set on a stone foundation. At this time the present well was also dug, replacing a stream as a source for the water supply.

Extending along the entire north wall of this addition is a one story high, shed roofed addition which holds the Senator's library and office as well as a vestibule into this part of the house.

The stone house originally faced south with a central entrance door flanked by first and second floor rectangular, double-hung windows with log lintels. Senator and Mrs. Clark have added a wide central brick chimney (see photograph) on this wall, creating a fine interior focal point for the large open living room, with rectangular, double-hung east and west windows holding two-over-two lights and north door leading into the entrance hall of the addition. A wide stone foundation in the basement's east wall may have been the foundation for a wide stone chimney set into this east wall, originally holding a first floor fireplace, but later altered by Mr. and Mrs. Brown

**CONTINUE ON SEPARATE SHEET IF NECESSARY**

when they remodeled the house in the early twentieth century.

An open bible and cross paneled entrance door located on the south wall of the addition leads into the hall. Additional rectangular entrances are located in the central bay of the north wall of the vestibule to the Senator's office and in the central bay of the frame addition's west wall, leading into the kitchen. This early twentieth century addition rests on a stone foundation and features single attic, east and west, roman arched, double-hung windows with two-over-two lights. Scrolled brackets hold a cornice which is located between the second floor and attic. Fenestration is vertically aligned and proportionally scaled, decorated with flat wooden lintels and shutters.

A patio lies on the west of the house with barns and auxiliary buildings north. The Clarkland Farm also incorporates acreage west of this 160 acre tract. Please see Ho-314.

PERIOD	AREAS OF SIGNIFICANCE -- CHECK AND JUSTIFY BELOW			
<input type="checkbox"/> PREHISTORIC	<input type="checkbox"/> ARCHEOLOGY-PREHISTORIC	<input type="checkbox"/> COMMUNITY PLANNING	<input type="checkbox"/> LANDSCAPE ARCHITECTURE	<input type="checkbox"/> RELIGION
<input type="checkbox"/> 1400-1499	<input checked="" type="checkbox"/> ARCHEOLOGY-HISTORIC	<input type="checkbox"/> CONSERVATION	<input type="checkbox"/> LAW	<input type="checkbox"/> SCIENCE
<input type="checkbox"/> 1500-1599	<input type="checkbox"/> AGRICULTURE	<input type="checkbox"/> ECONOMICS	<input type="checkbox"/> LITERATURE	<input type="checkbox"/> SCULPTURE
<input type="checkbox"/> 1600-1699	<input checked="" type="checkbox"/> ARCHITECTURE	<input type="checkbox"/> EDUCATION	<input type="checkbox"/> MILITARY	<input type="checkbox"/> SOCIAL/HUMANITARIAN
<input checked="" type="checkbox"/> 1700-1799	<input type="checkbox"/> ART	<input type="checkbox"/> ENGINEERING	<input type="checkbox"/> MUSIC	<input type="checkbox"/> THEATER
<input type="checkbox"/> 1800-1899	<input type="checkbox"/> COMMERCE	<input type="checkbox"/> EXPLORATION/SETTLEMENT	<input type="checkbox"/> PHILOSOPHY	<input type="checkbox"/> TRANSPORTATION
<input type="checkbox"/> 1900-	<input type="checkbox"/> COMMUNICATIONS	<input type="checkbox"/> INDUSTRY	<input type="checkbox"/> POLITICS/GOVERNMENT	<input type="checkbox"/> OTHER (SPECIFY)
		<input type="checkbox"/> INVENTION		

SPECIFIC DATES 18th & 19th centuries BUILDER/ARCHITECT

STATEMENT OF SIGNIFICANCE

The Clarkland Farm and Log Smoke House is significant historically and architecturally.

Historically it is significant as an example of a semi-independent tenant farm existing as a working farm since before 1850.

An interesting Howard County deed, dated November 30, 1850 (10-366), conveyed the property to Charles R. Carroll, as trustee for the grantor and his heirs, Henry H. Pue, Charles R. Pue, and Emily L. Pue his wife for \$4,500. The following interesting stipulation was made in the deed:

Nevertheless...the said Carroll and his heirs will and shall hold the same in trust for the following purpose to wit: to suffer and allow the said Charles R. Pue et al during his life to take, receive and manage the rents, issues, products and crops and to apply the same and the proceeds thereof to his own purposes....

Charles R. and Emily L. Pue raised several children here. Among them the following heirs who received a deed to the farm on February 27, 1899 from Charles A. Carroll, eldest son of Charles R. Carroll, trustee. They were: Rebecca D. Cralgan, Charles R. Pue, Alfred W. Pue, J. Williams Pue, Michael Pue, Sophia G. Dunkle, Sarah C. Dunkle, Mary E. Brown, and Arthur Pue. (JHO 70-15)

On March 31, 1951, C. Orman Monaghan conveyed the farm to J. Dallas Brown who had resided here for many years.(223-466)

On the 24 May 1957 James D. Brown, Jr. and Ruth Brown Monaghan, administrators of the estate of Mollie K. Brown, conveyed the farm to James Clark, Jr., Maryland State Senator for Howard County, who makes his home here. (299-1)

Both the Martinette Map of Howard County of 1860 and the Hopkins' Atlas of 1878 (see Attachment 3) indicate two buildings and 160 acres as the residence of C. R. Pue.

CONTINUE ON SEPARATE SHEET IF NECESSARY

As a working farm, then, it has continued for over 100 years, providing a livelihood to the Pue and Brown families as well as one of the loveliest farms seen on the north side of Route 108, once called Montgomery Road. This road and Centennial Lane are presently being studied by the traffic engineers who plan to improve and widen both roads.

Any plans for future realignment of these roads should take care to insure the integrity of this 100 year old farm, once a part of "Hammond's Inheritance."

In an interview with Senator Clark, the fact that the farm was acquired by J. Dallas Brown and his wife, Mollie, in 1903 was indicated by the Senator. It was bought for \$3,000 and paid for within two years. It was the remodeling efforts of Mr. and Mrs. Brown in 1903 which resulted in the gable roof of the old stone house, which ran east-west, to be changed to run north-south. An old log kitchen on the north wall of the stone house was demolished at that time and the present frame addition, holding entrance hall, dining room and kitchen, constructed from lumber on the property.

In 1951 Senator and Mrs. Clark bought the farm with a life estate to the Browns. In 1957 Mollie Brown died and her estate was conveyed to Senator and Mrs. Clark who now make their home here. They, too, made certain changes in the stone house. The location of its original central rectangular south entrance door now holds a lovely fireplace and exterior brick chimney. In addition, a new roof was put on the old log smoke house, believed to be the third roof for this structure, which dates at least to circa 1850.

Senator Clark's family helped to settle Howard County, originally living at Wheatfields, a fine Howard County landmark on Montgomery Road. A dining room table from that house graces the dining room of Clarkland Farm, as well as an 1823 sideboard (I Needles) from Morris Tyson's estate, a cousin of the Clark family. Keewaydin (Windy Hill), a more recent Howard County landmark, built by Senator Clark's father, Judge James Clark, Sr. for his bride Alda Tyson Hopkins was the childhood home of Senator James Clark. A family heritage of public service runs deep. Senator Clark's father served Howard County many faithful years as Circuit Court Judge, while Senator Clark's brother, John, was judge of the Orphan Court of Howard County and has been active in historic preservation, serving as Trustee for the Maryland Historical Trust and responsible for many fine pieces of historical research, many of which have been incorporated in the present Howard County Historic Sites Inventory.

Senator Clark, too, has shared his brother and mother's enthusiasm for historic research and preservation. His interest has also extended to the conservation of our natural resources in his furtherance of State Open Space legislation and the present legislation to protect

Maryland agricultural farm land .

The Clarkland Farm incorporates not only the old Pue Farm of 160 acres on the northwest corner of Centennial Lane and Route 108, but also the adjoining farm west of the property also on the north side of 108 which once belonged to Reuben Dorsey Rogers, a lawyer in Ellicott City. According to Senator James Clark, the frame house, north of the Stone Tenant House of Clarkland Farm, Ho-314, was built on the stone foundation of the old frame house of Reuben Dorsey Rogers who lived here in his youth.

North of this latter house is another house, which was probably the Carr farm, noted on the Hopkins Atlas of 1878 (see Attachment 3.) Mr. Johnson's Log House, north of the stone tenant house, may also have belonged to the Carr Farm.

Many old landmarks have disappeared, so important in the past. The old Columbia Post Office which once stood on the northwest corner of Route 29 and Route 108, now a part of the Allview Golf Course, has disappeared. The Elioak Post Office, west of Clarkland Farms, also once served this area of Howard County. An old School House was located nearby on the north side of Rt. 108, opposite the new Lewis Veterinary Clinic. Miss Linthicum once taught school over the Elioak Post Office and Store. Today the well kept buildings of Clarkland Farm remain as vestiges of a time gone by. Excellently maintained and utilized, their continued preservation is of the utmost importance to both the state and the nation.

An interesting historical footnote is the fact that while campaigning in Howard County, future President, Jimmy Carter, stayed here at Clarkland Farm.

**9 MAJOR BIBLIOGRAPHICAL REFERENCES**

Howard County Land Records  
Interview with Senator and Mrs. Clark at Clarkland Farms,  
April 1, 1978.

CONTINUE ON SEPARATE SHEET IF NECESSARY

**10 GEOGRAPHICAL DATA**

ACREAGE OF NOMINATED PROPERTY 160 acres

Please see Attachment 1, Tax Maps 29 & 30, p. 18

VERBAL BOUNDARY DESCRIPTION

Please see Howard County Land Records, Liber. 299, folio 001.

LIST ALL STATES AND COUNTIES FOR PROPERTIES OVERLAPPING STATE OR COUNTY BOUNDARIES

STATE Maryland COUNTY Howard

STATE COUNTY

**11 FORM PREPARED BY**

NAME / TITLE

Cleora Barnes Thompson, Archivist

ORGANIZATION

Office of Planning & Zoning-Comprehensive Planning Section 465-5000 x257

DATE

STREET & NUMBER

3450 Court House Drive

TELEPHONE

CITY OR TOWN

Ellicott City

STATE

Maryland

The Maryland Historic Sites Inventory was officially created by an Act of the Maryland Legislature, to be found in the Annotated Code of Maryland, Article 41, Section 181 KA, 1974 Supplement.

The Survey and Inventory are being prepared for information and record purposes only and do not constitute any infringement of individual property rights.

RETURN TO: Maryland Historical Trust  
The Shaw House, 21 State Circle  
Annapolis, Maryland 21401  
(301) 267-1438



STONE HOUSE

FRAME ADDITION

Figure 1  
HO-186  
Clarkland Farm  
East Elevation



Figure 2  
HO-186  
Clarkland Farm Residence  
North Elevation

Attachment 3  
 Ho-186  
 Clarkland Farm Smoke House  
 Hopkins Atlas of 1878  
 District 2

# (SECOND DISTRICT)

HOWARD COUNTY

Scale 2 Inches per Mile

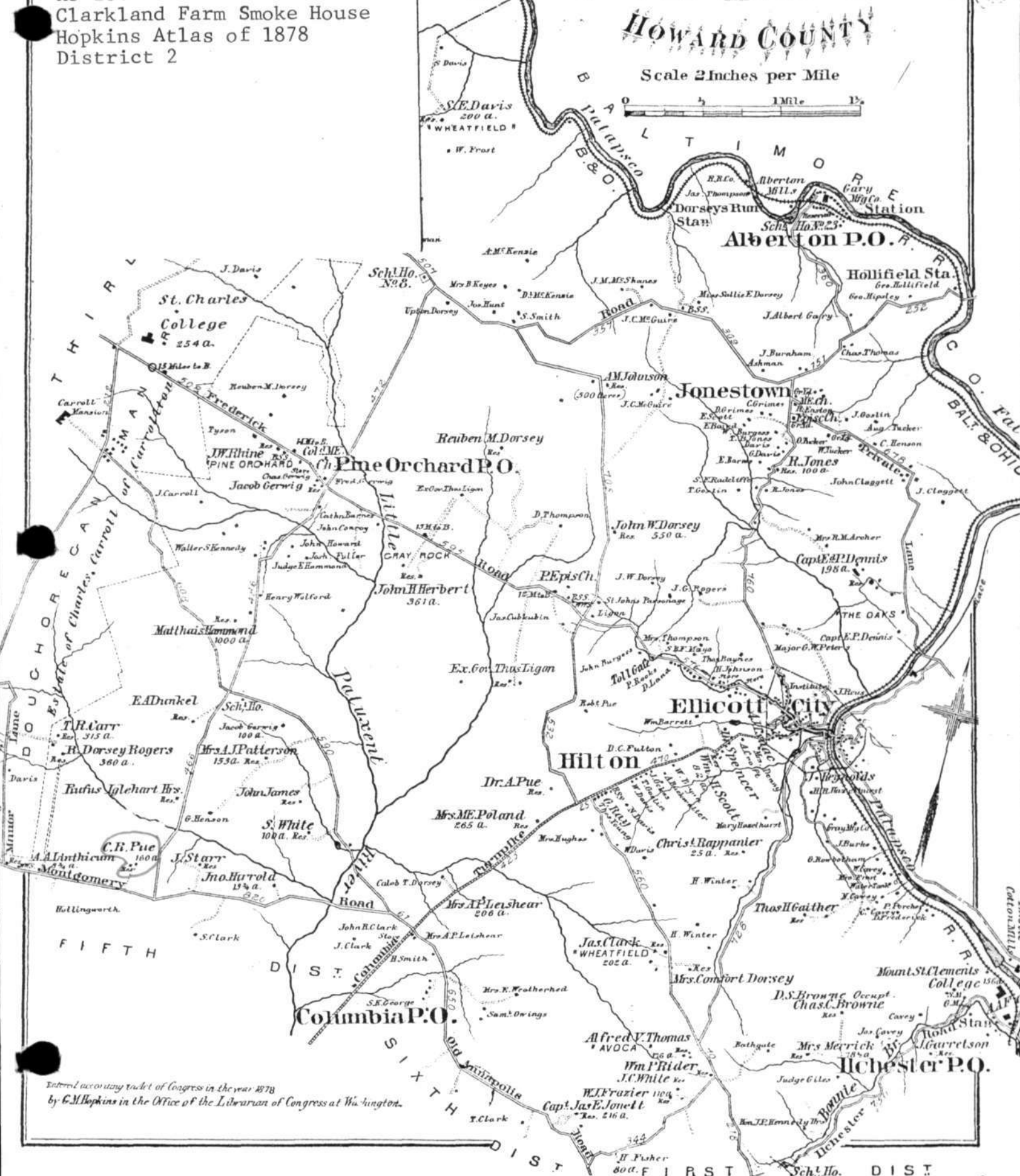

Entered according to Act of Congress in the year 1878  
 by G.M. Hopkins in the Office of the Librarian of Congress at Washington.

Attachment 1  
Ho-186  
Clarkland Farm Smoke House  
Tax Maps 29 and 30

M. E. JOHNSON  
143/9  
112 G1A.  
P. 2

JAMES CLARK  
270/515  
336A.  
P. 3

MAP 30-P.1

JOHN J. MOOSBERGER ET. AL.  
436/4'2, 447/635  
123.44 A.  
P. 1

P. 143  
P. 7  
P. 311

JOEL KLIN  
65/36B  
81/600  
P. 9

DUANE F. ALEXANDER  
480/367  
14.63A.  
P. 8

LOT 1  
14.52A.

LOT 2  
14.61A.

NO. CO. BD. OF C.  
DEPT. OF FORES  
LAW DOCKE  
73.91A.  
P. 295

JAMES CLARK, JR.  
239/1  
160A.  
P. 18

MAP 27-P.18

HOWARD COUNTY, MD  
781/592  
63.62A  
P. 345

Wm. C. STEVENS  
220/182  
P. 11

L. C. CURTIS  
301 HORNEY  
583556  
P. 10

J. W. GARDNER ET. AL.  
733/180  
5.40A.  
P. 83

J. W. GARDNER  
6.00A 460/774  
8.65A.  
P. 133

GEO. J. PHILLIPS  
481/27  
30.00A.  
P. 137

ROBT. W. DOUGLAS &  
WALTER W. JACOBS  
551/120  
32.28A.  
P. 72

ET. AL.  
R/O.  
P. 66

LOT 2  
LOT 1

AREA IV  
AREA III  
AREA II  
AREA I



Attachment 2  
Ho-186  
Clarkland Farm Smoke House  
U.S. Geological Survey Maps  
Ellicott City and Savage, Md.  
Quadrangles

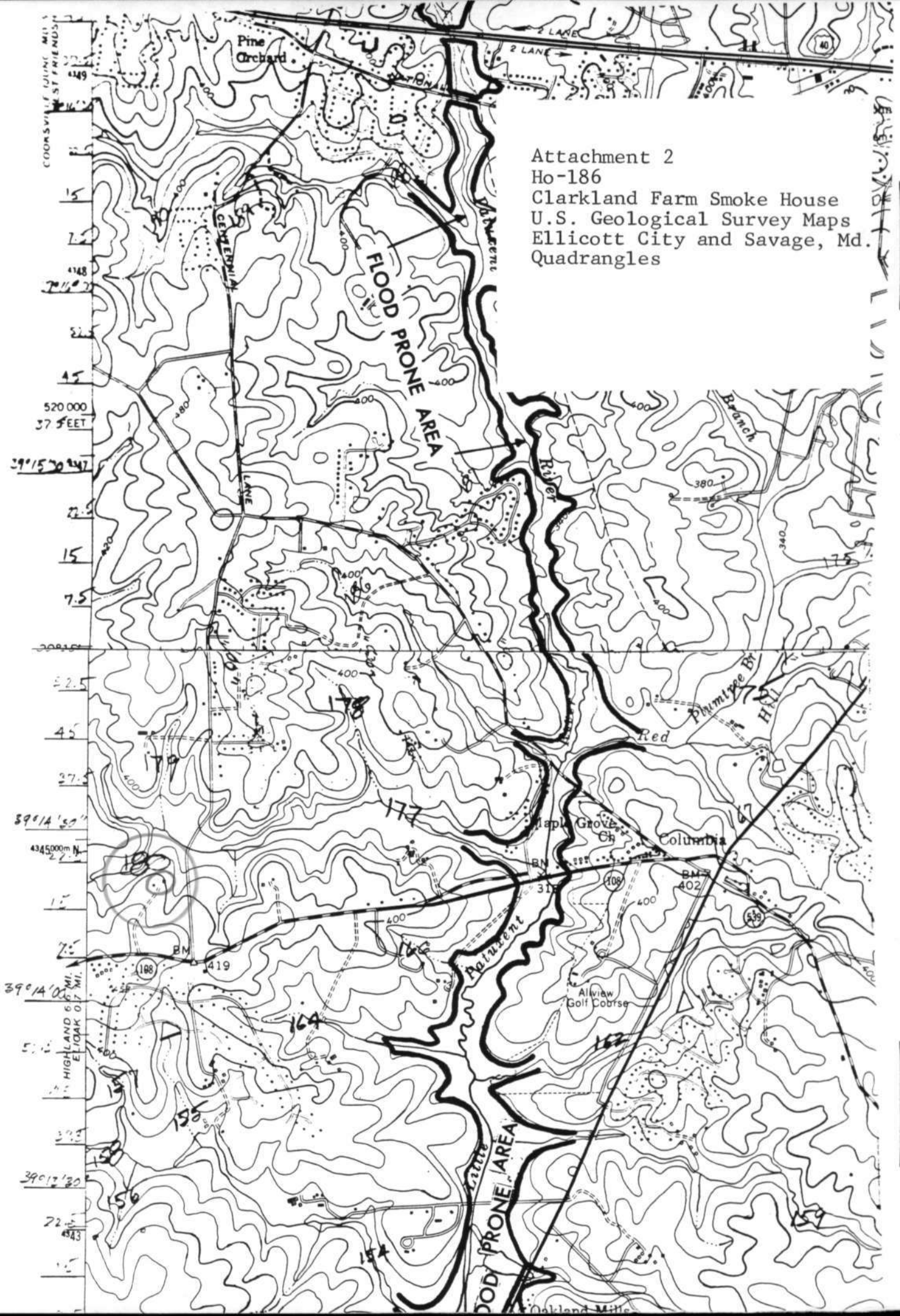



H0-186  
CLARKLAND FARM RESIDENCE  
SOUTH  
C.B. THOMPSON, AIP  
FEB - 1978



Ho-186  
CLARK AND FARM LOG SMOKE HOUSE  
SOUTH  
CO THOMPSON, AIP  
FEB - 1978



HO 186

9340

James Clarke's house

JSE Mar 72



Hb 186

View northwest from house

9340

James Clarke's house

JSE Mar '72



9340

James Clarke's log cottage

SE Mar. 72