

HO-153

Fairview (Warfield's Range, Gorman House)

Architectural Survey File

This is the architectural survey file for this MIHP record. The survey file is organized reverse-chronological (that is, with the latest material on top). It contains all MIHP inventory forms, National Register nomination forms, determinations of eligibility (DOE) forms, and accompanying documentation such as photographs and maps.

Users should be aware that additional undigitized material about this property may be found in on-site architectural reports, copies of HABS/HAER or other documentation, drawings, and the “vertical files” at the MHT Library in Crownsville. The vertical files may include newspaper clippings, field notes, draft versions of forms and architectural reports, photographs, maps, and drawings. Researchers who need a thorough understanding of this property should plan to visit the MHT Library as part of their research project; look at the MHT web site (mht.maryland.gov) for details about how to make an appointment.

All material is property of the Maryland Historical Trust.

Last Updated: 02-07-2013

Ho-153
Fairview/Gorman House
Laurel
Private

The three story high, frame, mansard roofed, Gorman House, called Fairview, is an outstanding example of the Queen Anne style in American architecture which is represented by irregularity of plan and massing. Window panes are varied, holding small panes in their upper parts only. Bay windows are employed. Roofs are high and multiple with intersecting gabled roof bay windows springing from the west and north walls of the main structure with multiple dormer windows covered by gabled, jerkin, tent and A roofs. A large central porch gable on the south facade as well as tall, brick, corbeled edge chimneys contribute much to the over all effect.

Once a part of Warfield's Range laid out in 1686 by Richard and John Warfield, comprising over 1000 acres, this portion of 500 acres, passed from the Warfield family to the Burgess family. Dr. Charles Griffith Worthington acquired it and called it Fairview. He later sold it to Peter Gorman, father of Senator Arthur Pue Gorman. It was Senator Gorman who constructed the present house in 1885, designed by Goit.

MARYLAND HISTORICAL TRUST

INVENTORY FORM FOR STATE HISTORIC SITES SURVEY

1 NAME

HISTORIC Fairview/Warfield's Range

AND/OR COMMON The Gorman House

2 LOCATION

STREET & NUMBER 10150 Gorman Road

CITY, TOWN Laurel VICINITY OF CONGRESSIONAL DISTRICT

STATE Maryland COUNTY Howard

3 CLASSIFICATION

CATEGORY	OWNERSHIP	STATUS	PRESENT USE
<input checked="" type="checkbox"/> DISTRICT	<input type="checkbox"/> PUBLIC	<input checked="" type="checkbox"/> OCCUPIED	<input type="checkbox"/> AGRICULTURE <input type="checkbox"/> MUSEUM
<input type="checkbox"/> BUILDING(S)	<input checked="" type="checkbox"/> PRIVATE	<input type="checkbox"/> UNOCCUPIED	<input type="checkbox"/> COMMERCIAL <input type="checkbox"/> PARK
<input type="checkbox"/> STRUCTURE	<input type="checkbox"/> BOTH	<input type="checkbox"/> WORK IN PROGRESS	<input type="checkbox"/> EDUCATIONAL <input checked="" type="checkbox"/> PRIVATE RESIDENCE
<input type="checkbox"/> SITE	PUBLIC ACQUISITION	ACCESSIBLE	<input type="checkbox"/> ENTERTAINMENT <input type="checkbox"/> RELIGIOUS
<input type="checkbox"/> OBJECT	<input type="checkbox"/> IN PROCESS	<input type="checkbox"/> YES: RESTRICTED	<input type="checkbox"/> GOVERNMENT <input type="checkbox"/> SCIENTIFIC
	<input type="checkbox"/> BEING CONSIDERED	<input type="checkbox"/> YES: UNRESTRICTED	<input type="checkbox"/> INDUSTRIAL <input type="checkbox"/> TRANSPORTATION
		<input type="checkbox"/> NO Limited	<input type="checkbox"/> MILITARY <input type="checkbox"/> OTHER

4 OWNER OF PROPERTY

NAME Arthur G. Lambert, Exec.

Telephone #:

STREET & NUMBER 1629 K Street N.W.

CITY, TOWN Washington, VICINITY OF STATE, zip code D.C. 20006

5 LOCATION OF LEGAL DESCRIPTION

COURTHOUSE, REGISTRY OF DEEDS, ETC. Hall of Records

Liber #: Tax Maps 42 & 47, p 286
Folio #: 6-99

STREET & NUMBER Howard County Court House

CITY, TOWN Ellicott City STATE Maryland

6 REPRESENTATION IN EXISTING SURVEYS

TITLE Howard County Historic Sites Inventory

DATE 1977 FEDERAL STATE COUNTY LOCAL

DEPOSITORY FOR SURVEY RECORDS Maryland Historical Trust

CITY, TOWN Annapolis STATE Maryland

DESCRIPTION

CONDITION		CHECK ONE	CHECK ONE
<input type="checkbox"/> EXCELLENT	<input type="checkbox"/> DETERIORATED	<input checked="" type="checkbox"/> UNALTERED	<input checked="" type="checkbox"/> ORIGINAL SITE
<input checked="" type="checkbox"/> GOOD	<input type="checkbox"/> RUINS	<input type="checkbox"/> ALTERED	<input type="checkbox"/> MOVED DATE _____
<input type="checkbox"/> FAIR	<input type="checkbox"/> UNEXPOSED		

DESCRIBE THE PRESENT AND ORIGINAL (IF KNOWN) PHYSICAL APPEARANCE

Fairview is located on a tract of some eighty acres on the north side of Gorman Road, some 2 miles east of U.S. Route 29. South of the house is a complex of barns and auxiliary farm buildings which was the original homestead of Peter Gorman. Fairview is a six bay wide, four bay deep, three story high frame house, built by Goit in 1885, set on a stone foundation, with Central Mansard roof.

Tall brick Chimneys with corbeled edges are located on the north and south sides of the east and west walls. West Elevation: A projecting, three story high, intersecting gabled roof (running east-west), bay extends from the center of its west wall. Its third floor, double-hung, double window is inset into the A formed by the gable, each rectangular component holding sixteen - over - one lights. The bay window formed at the end of this projection holds a first and second floor rectangular window on each of its three sides with one - over - one lights. A one story high porte cochere whose double doric columns support its tent roof and rest on stone piles extends from the second south bay and is connected to the house by a gabled roof connector. A three bay wide, two bay deep intersecting gabled roof crunning north-south) service wing extends from the north wall of the house. It's west wall holds two gabled roof dorner windows holding rectangular, double-hung windows with sixteen over-two lights. Its north elevation holds a third floor tripartite rectangular, double-hung window inset into the A of the gable. Each component holds sixteen-over-one lights. Its second floor holds three rectangular, double-hung windows with one-over-one lights and one small rectangular window in the second east bay holding twelve-over-one lights. Five wooden steps lead to a one story high open porch running along the north elevation, which is supported by stone piles. Four columns and two pilasters support the roof which covers the rectangular entrance in the west bay, surmounted by a one light transom.

On the east wall of this section of the house was once an open first and second floor porch with third floor balcony. The first floor porch remains partially opened while the second floor porch has been enclosed.

The east side of the north wall of the main house (Mansard roof structure) holds a central gabled roof dorner with rectangular entrance on to the once once open porch. A jerkin roofed dorner lies east of it and holds a rectangular, double-hung window with sixteen-over-two lights. Three A framed gables holding triangular three light windows, are set into the top of the mansard roofs north elevation.

CONTINUE ON SEPARATE SHEET IF NECESSARY

EAST ELEVATION

Two tall brick chimneys are inset into the east wall of the main house. A second floor projecting oriel window holds two rectangular, double-hung leaden paned windows. The base of the oriel is shingled. Two tent roofed dormer windows holding rectangular double-hung windows with sixteen-over-two lights are inset into the mansard roof, south of the oriel window.

SOUTH ELEVATION

The south or front facade of Fairview holds a tent roofed polygonal turret in the east bay of the south wall. The central bay of the turret holds a tall, rectangular window with twenty-four-over-two lights, while squat, rectangular windows lie on each side of it, holding sixteen-over-two lights.

A jerkinhead roofed dormer window rests in the west bay holding sixteen-over-two lights. A large oriel window on the second floor holds three rectangular windows with one-over-one lights. A double window is inset into a gabled roof dormer holding sixteen-over-one lights.

A second floor open porch is located in the central bay with two rectangular entrances surmounted by one light transoms. Ten doric columns support its shed roof. The central first floor bay holds a central rectangular doorway, surmounted by a one light transom and flanked by rectangular, double-hung windows with one-over-one lights. This central bay projects outward on the west and remains flush on the east. In addition, the one story, hipped roofed, open porch which runs along the east, west and south walls of the house also follows this pattern of irregularity on its south elevation. It is supported at intervals by coupled doric columns which increase to three at the corners of the porch. Six wooden steps lead to this hipped roofed porch which has a central gabled roof (running north-south) pediment over the central bay entrance way.

Interior doorways in the house have one light transoms above for air and light.

The total irregularity of the plan and massing of this house at every elevation is representative of the Queen Anne Style of architecture begun in England in 1868, and initiated in 1874 by H.H. Richardson in Newport, R.I. with The Watts Sherman House. The bay windows, oriel window, dormer windows, various paned windows as well as the mansard roof with predominant A roofed dormers all are representative of this style. The large central porch gable on the south facade as well as the tall brick corbeled edge chimneys contribute much to the over-all effect.

The house is set within a grove of mature trees and shrubbery.

8 SIGNIFICANCE

<p>PERIOD</p> <p><input type="checkbox"/> PREHISTORIC</p> <p><input type="checkbox"/> 1400-1499</p> <p><input type="checkbox"/> 1500-1599</p> <p><input type="checkbox"/> 1600-1699</p> <p><input type="checkbox"/> 1700-1799</p> <p><input checked="" type="checkbox"/> 1800-1899</p> <p><input type="checkbox"/> 1900-</p>	<p>AREAS OF SIGNIFICANCE -- CHECK AND JUSTIFY BELOW</p> <p><input type="checkbox"/> ARCHEOLOGY-PREHISTORIC</p> <p><input checked="" type="checkbox"/> ARCHEOLOGY-HISTORIC</p> <p><input type="checkbox"/> AGRICULTURE</p> <p><input checked="" type="checkbox"/> ARCHITECTURE</p> <p><input type="checkbox"/> ART</p> <p><input type="checkbox"/> COMMERCE</p> <p><input type="checkbox"/> COMMUNICATIONS</p>	<p><input type="checkbox"/> COMMUNITY PLANNING</p> <p><input type="checkbox"/> CONSERVATION</p> <p><input type="checkbox"/> ECONOMICS</p> <p><input type="checkbox"/> EDUCATION</p> <p><input type="checkbox"/> ENGINEERING</p> <p><input type="checkbox"/> EXPLORATION/SETTLEMENT</p> <p><input type="checkbox"/> INDUSTRY</p> <p><input type="checkbox"/> INVENTION</p>	<p><input type="checkbox"/> LANDSCAPE ARCHITECTURE</p> <p><input type="checkbox"/> LAW</p> <p><input type="checkbox"/> LITERATURE</p> <p><input type="checkbox"/> MILITARY</p> <p><input type="checkbox"/> MUSIC</p> <p><input checked="" type="checkbox"/> PHILOSOPHY</p> <p><input type="checkbox"/> POLITICS/GOVERNMENT</p>	<p><input type="checkbox"/> RELIGION</p> <p><input type="checkbox"/> SCIENCE</p> <p><input type="checkbox"/> SCULPTURE</p> <p><input type="checkbox"/> SOCIAL/HUMANITARIAN</p> <p><input type="checkbox"/> THEATER</p> <p><input type="checkbox"/> TRANSPORTATION</p> <p><input type="checkbox"/> OTHER (SPECIFY)</p>
--	---	---	--	---

SPECIFIC DATES 1885 BUILDER/ARCHITECT GOIT

STATEMENT OF SIGNIFICANCE

Warfield's Range was laid out in 1686 by Richard and John Warfield and comprised 1080 acres.

Circa 1760 The Anne Anndel County Debt book indicates Samuel Warfield holding 1130 acres at Warfields Range.

The daughters of Alexander and Thompsey Worthington Warfield married brothers, Caleb and West Burgess, both involved in the Revolution. Their children held a portion of "Warfields Range." Dr. Charles Griffith Worthington bought this portion of "Warfields Range" from Samuel Burgess and Leonard Sellman. Peter Gorman, father of Senator A.P. Gorman bought the old homestead of Dr. Charles Griffith Worthington called Fairview, comprising, 500 acres of Warfields Range, and moved from Woodstock to this location.

His father, John Gorman was born in Northern Ireland. He married Miss McDonald also of the North of Ireland. They first settled in Harrisburg but later moved to Baltimore where their son Peter, father of Senator Arthur Pue Gorman, was born.

Peter Gorman became the contract or and builder of the first section of the B & O Railroad from Ellicott Mills to Woodstock. While at Woodstock he met and married Miss Elizabeth Browne, daughter of John Riggs Browne of "Good Fellowship."

Sarah Gassaway was Elizabeth's mother and the daughter of Brice John Gassaway and Dinah Warfield, a sister of Major Charles Alexander Warfield. Senator Arthur Pue Gorman, their Son was born at Woodstock in 1839 and later moved with the family to Fairview.

Fairview is located five miles northwest of Laurel upon a ridge which commands an extensive view.

The present building stands upon the same site as the original house, constructed by Arthur Pue Gorman after the War Between the States, and burned sometime before 1885. This house dates circa 1885.

Three hundred yards South is the homestead of Peter and Elizabeth Brown Gorman. Only the barns remain with the stone foundation of the house.

Peter Gorman was actively engaged in politics and was one of Stephen Douglas' strongest supporters for the Presidency in 1860. When the Civil War came, he supported the Union. During that war he traveled south on private business and was captured and confined in Libby Prison. He died shortly after his release.

Through the friendship of his father, Peter with Senstor Douglas, Arthur Pue Gorman was made a page in the Senate, and became a favorite with all who knew him. When the Civil War brought a Republican Majority, this popularity secured his retention as page and eventually his promotion to postmaster.

When the question of the impeachment of Andrew Johnson came up, Arthur Pue Gorman was actively opposed and lost his position because of it.

He later was appointed Collector of Internal Revenue for the fifth District through the efforts of Montgomery Blair, Beverly Johnson and Thomas A. Hendricks. The accounts of the fifth District had never been settled satisfactorily. Mr. Gorman corrected this.

In 1869, aged 30, he was elected to the Maryland House of Delegates and returned in 1872 serving as Speaker. He left his chair to advocate \$150,000 appropriation for the education of black Americans.

Three years later he was elected to the Maryland Senate. During this time he was also appointed a member of the Board of Directors of the Chesapeake and Ohio Canal Company. When President of the Company he made it return over one million dollars, more than double the amount it had returned twenty years.

In 1877 he became Chairman of the State Central Committee and in 1882 was elected to the United States Senate.

He was a close friend of President Grover Cleveland and during Cleveland's second campaign for the presidency was chosen to be his campaign Manager. His management of the campaign in New York was out standing. He telegraphed to the World. "Cleveland is elected and will be inaugurated."

At 28 he married Mrs. Hannah Donagan Swartz of Reading, Pennsylvania. They had six children. Their only son, Colonel Arthur Pue Gorman, Jr. was an attorney and State Senator from Howard County. His wife Grace until 1977 lived in the present house which is now occupied by Kingdon Gould III.

The Gorman House is an outstanding example of the the Queen Anne Style in American architecture which is represented by irregularity of plan and massing. Windows are variated in form and hold small panes in their upper parts only. Bay windows are employed and roofs are high and multiple, while a polygonal turret is featured in the central bay of the south or front facade.

The history of the Queen Anne style began in 1868 with a house

in Sussex call Leyswood, designed by Ricahrd Norman Shaw. H.H. Richardson was the first great American architect to work on this style in The Sherman House at Newport (1874). For these reasons the Gorman House should be considered for inclusion to the National Register of Historic Places, and any future land marks legislation which the county initiates.

9 MAJOR BIBLIOGRAPHICAL REFERENCES

Stein, Jr., Charles F. Origin and History of Howard County, Maryland. Baltimore, 1972. pp. vii, 5, 114, 134-137, 178, 210, 307, 211-212.

Warfield, J.D. Founders of Anne Arundel and Howard Counties, Maryland. Baltimore, 1973, pp. 366, 371-374, 376, 378.

Whiffen, Marcus, American Architecture Since 1780. MIT Press, 1969.

CONTINUE ON SEPARATE SHEET IF NECESSARY

10 GEOGRAPHICAL DATA

ACREAGE OF NOMINATED PROPERTY 81.476 Acres

Please see Attachment 1, Tax Maps 42 & 47, Blk 20, p. 286 6-99

VERBAL BOUNDARY DESCRIPTION

LIST ALL STATES AND COUNTIES FOR PROPERTIES OVERLAPPING STATE OR COUNTY BOUNDARIES

STATE COUNTY

STATE COUNTY

11 FORM PREPARED BY

NAME / TITLE

Cleora Barnes Thompson, Archivist

ORGANIZATION

Office of Planning & Zoning-Comprehensive Planning Section

DATE

465-5000 x257

STREET & NUMBER

3450 Court House Drive

TELEPHONE

CITY OR TOWN

Ellicott City

STATE

Maryland

The Maryland Historic Sites Inventory was officially created by an Act of the Maryland Legislature, to be found in the Annotated Code of Maryland, Article 41, Section 181 KA, 1974 Supplement.

The Survey and Inventory are being prepared for information and record purposes only and do not constitute any infringement of individual property rights.

RETURN TO: Maryland Historical Trust
The Shaw House, 21 State Circle
Annapolis, Maryland 21401
(301) 267-1438

Sixth District.
 GENERAL MERCHANT.
 A. J. GALL,
 Dealer in Groceries, Provisions, Liquors,
 &c.
 Hooversville.

EXPLANATIONS
 Dist. & Co. Lines -----
 County Roads
 Private "
 Turnpike "
 Rail Roads
 Streams
 The figures along the Roads
 shows the distance in Rods,
 from junction to junction thereof.

Attachment 3
 HO-153
 Fairview - Gorman House
 Hopkin's Atlas
 District 6
 1878

GUILFORD DISTRICT

HOWARD COUNTY

Scale 2 1/4 Inches per Mile.

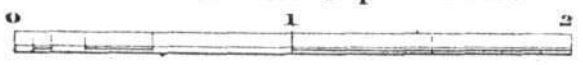

Entered according to act of Congress in the year 1878 by G. M. Hopkins in the Office of the Librarian of Congress at Washington.

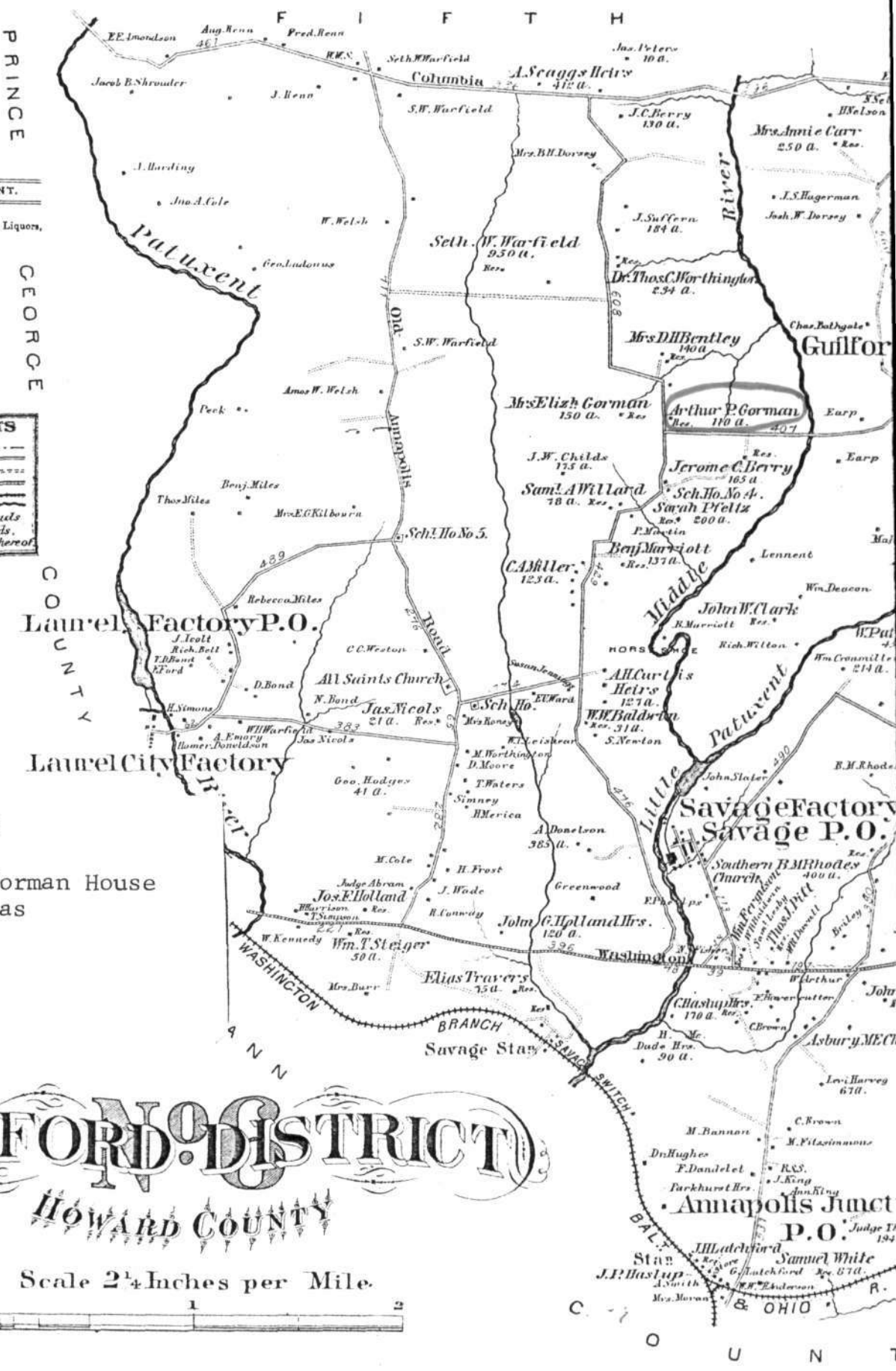

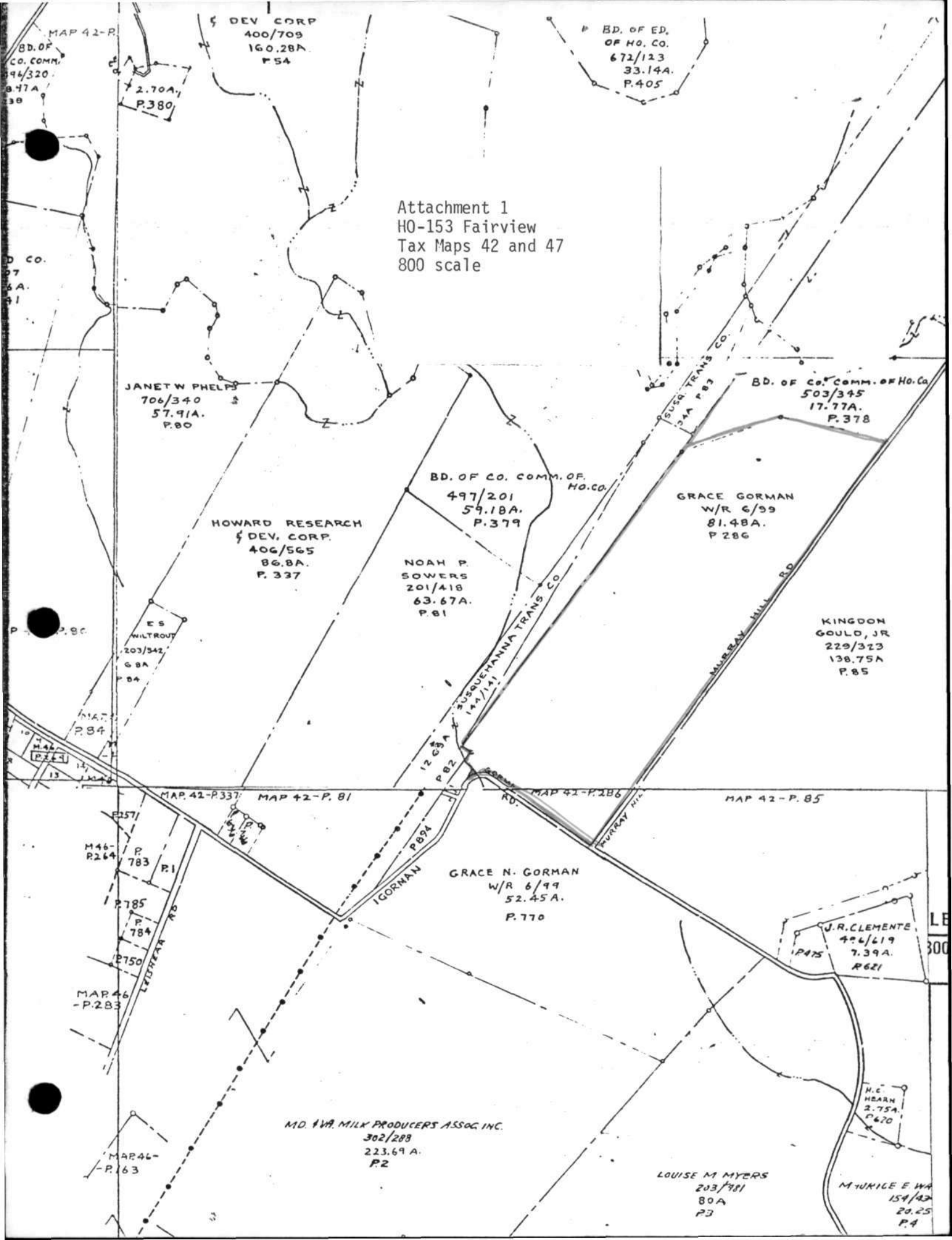

Attachment 1
HO-153 Fairview
Tax Maps 42 and 47
800 scale

MAP 42-P.
BD. OF
CO. COMM.
94/320
9.77A
38

DEV CORP
400/709
160.28A
P.54

BD. OF ED.
OF HO. CO.
672/123
33.14A.
P.405

2.70A.
P.380

JANET W PHELPS
706/340
57.91A.
P.80

SUSQ. TRANS CO.
33A P.83

BD. OF CO. COMM. OF HO. CO.
503/345
17.77A.
P.378

HOWARD RESEARCH
& DEV. CORP.
406/565
86.8A.
P.337

BD. OF CO. COMM. OF
HO. CO.
497/201
59.18A.
P.379

GRACE GORMAN
W/R 6/99
81.48A.
P.286

NOAH P.
SOWERS
201/418
63.67A.
P.81

KINGDOON
GOULD, JR
229/323
138.75A
P.85

ES
WILTROUT
203/342
68A
P.84

GRACE N. GORMAN
W/R 6/99
52.45A.
P.770

J.R. CLEMENTE
426/619
7.39A.
P.621

MD. SW. MILK PRODUCERS ASSOC. INC.
302/288
223.69 A.
P.2

LOUISE M MYERS
203/781
80A
P.3

M. J. UNICE E. WA
154/427
20.25
P.4

D CO.
97
6A.
91

P.8C

MAP 42-P.337

MAP 42-P. 81

MAP 42-P.286

MAP 42-P. 85

M46-
P.264

P. 783

P. 785

P. 784

P. 750

MAR 46
-P.283

MAR 46
-P.163

LE
300



CLEORA BARNES THOMPSON
PLANNING CONSULTANT
HISTORICAL SITES SURVEY

Hb-153
THE GORMAN HOUSE
JUNE-1977



Ho 153

4420

Gorman House 82

Mar 72



Ho 153

4420

Gorman Smokehouse

JS2 Mar 72