

HO-118

## Albert Schulze Post & Plank Building, site

### **Architectural Survey File**

This is the architectural survey file for this MIHP record. The survey file is organized reverse-chronological (that is, with the latest material on top). It contains all MIHP inventory forms, National Register nomination forms, determinations of eligibility (DOE) forms, and accompanying documentation such as photographs and maps.

Users should be aware that additional undigitized material about this property may be found in on-site architectural reports, copies of HABS/HAER or other documentation, drawings, and the “vertical files” at the MHT Library in Crownsville. The vertical files may include newspaper clippings, field notes, draft versions of forms and architectural reports, photographs, maps, and drawings. Researchers who need a thorough understanding of this property should plan to visit the MHT Library as part of their research project; look at the MHT web site ([mht.maryland.gov](http://mht.maryland.gov)) for details about how to make an appointment.

All material is property of the Maryland Historical Trust.

***Last Updated: 05-03-2004***

HO-118  
The Albert Schulze Post & Plank Building  
Woodbine  
Private

circa 1850

The Albert Schulze Post and Plank Building faces north on the east of St. Michaels Road, two tenths of a mile north of its intersection with Florence Road.

It is a three bay wide, one room deep, two story high, gabled roof (running east-west) post and plank building, resting on a stone foundation, with wide, exterior, stone and brick chimney centered into its west wall.

MARYLAND HISTORICAL TRUST

HO-118  
Dist. 4

MAGI #1401195404

INVENTORY FORM FOR STATE HISTORIC SITES SURVEY

**1 NAME**  
 HISTORIC  
 AND/OR COMMON Albert Schulze Post and Plank Building

**2 LOCATION**  
 STREET & NUMBER STEPS. of St. Michael's Road, 1.5 miles S.W. of Rt. 144  
 CITY, TOWN Florence CONGRESSIONAL DISTRICT 6th  
 STATE Maryland COUNTY Howard

**3 CLASSIFICATION**

CATEGORY	OWNERSHIP	STATUS	PRESENT USE
<input type="checkbox"/> DISTRICT	<input type="checkbox"/> PUBLIC	<input type="checkbox"/> OCCUPIED	<input type="checkbox"/> AGRICULTURE <input type="checkbox"/> MUSEUM
<input checked="" type="checkbox"/> BUILDING(S)	<input checked="" type="checkbox"/> PRIVATE	<input checked="" type="checkbox"/> UNOCCUPIED	<input type="checkbox"/> COMMERCIAL <input type="checkbox"/> PARK
<input type="checkbox"/> STRUCTURE	<input type="checkbox"/> BOTH	<input type="checkbox"/> WORK IN PROGRESS	<input type="checkbox"/> EDUCATIONAL <input type="checkbox"/> PRIVATE RESIDENCE
<input type="checkbox"/> SITE	<b>PUBLIC ACQUISITION</b>	<b>ACCESSIBLE</b>	<input type="checkbox"/> ENTERTAINMENT <input type="checkbox"/> RELIGIOUS
<input type="checkbox"/> OBJECT	<input type="checkbox"/> IN PROCESS	<input type="checkbox"/> YES: RESTRICTED	<input type="checkbox"/> GOVERNMENT <input type="checkbox"/> SCIENTIFIC
	<input type="checkbox"/> BEING CONSIDERED	<input type="checkbox"/> YES: UNRESTRICTED	<input type="checkbox"/> INDUSTRIAL <input type="checkbox"/> TRANSPORTATION
		<input type="checkbox"/> NO <u>limited</u>	<input type="checkbox"/> MILITARY <input checked="" type="checkbox"/> OTHER <u>vacant</u>

**4 OWNER OF PROPERTY**  
 NAME Albert Schulze etal Telephone #: 489-4985  
 STREET & NUMBER 9015 Adelphi Road  
 CITY, TOWN Adelphi VICINITY OF Maryland STATE, zip code 20783

**5 LOCATION OF LEGAL DESCRIPTION**  
 COURTHOUSE, REGISTRY OF DEEDS, ETC. Tax Map 7, p.213  
 Hall of Records Liber #: 362  
 Folio #: 695  
 STREET & NUMBER Howard County Court House  
 CITY, TOWN Ellicott City STATE Maryland

**6 REPRESENTATION IN EXISTING SURVEYS**  
 TITLE Howard County Historic Sites Inventory  
 DATE 1978-1979  FEDERAL  STATE  COUNTY  LOCAL  
 DEPOSITORY FOR SURVEY RECORDS Maryland Historical Trust  
 CITY, TOWN 21 State Circle, Annapolis STATE Maryland

# 7 DESCRIPTION

HO-118  
District 4

CONDITION		CHECK ONE	CHECK ONE
<input type="checkbox"/> EXCELLENT	<input checked="" type="checkbox"/> DETERIORATED	<input type="checkbox"/> UNALTERED	<input checked="" type="checkbox"/> ORIGINAL SITE
<input type="checkbox"/> GOOD	<input type="checkbox"/> RUINS	<input checked="" type="checkbox"/> ALTERED	<input type="checkbox"/> MOVED      DATE _____
<input type="checkbox"/> FAIR	<input type="checkbox"/> UNEXPOSED		

The Albert Schulze Post and Plank Building is located on the east side of St. Michael's Road, two tenths of a mile north of its intersection with Florence Road. It is a three bay wide, one room deep, two story high, gabled roof (running east-west) post and plank building, resting on a stone foundation, with exterior west chimney.

w The large plate used to support the roof, the large joists for second floor support as well as those members used as studs in the construction of the house, are all hand hewn. Eight to eleven inch vertical boards cover the post and plank framework of the building.

Central rectangular, batten wood north and south entrance doors are flanked by flat pilasters and surmounted by flat lintels with molding. Rectangular, first floor windows rest on either side of the central entrances on the north and south elevations. A square central, second floor window is located over the north entrance. A gabled roof frame appendage covers the stone staircase, featuring five wide stone steps, which lead down to the dirt floor basement of the house.

A square, attic window rests in this east wall, which has deteriorated on its south side.

The interior reveals an open staircase, along the west wall, leading to the second floor sleeping loft. Lathing once covered with plaster is also evident, as well as a first floor dividing wall and original random width floors.

The building stands south of what is the site of a former four room, two story high, gabled roof, farm house, belonging to the Leakin family, who once owned this eighty acre farm.

This old farm house has been torn down and replaced by a new brick rancher, constructed circa 1960, by Mr. and Mrs. A.V. Schulze, the present owners, who have left the old post and plank building untouched.

The buildings are surrounded by fields of vegetables and fruit, produced for a truck farm operated in Adelphi, Maryland by the Schulze family.

**8 SIGNIFICANCE**

PERIOD	AREAS OF SIGNIFICANCE -- CHECK AND JUSTIFY BELOW			
<input type="checkbox"/> PREHISTORIC	<input type="checkbox"/> ARCHEOLOGY-PREHISTORIC	<input type="checkbox"/> COMMUNITY PLANNING	<input type="checkbox"/> LANDSCAPE ARCHITECTURE	<input type="checkbox"/> RELIGION
<input type="checkbox"/> 1400-1499	<input type="checkbox"/> ARCHEOLOGY-HISTORIC	<input type="checkbox"/> CONSERVATION	<input type="checkbox"/> LAW	<input type="checkbox"/> SCIENCE
<input type="checkbox"/> 1500-1599	<input type="checkbox"/> AGRICULTURE	<input type="checkbox"/> ECONOMICS	<input type="checkbox"/> LITERATURE	<input type="checkbox"/> SCULPTURE
<input type="checkbox"/> 1600-1699	<input checked="" type="checkbox"/> ARCHITECTURE	<input type="checkbox"/> EDUCATION	<input type="checkbox"/> MILITARY	<input type="checkbox"/> SOCIAL/HUMANITARIAN
<input type="checkbox"/> 1700-1799	<input type="checkbox"/> ART	<input type="checkbox"/> ENGINEERING	<input type="checkbox"/> MUSIC	<input type="checkbox"/> THEATER
<input checked="" type="checkbox"/> 1800-1899	<input type="checkbox"/> COMMERCE	<input type="checkbox"/> EXPLORATION/SETTLEMENT	<input type="checkbox"/> PHILOSOPHY	<input type="checkbox"/> TRANSPORTATION
<input type="checkbox"/> 1900-	<input type="checkbox"/> COMMUNICATIONS	<input type="checkbox"/> INDUSTRY	<input type="checkbox"/> POLITICS/GOVERNMENT	<input checked="" type="checkbox"/> OTHER (SPECIFY) Local History
		<input type="checkbox"/> INVENTION		

SPECIFIC DATES                      1850                      BUILDER/ARCHITECT

**STATEMENT OF SIGNIFICANCE**

The Albert Schulze Post and Plank Building is important architecturally as an example of post and plank construction and historically in the field of local history through its association with the Leakins family, to Howard County and the State of Maryland.

Though the building today is in a dilapidated state, the open staircase to the upstairs rooms remains and the very wide, original floor boards on the second floor, with remnants of lathing and ceiling plaster throughout. The original, wide, exterior, stone chimney and original cooking fireplace, which once held a crane for holding a cooking vessel, also remains, as well as a very deeply cut stone foundation, which was once used as a root cellar.

The house is reputed, by the Leakins family, to be some 120 years old. An S. Day and W. Pickett are noted in this general location on the 1878 Hopkin's Atlas. Ordinarily slave tenant houses were not constructed on such well-defined and deep stone foundations, such as we find here. In the late nineteenth century and during the first half of the twentieth century, the building was rented out as a residential dwelling by the Leakins family, who had constructed a frame house north of the post and plank dwelling unit. The frame house was demolished when a new brick rancher was constructed on the property. The old post and plank building was abandoned and for a time its root cellar used. Now it stands vacant, leaning heavily to one side.

Its importance is local historically, but it is believed that the early construction methods incorporated within the building, may be of national as well as state significance.

**9 MAJOR BIBLIOGRAPHICAL REFERENCES**

Land Records of Howard County, Maryland  
Interview with Mrs. Louise Johnson, 1694 St. Michael's Road, Woodbine, Md.  
Interview with Mrs. Schulze, May 15, 1979  
Convergence of Surveyors of MHT at Elkton, Maryland May 22, 23, 1979  
Interview with Mr. Joseph Leakins, previous owner and his son, Ronnie Leakins (489-4885)

CONTINUE ON SEPARATE SHEET IF NECESSARY

**10 GEOGRAPHICAL DATA**

ACREAGE OF NOMINATED PROPERTY 78.91 acres

Please see Attachment 1, Tax Map 7

VERBAL BOUNDARY DESCRIPTION

Please see Howard County Land Records, Liber 362 Folio 695

LIST ALL STATES AND COUNTIES FOR PROPERTIES OVERLAPPING STATE OR COUNTY BOUNDARIES

STATE	Maryland	COUNTY	Howard
STATE		COUNTY	

**11 FORM PREPARED BY**

NAME / TITLE

Cleora Barnes Thompson, Archivist

ORGANIZATION

Office of Planning & Zoning-Comprehensive Planning Section

DATE

STREET & NUMBER

3450 Court House Drive

TELEPHONE

CITY OR TOWN

Ellicott City

STATE

Maryland

The Maryland Historic Sites Inventory was officially created by an Act of the Maryland Legislature, to be found in the Annotated Code of Maryland, Article 41, Section 181 KA, 1974 Supplement.

The Survey and Inventory are being prepared for information and record purposes only and do not constitute any infringement of individual property rights.

RETURN TO: Maryland Historical Trust  
The Shaw House, 21 State Circle  
Annapolis, Maryland 21401  
(301) 267-1438

Do  
Not Film

→ name changed in Cleo Thompson's 1977 survey.

Albert Schulze log bldg. (ruin?)  
St. Michael's Rd, Mt Airy

spotted from Road by MMB  
7/20/20.

Albert Schultz - owner

~~HO-102~~

140 102 ~~102~~  
55

HO-118

fox Map # 7

Albert A. Schulze, et al.

362/695

78.91 A.

p. 213

KNILL  
480  
62A.  
209

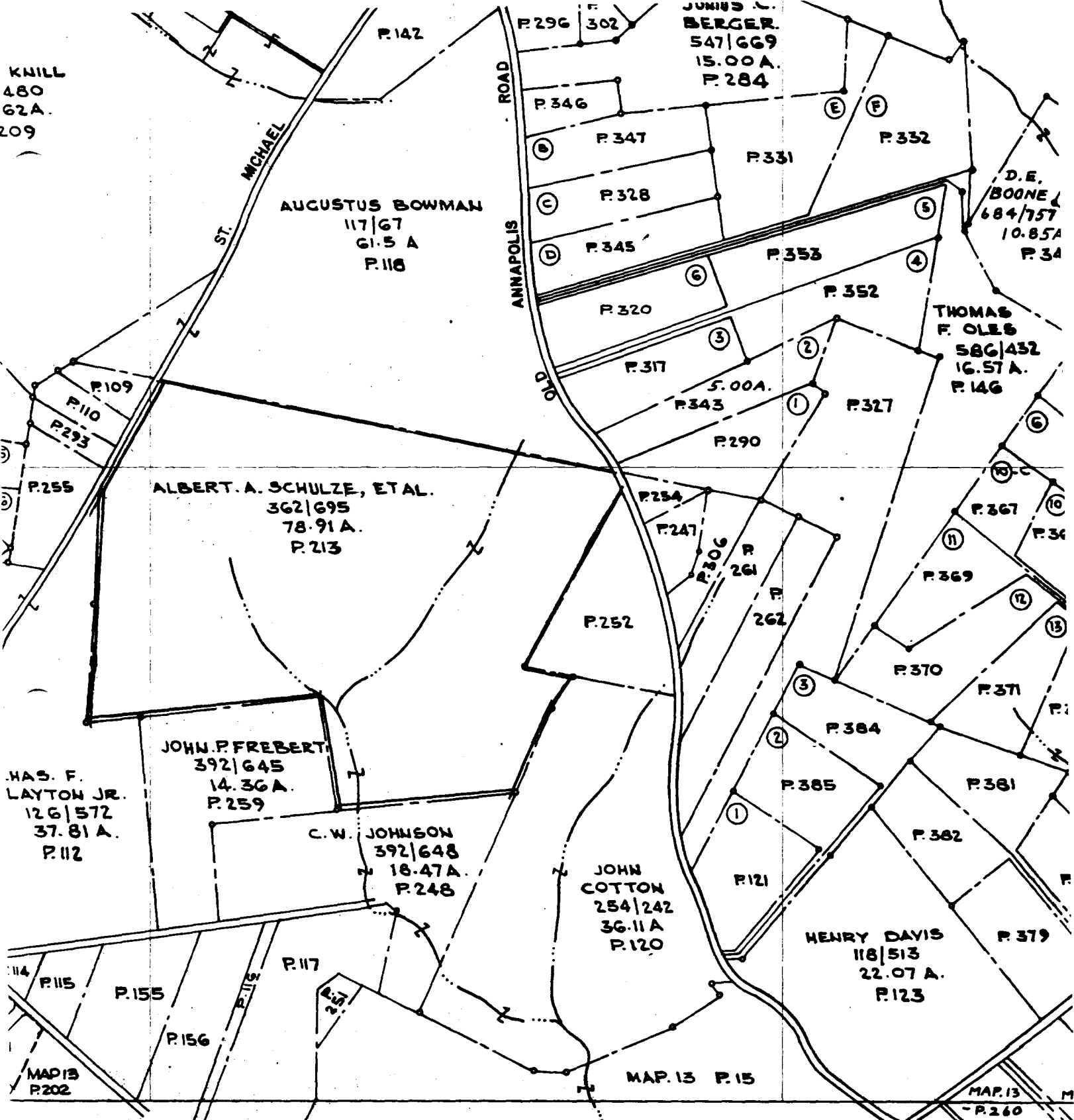

HAS. F. LAYTON JR.  
126|572  
37.81 A.  
P.112

JOHN P. FREBERT  
392|645  
14.36 A.  
P.259

C. W. JOHNSON  
392|648  
18.47 A.  
P.248

JOHN COTTON  
254|242  
36.11 A.  
P.120

HENRY DAVIS  
118|513  
22.07 A.  
P.123

AUGUSTUS BOWMAN  
117|67  
61.5 A  
P.118

ALBERT A. SCHULZE, ETAL.  
362|695  
78.91 A.  
P.213

JAMES C. BERGER.  
547|669  
15.00 A.  
P.284

D. E. BOONE  
684|757  
10.85 A  
P.34

THOMAS F. OLES  
586|432  
16.57 A.  
P.146

BASE MAP CONSTRUCTED:  
FROM 1945 QUAD  
PLANIMETRY REV. TO:  
MAP DRAWN: 4-18-74

Attachment I  
HO-118  
The Albert Schulze Post and Plank Bldg.  
Tax Map 7

767

770



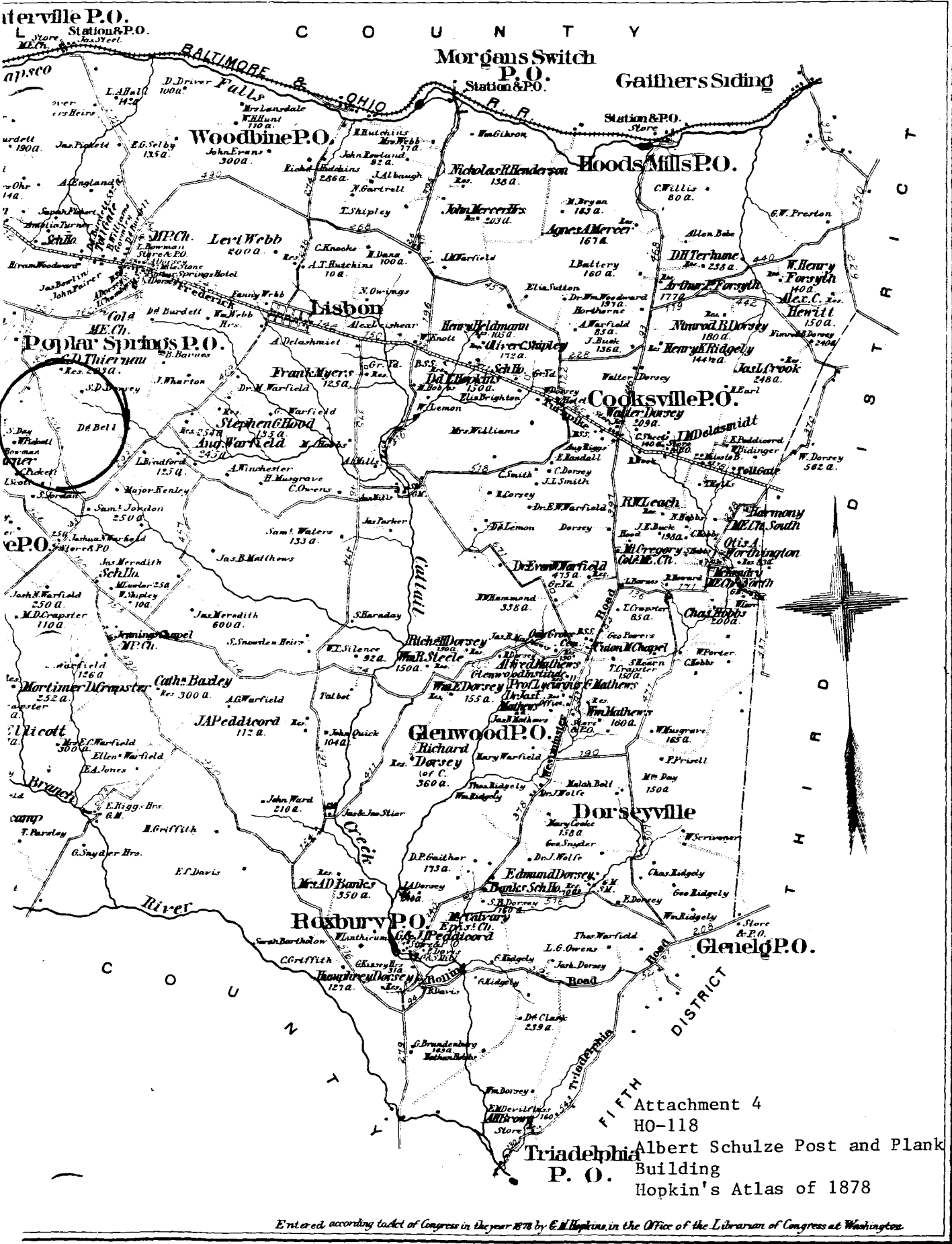

Attachment 2  
HO-118  
Albert Schulze Post and Plank Bldg.  
U.S. Geological Survey Maps  
Damascus, Maryland and Woodbine  
Maryland Quadrangles

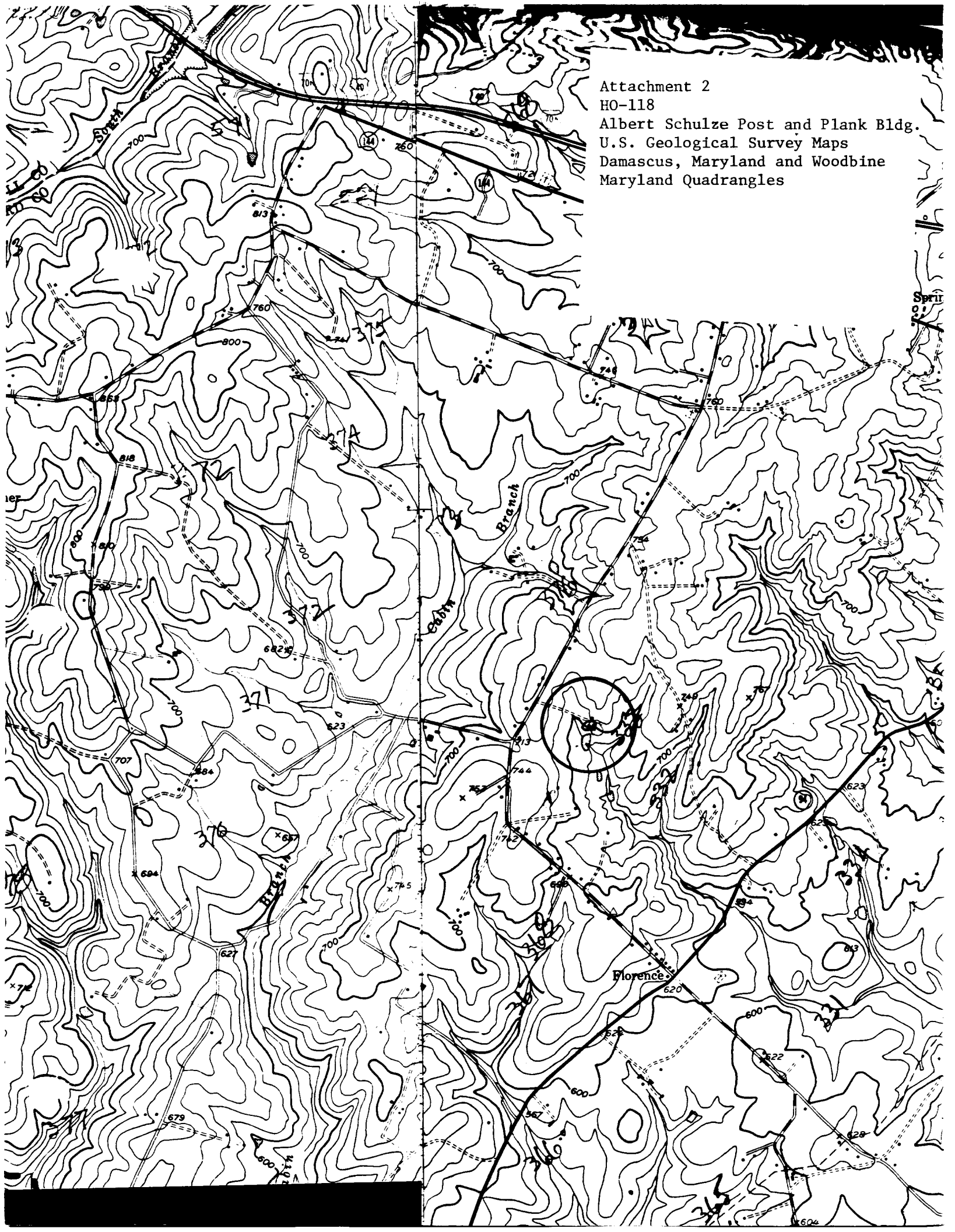



HO-118

~~HO-102~~

~~Sarah Jane Powell~~  
~~Log Cabin~~  
**7754**

JSE May 72

(Albert Schultze' log house)



Ho-118  
Albert Schulze Post & Plank  
North Bldg

May - 1979  
CB Thompson ACE