

HA-384

## Lebanon (Reece-Silver House, Seven Springs Farm)

### **Architectural Survey File**

This is the architectural survey file for this MIHP record. The survey file is organized reverse-chronological (that is, with the latest material on top). It contains all MIHP inventory forms, National Register nomination forms, determinations of eligibility (DOE) forms, and accompanying documentation such as photographs and maps.

Users should be aware that additional undigitized material about this property may be found in on-site architectural reports, copies of HABS/HAER or other documentation, drawings, and the “vertical files” at the MHT Library in Crownsville. The vertical files may include newspaper clippings, field notes, draft versions of forms and architectural reports, photographs, maps, and drawings. Researchers who need a thorough understanding of this property should plan to visit the MHT Library as part of their research project; look at the MHT web site ([mht.maryland.gov](http://mht.maryland.gov)) for details about how to make an appointment.

All material is property of the Maryland Historical Trust.

***Last Updated: 02-18-2004***

HA-384

Jeremiah P. Silver House; Lebanon                      1853-57  
337 Fox Road  
Havre de Grace vicinity  
Private

The Jeremiah P. Silver House or "Lebanon" is a fine example of mid-19th century stonemasonry and is one of a group of stone houses built by the Silver family during the 1850's, all of which display the high quality workmanship and well-planned agricultural complexes which characterized the Silver farms.

HA-384

Jeremiah P. Silver House; Lebanon

The following corrections were supplied by Mrs. William B. Reese on March 18, 1983:

4. William S. Reese; Catherine R. Huber; Barbara R. Currie (joint owners)  
(note correct spelling of Reese)  
William S. Reese address: 409 Temple St., New Haven, CT 06512
  
7. The roof was originally slate, but is now asphalt shingles.  
The datestone reads "1853", the starting date of the house.  
The frame addition has wood siding.  
The corn crib or corn house still exists, standing about 150 feet east of the house. It is a two story structure and has a shed addition on one side and a garage on the other.
  
8. Mrs. Reese referred to a perpetual calendar while checking the dates mentioned in Jeremiah Silver's diaries. The plasterers began work on the house on 26 June 1854. The family moved into the new house in April 1855. The survey for the railroad line from Stafford up Elbow Branch was begun 17 July 1856.

## INVENTORY FORM FOR STATE HISTORIC SITES SURVEY

**1 NAME**

HISTORIC Jeremiah P. Silver House; Lebanon

AND/OR COMMON  
Seven Springs Farm**2 LOCATION**STREET & NUMBER  
337 Fox RoadCITY, TOWN  
Havre de Grace  VICINITY OFCONGRESSIONAL DISTRICT  
1stSTATE  
Maryland, 21078COUNTY  
Harford**3 CLASSIFICATION**

CATEGORY	OWNERSHIP	STATUS	PRESENT USE
<input type="checkbox"/> DISTRICT	<input type="checkbox"/> PUBLIC	<input checked="" type="checkbox"/> OCCUPIED	<input type="checkbox"/> AGRICULTURE <input type="checkbox"/> MUSEUM
<input checked="" type="checkbox"/> BUILDING(S)	<input checked="" type="checkbox"/> PRIVATE	<input type="checkbox"/> UNOCCUPIED	<input type="checkbox"/> COMMERCIAL <input type="checkbox"/> PARK
<input type="checkbox"/> STRUCTURE	<input type="checkbox"/> BOTH	<input type="checkbox"/> WORK IN PROGRESS	<input type="checkbox"/> EDUCATIONAL <input checked="" type="checkbox"/> PRIVATE RESIDENCE
<input type="checkbox"/> SITE	<b>PUBLIC ACQUISITION</b>	<b>ACCESSIBLE</b>	<input type="checkbox"/> ENTERTAINMENT <input type="checkbox"/> RELIGIOUS
<input type="checkbox"/> OBJECT	<input type="checkbox"/> IN PROCESS	<input checked="" type="checkbox"/> YES RESTRICTED	<input type="checkbox"/> GOVERNMENT <input type="checkbox"/> SCIENTIFIC
	<input type="checkbox"/> BEING CONSIDERED	<input type="checkbox"/> YES UNRESTRICTED	<input type="checkbox"/> INDUSTRIAL <input type="checkbox"/> TRANSPORTATION
	not applicable	<input type="checkbox"/> NO	<input type="checkbox"/> MILITARY <input type="checkbox"/> OTHER

**4 OWNER OF PROPERTY**NAME  
William B. Reece

Telephone #: 734-6022

STREET & NUMBER  
337 Fox RoadCITY, TOWN  
Havre de Grace  VICINITY OFSTATE, zip code  
Maryland 21078**5 LOCATION OF LEGAL DESCRIPTION**COURTHOUSE,  
REGISTRY OF DEEDS, ETC Harford County Courthouse

Liber #:

Folio #:

STREET & NUMBER  
40 South Main StreetCITY, TOWN  
Bel AirSTATE  
Maryland**6 REPRESENTATION IN EXISTING SURVEYS**TITLE  
Maryland Historical Trust Historic Sites InventoryDATE  
c. 1970  FEDERAL  STATE  COUNTY  LOCALDEPOSITORY FOR  
SURVEY RECORDS Maryland Historical TrustCITY, TOWN  
AnnapolisSTATE  
Maryland

**7 DESCRIPTION**

NA-354

<b>CONDITION</b>		<b>CHECK ONE</b>	<b>CHECK ONE</b>
<input checked="" type="checkbox"/> EXCELLENT	<input type="checkbox"/> DETERIORATED	<input type="checkbox"/> UNALTERED	<input checked="" type="checkbox"/> ORIGINAL SITE
<input type="checkbox"/> GOOD	<input type="checkbox"/> RUINS	<input checked="" type="checkbox"/> ALTERED	<input type="checkbox"/> MOVED    DATE _____
<input type="checkbox"/> FAIR	<input type="checkbox"/> UNEXPOSED		

**DESCRIBE THE PRESENT AND ORIGINAL (IF KNOWN) PHYSICAL APPEARANCE**

The Jeremiah P. Silver House is a 2½ story stone house with a stone rear wing and frame addition, a one-story front porch and modillion cornice located on the south side of Fox Road near the intersection of Wilkinson Road about 1/4 mile east of MD. Rt. 161 in Harford County, Maryland. The house was built 1853-1857 and faces north.

The main section and stone rear wing are coursed fieldstone. The main elevation facing north has five bays with the shed roofed porch over the central three bays. The porch has four Tuscan columns. Three dormers break the slate roof on the north elevation. The gable ends of the main section have different bay configurations, the east having three bays, the central dominant, and the west gable having a single bay with paired windows. The attic level on the east gable end has a half-round window over which is a stone inscribed "1857 JPS." The four interior end chimneys are brick above the roof and are capped with terra cotta pots.

The stone wing has two stories and a side entrance on the east. The 1956 frame addition is attached to the south end of the wing and is covered in aluminum siding. The fenestration is six over six in the stone sections and the windows are flanked by louvred shutters except in the frame addition.

Jeremiah Silver's diaries for 1856-57 refer to the cost of building a corn house, log meat house and carriage house, and in the summer of 1860 to a spring house being completed. These outbuildings were not observed during the survey and may be demolished or greatly altered. The present barn is a 20th century replacement of the original structure.

**CONTINUE ON SEPARATE SHEET IF NECESSARY**

PERIOD	AREAS OF SIGNIFICANCE -- CHECK AND JUSTIFY BELOW			
PREHISTORIC	<input type="checkbox"/> ARCHEOLOGY-PREHISTORIC	<input type="checkbox"/> COMMUNITY PLANNING	<input type="checkbox"/> LANDSCAPE ARCHITECTURE	<input type="checkbox"/> RELIGION
<input type="checkbox"/> 1400-1499	<input type="checkbox"/> ARCHEOLOGY-HISTORIC	<input type="checkbox"/> CONSERVATION	<input type="checkbox"/> LAW	<input type="checkbox"/> SCIENCE
<input type="checkbox"/> 1500-1599	<input type="checkbox"/> AGRICULTURE	<input type="checkbox"/> ECONOMICS	<input type="checkbox"/> LITERATURE	<input type="checkbox"/> SCULPTURE
<input type="checkbox"/> 1600-1699	<input checked="" type="checkbox"/> ARCHITECTURE	<input type="checkbox"/> EDUCATION	<input type="checkbox"/> MILITARY	<input type="checkbox"/> SOCIAL/HUMANITARIAN
<input type="checkbox"/> 1700-1799	<input type="checkbox"/> ART	<input type="checkbox"/> ENGINEERING	<input type="checkbox"/> MUSIC	<input type="checkbox"/> THEATER
<input checked="" type="checkbox"/> 1800-1899	<input type="checkbox"/> COMMERCE	<input type="checkbox"/> EXPLORATION/SETTLEMENT	<input type="checkbox"/> PHILOSOPHY	<input type="checkbox"/> TRANSPORTATION
<input type="checkbox"/> 1900-	<input type="checkbox"/> COMMUNICATIONS	<input type="checkbox"/> INDUSTRY	<input type="checkbox"/> POLITICS/GOVERNMENT	<input checked="" type="checkbox"/> OTHER (SPECIFY) local history
		<input type="checkbox"/> INVENTION		

SPECIFIC DATES 1853-57

BUILDER/ARCHITECT Mr. Reasin

**STATEMENT OF SIGNIFICANCE**

The Jeremiah P. Silver House or "Lebanon" is a fine example of mid-19th century stonemasonry and is one of a group of stone houses built by the Silver family during the 1850's, all of which display the high quality workmanship and well-planned agricultural complexes which characterized the Silver farms.

HISTORY AND SUPPORT

Jeremiah P. Silver (1826-1897) was the brother of Benjamin Silver, Jr. and Silas B. Silver, whose stone houses on Harmony Church Road west of Darlington Road form the western edge of the Silver house group. A third house on Darlington Road is the William F. Silver House. The houses were built over the early and mid-19th century centered on the John A. Silver House, "Vignon," which could be seen from Lebanon to the north. Vignon was burned in 1902.

The attached copies from Our Silver Heritage by Benjamin S. Silver (1976) contain excerpts from Jeremiah Silver's diaries concerning the construction of Lebanon. The architect for the house was a Mr. Reasin, who also designed the exterior of Silas B. Silver's house, Silverton. Over the summer of 1860, Jeremiah refers to the construction of a spring house at Lebanon, built mainly by Joshua and Amos Stephens. In January 1866, John Bancroft put in a slate mantel and grate in the dining room, for which he was paid \$15. In December 1874, John Bartsches of the John Turnbull, Jr. Co. came to Lebanon to measure the parlor floors for a body brussels carpet. In November 1877, Jeremiah installed a coal stove in the sitting room. It is interesting to note that the franklin stove Jeremiah bought from Sarah Bayless in March 1856 caused a fire at Lebanon on December 14, 1859. The damage was apparently not serious.

Lebanon and Silverton are the most Italianate of the Silver houses, undoubtedly because of the architect's work. Lebanon is similar in design to the Benjamin Silver, Jr., House, but is somewhat more balanced in proportions and complete in exterior details, for example, the modillion cornice and triple dormers which give a more finished look.

**CONTINUE ON SEPARATE SHEET IF NECESSARY**

**9 MAJOR BIBLIOGRAPHICAL REFERENCES**

Silver, B. S. Our Silver Heritage, Gatesville Publishing Co.,  
Gatesville, TX, 1976. (Historical Society of Harford County Archives)  
Martenet's Map of Harford County, 1878

CONTINUE ON SEPARATE SHEET IF NECESSARY

**10 GEOGRAPHICAL DATA**

ACREAGE OF NOMINATED PROPERTY \_\_\_\_\_

VERBAL BOUNDARY DESCRIPTION

LIST ALL STATES AND COUNTIES FOR PROPERTIES OVERLAPPING STATE OR COUNTY BOUNDARIES

STATE COUNTY

STATE COUNTY

**11 FORM PREPARED BY**

NAME / TITLE

Janet L. Davis, Historic Sites Surveyor

ORGANIZATION

Harford County Department of Planning & Zoning

DATE

November 1982

STREET & NUMBER

45 South Main Street

TELEPHONE

838-6000 Ext 207

CITY OR TOWN

Bel Air

STATE

Maryland 21014

The Maryland Historic Sites Inventory was officially created by an Act of the Maryland Legislature, to be found in the Annotated Code of Maryland, Article 41, Section 181 KA, 1974 Supplement.

The Survey and Inventory are being prepared for information and record purposes only and do not constitute any infringement of individual property rights.

RETURN TO: Maryland Historical Trust  
The Shaw House, 21 State Circle  
Annapolis, Maryland 21401  
(301) 267-1438

CHAPTER VI

Section 3

Sub-Section 7

JEREMIAH SILVER of Benjamin and Charity (Warnock) Silver

Although Dr. Silas Benjamin Silver does not provide us with a description of his youngest brother, Jeremiah, we are indeed fortunate that Jeremiah maintained a diary from the year 1853 until a month before his death in 1897. Like his brother, Benjamin, Jeremiah was a man of diverse talents. A good farmer -- a surveyor -- a director in the Mutual Fire Insurance Company in Harford County from 3 January 1853 -- an active participant in local, county, state and national affairs -- an elder in the Presbyterian Church -- a clock fancier.

His early education was received in the same school system as his brothers, however, there is no information which indicates he attended college. On 24 June 1851 he purchased his farm, Lebanon, from the other members of the family. See deed of transfer at end of this sub-section and on 1 January 1852, at the age of 26, he married Mary Eliza Hoopman, the only child of Peter and Mary Cooper (Stump) Hoopman. Subsequent to his marriage he began to build his house at Lebanon early in 1853. The first year's diary, 1853, devotes itself for the most part to the details of the construction of his home. All the information in this portion is taken verbatim from his diary entries. Like his brother Benjamin they are filled with specific details concerning his farming operations.

Henry Hemore began hauling stone from the quarry for Jeremiah's home on 5 January 1853. Walnut logs (492 feet) were cut and brought from Poplar Point on 10 January 1853. Quarrying for stone for the home began in earnest on 11 January. Most of the quarrying was done by Ely Turner at a rate of "28¢ per perch" mason measurement. Jeremiah furnished the augurs, sledges, crowbars and powder. Marietta and Mehaffe agreed to supply lumber on 28 January at the following rates: 1st common \$25.00, second \$15.00, culling \$11.00, grubbing \$9.00, sawed material \$12.00. The specifications for the house at Lebanon can be found at the end of this sub-section. The architect for the house was Mr. Reasin "who agreed to furnish a plan for the house with front and side elevations and front portichs for \$25.00. On 30 April Sunday Jeremiah records that the "height of the foundation of the house from the spring 74 feet -- distance in straight line 600 feet -- required fall for water 10 feet ram #3 for \$23.00 -- feeding pipe 1 1/4 large 45 x 40 c ft -- pipe from spring to house 1/2 in at 7¢ a foot." On 22 April Friday Jeremiah "engaged a boat to carry lumber bought of Meade and Company down to Rock Run for \$1.50 per thousand. 38,562 feet in all = \$593.13. Paid Capt. Hauseal for freight on 41,000 feet lumber at 1.50 per thousand (28 April) \$61.50. By 16 June 1853, 223 wagon loads of stone for the house had been hauled to the construction site. On 13 July Jeremiah records "James Robinson agrees to put up the stone work of my house for 45¢ per perch and tend himself, by my paying \$5.00 for two arches that is to be put up and \$3.00 towards the expenses of bringing his men down here from home I am to board them all and pay \$8.00 extra on the whole job." On 30 September Jeremiah went after slate for the house "5 1/2 tons 16 x 8, 1 ton 11 x 22, 3 1/2 tons 6 x 12." Between the 4th and 6th of October inclusive Jeremiah drilled 12 acres of wheat at 1 5/8 bushel per acre. By 9 October the stone masons "left for home on Saturday at 3 o'clock -- finished the house Friday about noon. On 16 October J. H. Mitchell agreed to furnish all the paint for my house all at .80¢ per gallon, white lead at \$10.00 per hundred. 27 November I ordered 600 feet of glass from F. R. Williams \$45.75 total." The total cost of quarrying the stone for the house was \$34.75 and was paid in full to Ely Turner for his work on 3 January 1854. On 8 March Jeremiah recorded that "Wellmore Hopkins began to work at my house at 1.44 per day and board himself until 15 March after that he is to have \$1.70. 24 April Monday, Archer Scarborough commenced work today -- .42¢ and boards with James Small at .37 1/2 per

Silver B.S

Our Silver Heritage, 1976

day."

The plasters began work on the house 26 June and by Friday 30 June one coat had been applied. Samuel Harwood helped with this job and on Friday 18 August the plasterers had completed the job at a total cost of \$160.00.

On 27 December Wednesday Jeremiah records that "sold J. B. Conner mail route no. 9309 for \$237.00 from 1 October 1854 to 1 July 1856. Peter Finefrock has post route no. 9208 Christiana to Buck; George Court has no. 9226 Westchester to Wilmington; J. B. Conner has 9309 Hopewell C. W. to Newark; J. Stephens to Hopewell cotton works."

Diary entries for 1855 until the early 1860's were general in nature and covered a myriad of subjects. They are quoted below without comment. "5 February Monday, this day sold Amos Osborn and William H. Michael all the wood and timber on the east side of Swan Creek belonging to J. P. Silver and wife for the sum of \$925.00. 2 April Monday, paid Bill one day helping us to move up to new house. 12 April Thursday, commenced plowing. 8 June Friday, this day agreed with Capt. Jesse Irwin for enough sand from out of the bank at Poplar Point for the bridge at Havre de Grace (or for a bank 90' long up the shore and back at 11¢ per square yard to a line shown John Jackson). 11 June Monday, cash paid William Silver per John for 500 smoke fish (\$6.25). 11 October Thursday, sold L. W. Levering and Son per William Wiles 350 bushels of corn for E. C. Boyd yesterday at .80¢ per bushel. 17 November Saturday, Nathan Grafton left a sausage cutter with us for which if it performs well we are to pay \$5.00. If not to be returned. 24 September, J. P. Silver drilled in 19 3/4 bushels wheat on 10 1/4 acres in old field near the house. 27 September, Henry Hemore drilled in 11 1/2 bushels on about 6 acres in field above the house he lives in. 14 January 1856, I went over to Poplar Point on the ice with sleigh and two horses. 18 March 1856, John Duffy began to work at 1 P.M. he is to have 16¢ per barrel for husking corn and is to help loft it and 50¢ per day for other work. 19 March 1856, went to Sarah Bayless sale and bought one franklin stove, one eight-day clock which belonged to her grandfather and several small articles amounting to \$14.81, 1/4 for which I gave her my note for 6 months." It is believed by the author that the clock referred to here is the same as clock number 12 discussed on page 8581. During this year Randle Brannan, Henry Hemore and Bill James worked for Jeremiah Silver -- but back to Jeremiah's diary entries. "12 June Thursday, this day agreed with William H. Potts for carrying the mail on route 3025, said Potts is to carry it in such a manner as to be satisfactory to the Post Office Department for one year from 1 July 1856 for \$380.00 per year. 17 July Thursday, the Engineers commenced surveying the line for a railroad on Friday last from Stafford up the Elbow Branch. 26 August Tuesday, sold Mr. Wells of Aberdeen about 100 bushels of corn at .52¢ per bushel to be delivered by F. M. Brown next week. 8 October Wednesday, went to Philadelphia to National Agriculture Exhibition. 3 November Monday, John McCommons and Robert Plummer came to begin wall for corn house at 11 o'clock A.M. 29 November Saturday, sold my corn about 500 bushels to James Davis and Company per J. C. Parker to be delivered at Rock Run on next Wednesday and Thursday for .58¢ per bushel and about 12 bushels of wheat at \$1.48 per bushel. 5 December Friday, John hauling stuff from Paradise Mills for corn house. Cost of small meat house of logs \$35.00 -- cost of carriage house \$175.00. 14 February Saturday 1857, paid Mary Eliza Silver for Mrs. Brannan for quilting quilt \$1.00. 20 February Friday 1857, Paid Silas Warner for clean clock and clock bell \$1.25 (Clock No. 12. See page 8581). 5 June Friday, Tommy and John hauling sawed lumber from Paradise Mills for corn house. 17 June Wednesday, began moving corn into the corn house out of cellar. 29 August Saturday, a number of the neighbors met at Prospect Hill to locate a school house, adjourned to next Saturday 3 P.M. (Meeting did not take place due to illness). 8 November 1858, I went to Bel Air to attend court as a juror. 11 November 1858, I was called and empaneled as foreman of a jury in the case of the State vs. Andrew Thompson for the murder of Henry C. Fletcher (2nd degree murder). 13 November 1858, returned a verdict of murder in 2nd degree at 10 A.M. State vs. Andrew Thompson."

During 1859 and for several years thereafter, Jeremiah was monitoring the operations of five farms viz. Montesurado, Poplar Point, Shady Mount, Swan Creek and Lebanon -- a rather demanding job but back to his diaries. "31 October Monday 1859, Alexander Morris

JEREMIAH P. SILVER HOUSE

HA-384

CHAIN OF TITLE (PARTIAL)

1118/38	29 March 1980	Grantor: William B. & Katharine J. Reese Grantee: Katharine R. Huber, Barbara S. Reese William S. Reese \$185,000 for 233 acres, parts of "Neighbor's Good Will", "Cora Wood Grove", "Smith's Mistake", "Lion's Ghent", "Lyon's Additions", "West Flavor", "Grible Onions", now known as "Lebanon Farm".
340/426	29 March 1950	Grantor: Leon A. and Edna W. Fox Grantee: William B. & Katharine J. Reese
294/243	12 March 1946	Grantor: Maurice and Sara Klein Grantee: Leon A. Fox
267/499	16 September 1941	Grantor: E. Pamela Silver et al. Grantee: Maurice and Sara Klein " . . . being the same and all the land of which the said Jeremiah P. Silver . . . died seized and possessed . . . conveyed to the said Jeremiah P. Silver by the four following deeds: 1) from Samuel Harrowood & wife on 11 December 1873, 29/433; 2) from James Standiford & wife on 11 October 1861, 12/370; 3) from George W. F. Deaver on 5 August 1851, 37/318; 4) from Charity Silver, widow, et al. on 24 June 1851, 37/304.

N. P. FIELD SHEET  
1303844404

HA 384

NATIONAL REGISTER OF HISTORIC PLACES  
INVENTORY - NOMINATION FORM

(Type all entries - complete applicable sections)

STATE:	
COUNTY:	
FOR NPS USE ONLY	
ENTRY NUMBER	DATE

1. NAME

COMMON: Peece - Silver house

AND/OR HISTORIC:

2. LOCATION

STREET AND NUMBER: Southeast corner of Wilkinson Road and Fox Road

CITY OR TOWN: Darlington

STATE: Maryland CODE: COUNTY: Harford CODE:

3. CLASSIFICATION

CATEGORY (Check One)	OWNERSHIP	STATUS	ACCESSIBLE TO THE PUBLIC
District <input type="checkbox"/> Building <input checked="" type="checkbox"/>	Public <input type="checkbox"/>	Public Acquisition: <input type="checkbox"/>	Yes: <input type="checkbox"/>
Site <input type="checkbox"/> Structure <input checked="" type="checkbox"/>	Private <input checked="" type="checkbox"/>	In Process <input type="checkbox"/>	Restricted <input checked="" type="checkbox"/>
Object <input type="checkbox"/>	Both <input type="checkbox"/>	Being Considered <input type="checkbox"/>	Unrestricted <input type="checkbox"/>
		Occupied <input checked="" type="checkbox"/>	No: <input type="checkbox"/>
		Unoccupied <input type="checkbox"/>	
		Preservation work in progress <input type="checkbox"/>	

PRESENT USE (Check One or More as Appropriate)

Agricultural <input type="checkbox"/>	Government <input type="checkbox"/>	Park <input type="checkbox"/>	Transportation <input type="checkbox"/>	Comments <input type="checkbox"/>
Commercial <input type="checkbox"/>	Industrial <input type="checkbox"/>	Private Residence <input checked="" type="checkbox"/>	Other (Specify) <input type="checkbox"/>	
Educational <input type="checkbox"/>	Military <input type="checkbox"/>	Religious <input type="checkbox"/>		
Entertainment <input type="checkbox"/>	Museum <input type="checkbox"/>	Scientific <input type="checkbox"/>		

4. OWNER OF PROPERTY

OWNERS NAME: William & Katherine Peece

STREET AND NUMBER: Fox Road

CITY OR TOWN: Harve de Grace RFD STATE: Maryland CODE:

5. LOCATION OF LEGAL DESCRIPTION

COURTHOUSE, REGISTRY OF DEEDS, ETC.: CLERK OF THE CIRCUIT COURT

STREET AND NUMBER: HARFORD COUNTY COURTHOUSE 40 S. MAIN ST

CITY OR TOWN: BEL AIR STATE: MARYLAND CODE:

APPROXIMATE ACREAGE OF NOMINATED PROPERTY:

6. REPRESENTATION IN EXISTING SURVEYS

TITLE OF SURVEY:

DATE OF SURVEY: Federal  State  County  Local

DEPOSITORY FOR SURVEY RECORDS:

STREET AND NUMBER:

CITY OR TOWN: STATE: CODE:

SEE INSTRUCTIONS

STATE:

COUNTY:

FOR NPS USE ONLY  
ENTRY NUMBER  
DATE

## 7. DESCRIPTION

CONDITION	(Check One)					
	Excellent <input checked="" type="checkbox"/>	Good <input type="checkbox"/>	Fair <input type="checkbox"/>	Deteriorated <input type="checkbox"/>	Ruins <input type="checkbox"/>	Unexposed <input type="checkbox"/>
INTEGRITY	(Check One)			(Check One)		
	Altered <input type="checkbox"/>	Unaltered <input checked="" type="checkbox"/>	Unaltered <input type="checkbox"/>	Moved <input type="checkbox"/>	Original Site <input checked="" type="checkbox"/>	

DESCRIBE THE PRESENT AND ORIGINAL (If known) PHYSICAL APPEARANCE

This elegant stone masonry house is made of large stones dressed with skill. L shaped, 2 1/2 stories, over a high stone basement, the house is 5 bays by 4 with 3 bays x 2 in the stone ell and 2 x 2 in an extension, frame, of one large room over a three car garage with bedrooms over.

The roof ridge line runs north-south, the main house ~~is~~ with three peaked dormers, facing east. The carved cornice under the eaves is one of many elements of fine workmanship in this house. Chimney pots top the brick chimneys, two at each end of the house, rising from fireplaces upstairs and down. A half-round window in ~~the~~ gable ends has two quarter-round sashes. The datestone over this window

reads 1857  
JPS for Jeremiah P. Sizer. The

simpler, smaller-scale stone ell section may be considerably older.

SEE INSTRUCTIONS

8. SIGNIFICANCE

PERIOD (Check One or More as Appropriate)

- Pre-Columbian  16th Century  18th Century  20th Century   
 15th Century  17th Century  19th Century

SPECIFIC DATE(S) (If Applicable and Known)

AREAS OF SIGNIFICANCE (Check One or More as Appropriate)

- |   |                                       |  |  |
|---|---------------------------------------|--|--|
| Aboriginal <input type="checkbox"/>     | Education <input type="checkbox"/>    | Political <input type="checkbox"/>           | Urban Planning <input type="checkbox"/>  |
| Prehistoric <input type="checkbox"/>    | Engineering <input type="checkbox"/>  | Religion/Philosophy <input type="checkbox"/> | Other (Specify) <input type="checkbox"/> |
| Historic <input type="checkbox"/>       | Industry <input type="checkbox"/>     | Science <input type="checkbox"/>             | <u>Architecture</u>                      |
| Agriculture <input type="checkbox"/>    | Invention <input type="checkbox"/>    | Sculpture <input type="checkbox"/>           | _____                                    |
| Art <input type="checkbox"/>            | Landscape <input type="checkbox"/>    | Social/Humanitarian <input type="checkbox"/> | _____                                    |
| Commerce <input type="checkbox"/>       | Architecture <input type="checkbox"/> | Theater <input type="checkbox"/>             | _____                                    |
| Communications <input type="checkbox"/> | Literature <input type="checkbox"/>   | Transportation <input type="checkbox"/>      | _____                                    |
| Conservation <input type="checkbox"/>   | Military <input type="checkbox"/>     |  | _____                                    |
|   | Music <input type="checkbox"/>        |  | _____                                    |

STATEMENT OF SIGNIFICANCE (Include Personages, Dates, Events, Etc.)

This fine house is evidence of the prosperity of farming in the 19th century in this area.

Maintained and modernized by the retired General Fox after the second world war, and added to and restored by the Peccos who farm actively, but whose income is primarily non-farm.

SEE INSTRUCTIONS

9. MAJOR BIBLIOGRAPHICAL REFERENCES

*(This section is currently blank, containing only a faint diagonal line.)*

10. GEOGRAPHICAL DATA

LATITUDE AND LONGITUDE COORDINATES DEFINING A RECTANGLE LOCATING THE PROPERTY			O R	LATITUDE AND LONGITUDE COORDINATES DEFINING THE CENTER POINT OF A PROPERTY OF LESS THAN ONE ACRE		
CORNER	LATITUDE	LONGITUDE		LATITUDE	LONGITUDE	
	Degrees Minutes Seconds	Degrees Minutes Seconds		Degrees Minutes Seconds	Degrees Minutes Seconds	
NW	° ' "	° ' "		° ' "	° ' "	
NE	° ' "	° ' "		° ' "	° ' "	
SE	° ' "	° ' "		° ' "	° ' "	
SW	° ' "	° ' "		° ' "	° ' "	

LIST ALL STATES AND COUNTIES FOR PROPERTIES OVERLAPPING STATE OR COUNTY BOUNDARIES

STATE:	CODE	COUNTY	CODE
STATE:	CODE	COUNTY:	CODE
STATE:	CODE	COUNTY:	CODE
STATE:	CODE	COUNTY:	CODE

11. FORM PREPARED BY

NAME AND TITLE: **JEAN S. EWING**

ORGANIZATION: **MARYLAND HISTORICAL TRUST** DATE: \_\_\_\_\_

STREET AND NUMBER: **50 STATE CIRCLE**

CITY OR TOWN: **ANNAPOLIS** STATE: **MARYLAND** CODE: \_\_\_\_\_

12. STATE LIAISON OFFICER CERTIFICATION

NATIONAL REGISTER VERIFICATION

As the designated State Liaison Officer for the National Historic Preservation Act of 1966 (Public Law 89-665), I hereby nominate this property for inclusion in the National Register and certify that it has been evaluated according to the criteria and procedures set forth by the National Park Service. The recommended level of significance of this nomination is:

National  State  Local

Name \_\_\_\_\_

Title \_\_\_\_\_

Date \_\_\_\_\_

I hereby certify that this property is included in the National Register.

\_\_\_\_\_  
Chief, Office of Archeology and Historic Preservation

Date \_\_\_\_\_

ATTEST:

\_\_\_\_\_  
Keeper of The National Register

Date \_\_\_\_\_

SEE INSTRUCTIONS

HA-384

Jeremiah P. Silver House

ADDITION: Addresses of additional joint owners

Kathy Reese  
Rt. 1  
Dover, Arkansas 72837

Mrs. Barbara Reese Currie  
2033 Wroxton  
Houston, Texas 77005

Janet Davis  
December 13, 1983

JEREMIAH P. SILVER HOUSE  
"LEBANON"

HA-384 NOT TO SCALE

AUGUST 1983 JLD

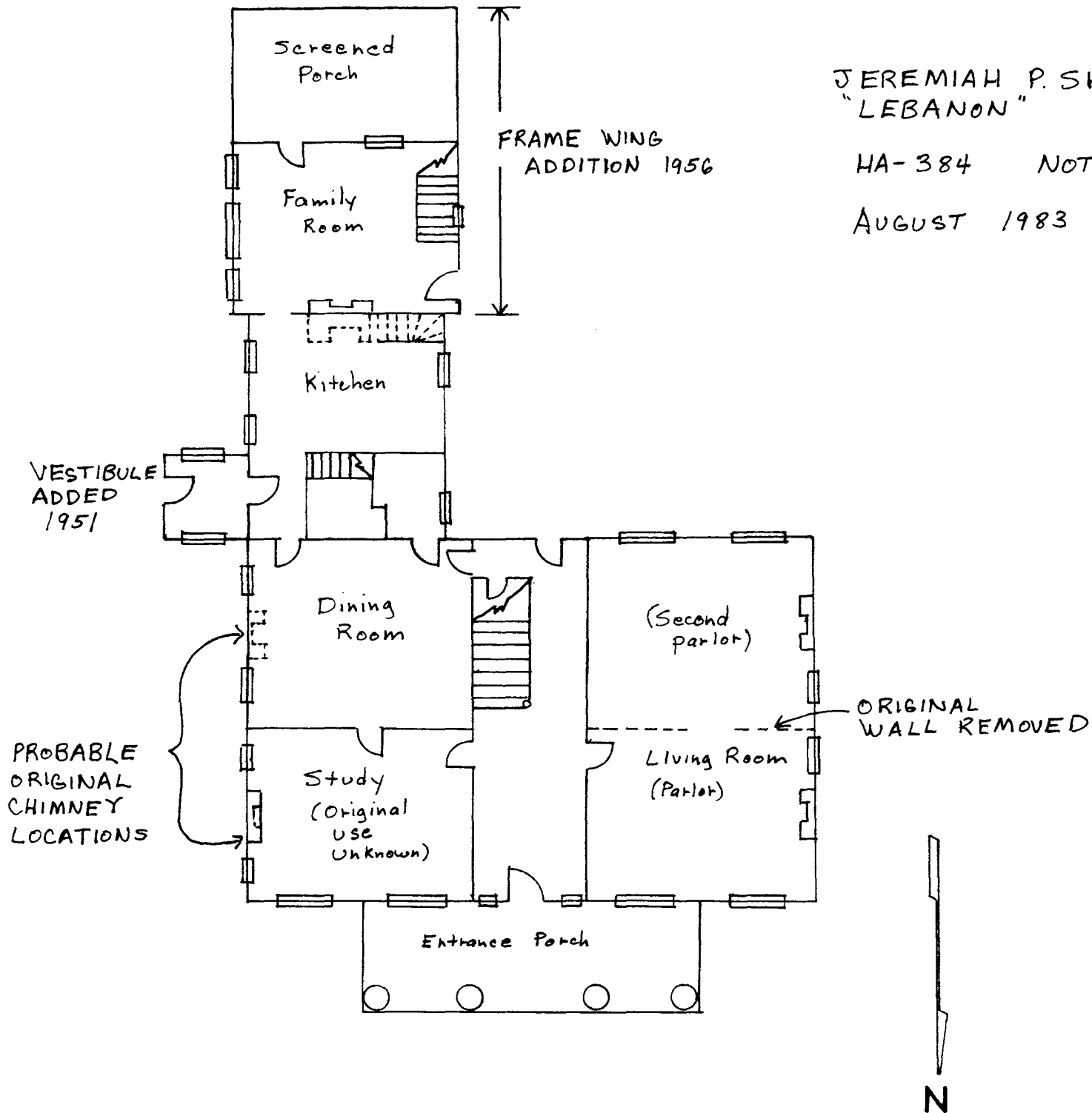

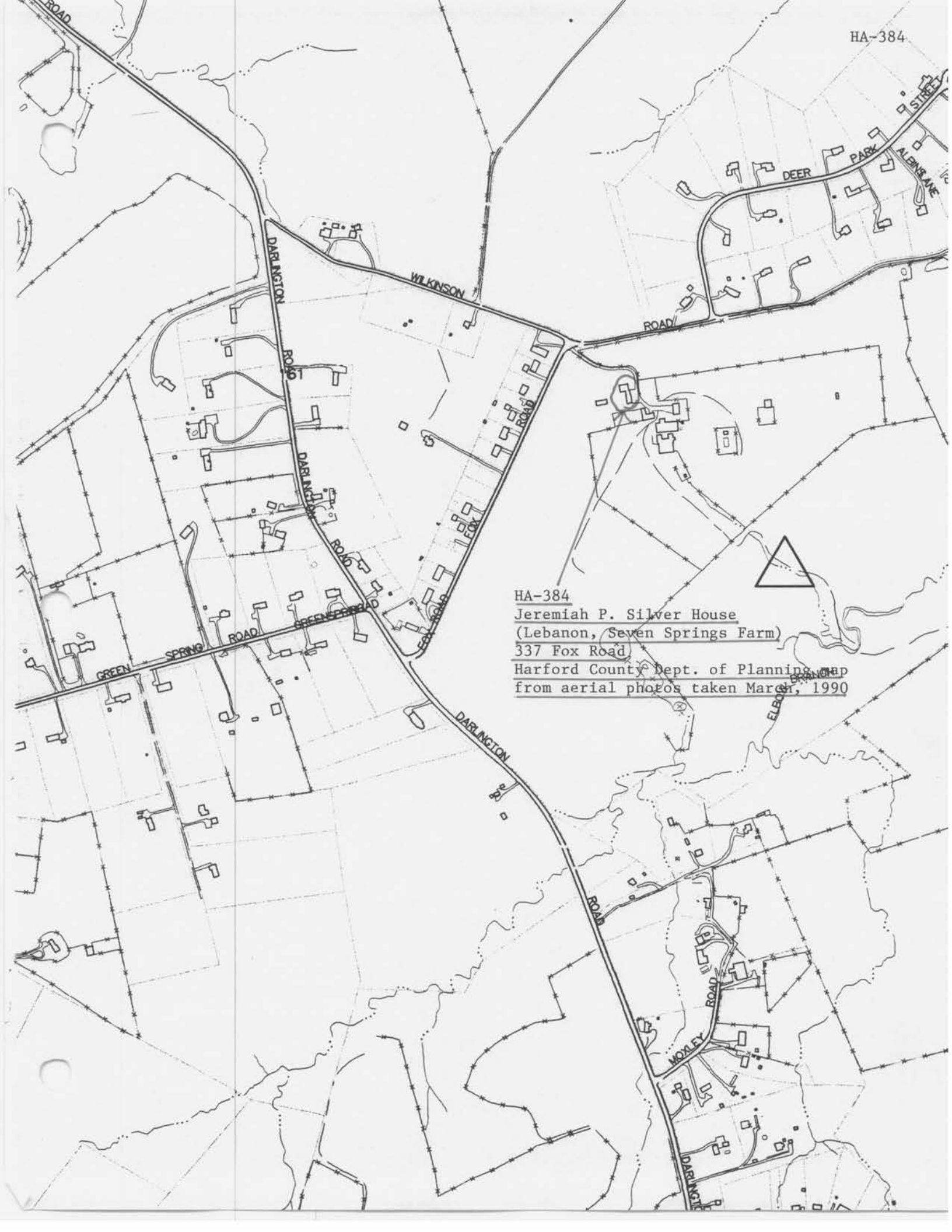

HA-384  
Jeremiah P. Silver House  
(Lebanon, Seven Springs Farm)  
337 Fox Road  
Harford County Dept. of Planning map  
from aerial photos taken March, 1990

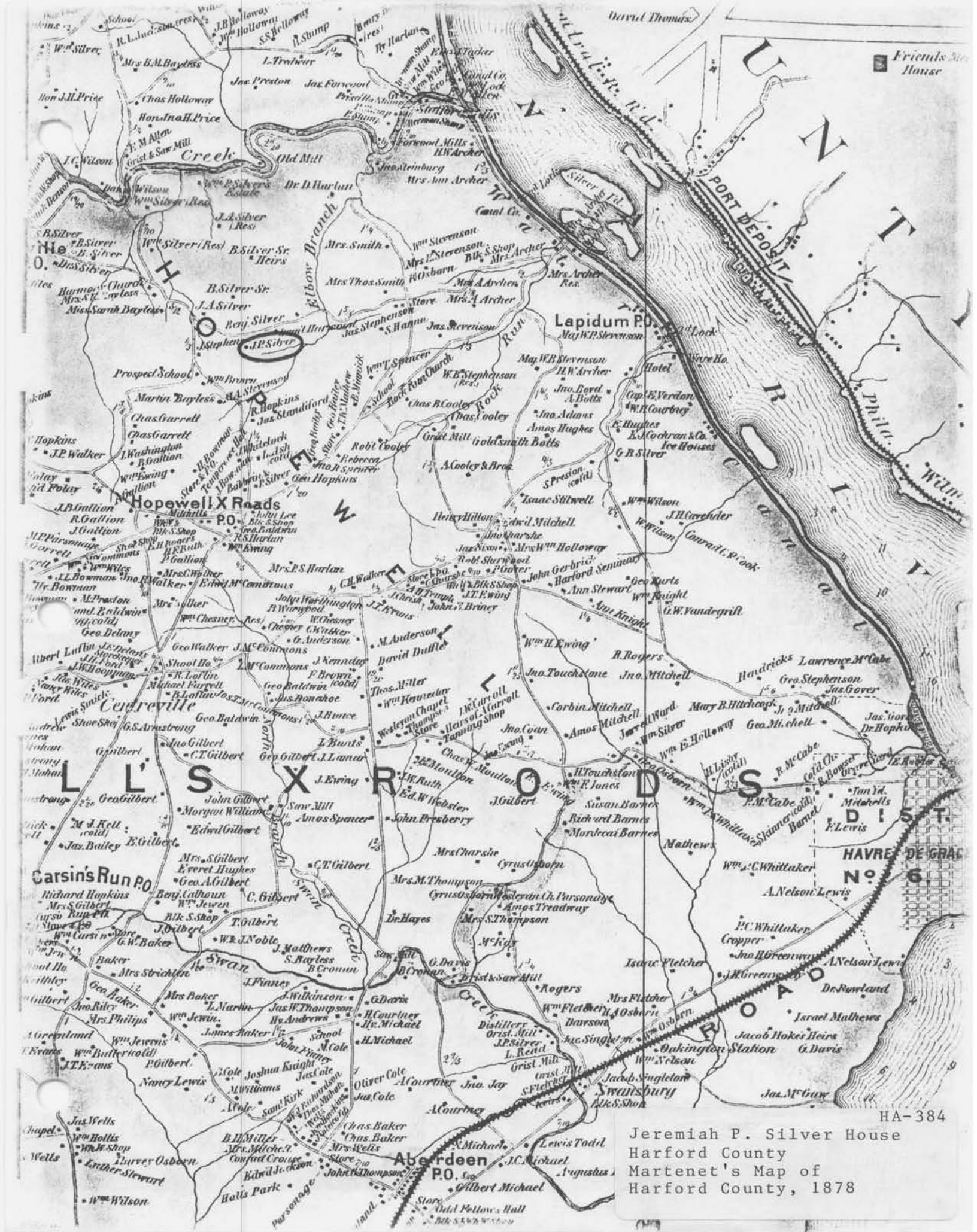

Friends House

U  
N  
T  
R  
I  
S  
T  
R  
I  
C  
T

Hopewell X Roads

Centreville

Carls Run P.O.

Aberdeen P.O.

HAVRE DE GRACE  
No. 6

Jeremiah P. Silver House  
Harford County  
Martenet's Map of  
Harford County, 1878

HA-384

96 12'30"

5763 11 NW  
(CONOWINGO DAM)

99

10' 400

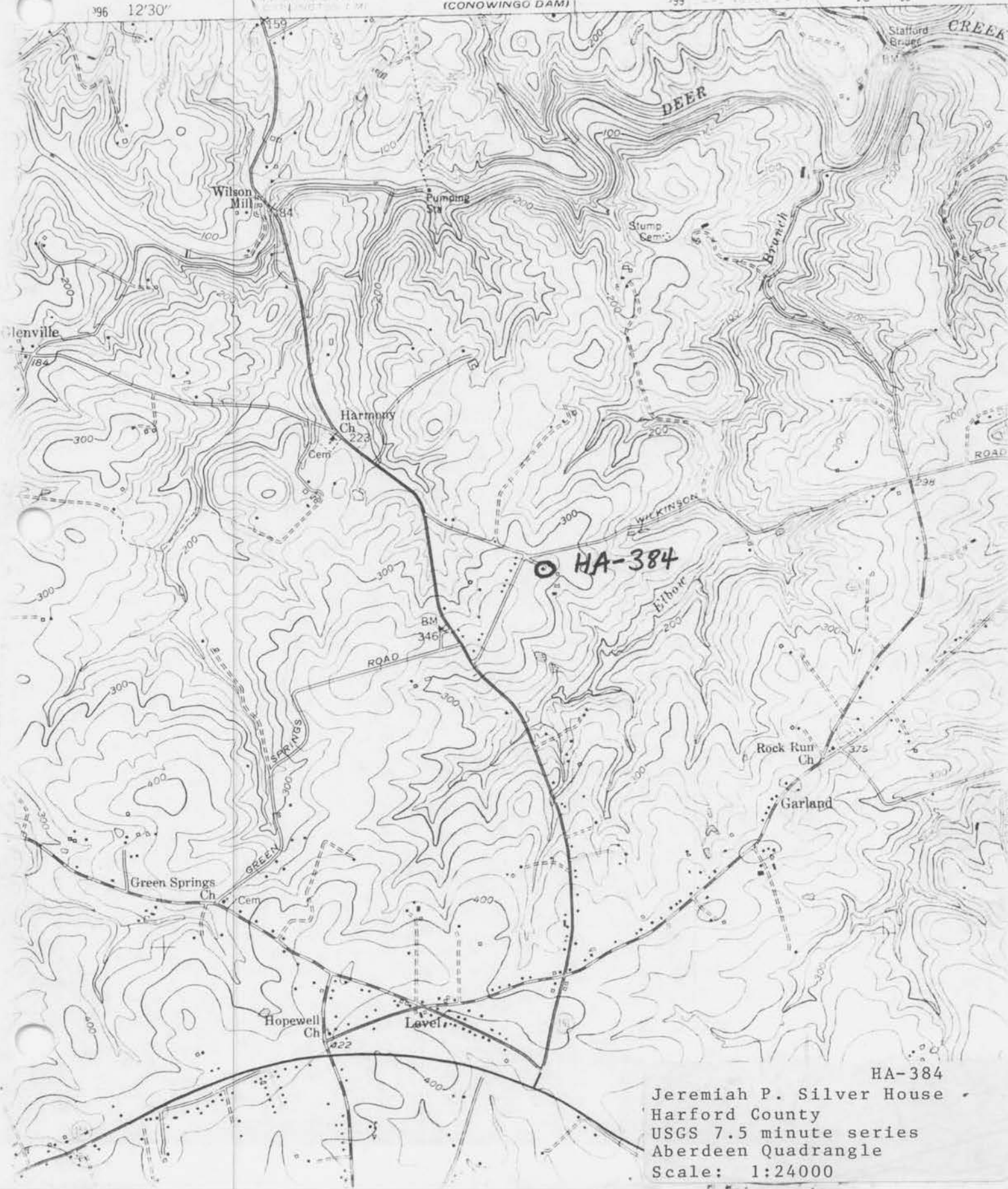

HA-384

HA-384

Jeremiah P. Silver House  
 Harford County  
 USGS 7.5 minute series  
 Aberdeen Quadrangle  
 Scale: 1:24000



Jeremiah P. Silver House      HA-384  
Harford County  
Photo: Janet Davis  
November 1982  
East elevation