

AL-VI-D-310

## South Westernport Historic District

### **Architectural Survey File**

This is the architectural survey file for this MIHP record. The survey file is organized reverse-chronological (that is, with the latest material on top). It contains all MIHP inventory forms, National Register nomination forms, determinations of eligibility (DOE) forms, and accompanying documentation such as photographs and maps.

Users should be aware that additional undigitized material about this property may be found in on-site architectural reports, copies of HABS/HAER or other documentation, drawings, and the “vertical files” at the MHT Library in Crownsville. The vertical files may include newspaper clippings, field notes, draft versions of forms and architectural reports, photographs, maps, and drawings. Researchers who need a thorough understanding of this property should plan to visit the MHT Library as part of their research project; look at the MHT web site ([mht.maryland.gov](http://mht.maryland.gov)) for details about how to make an appointment.

All material is property of the Maryland Historical Trust.

***Last Updated: 12-11-2003***

AL-VI-D-310

South Westernport Historic District  
Westernport  
Private

early 20th century

The south Westernport Historic District is located in Westernport, Maryland, a town of about 2715 people in the mountainous southwestern end of Allegany County.

In 1918, the West Virginia Pulp and Paper Company purchased several acres of Potomac River flood plain land in Westernport from the Westernport Real Estate and Improvement Company. Between 1920 and 1922 the company constructed 72 rowhouse dwellings on Maryland Avenue of South Westernport. The brick rowhouses are an unusual form of company housing in western Maryland.

MARYLAND HISTORICAL TRUST

AL-VI-D-310  
MAGI #0112874738

INVENTORY FORM FOR STATE HISTORIC SITES SURVEY NRD

**1 NAME**

HISTORIC

AND/OR COMMON

South Westernport Historic District

**2 LOCATION**

STREET & NUMBER

CITY, TOWN

Westernport

\_\_\_ VICINITY OF

CONGRESSIONAL DISTRICT

6th

STATE

Maryland

COUNTY

Allegany County

**3 CLASSIFICATION**

CATEGORY	OWNERSHIP	STATUS	PRESENT USE	
<input checked="" type="checkbox"/> DISTRICT	<input type="checkbox"/> PUBLIC	<input checked="" type="checkbox"/> OCCUPIED	<input type="checkbox"/> AGRICULTURE	<input type="checkbox"/> MUSEUM
<input type="checkbox"/> BUILDING(S)	<input checked="" type="checkbox"/> PRIVATE	<input type="checkbox"/> UNOCCUPIED	<input type="checkbox"/> COMMERCIAL	<input type="checkbox"/> PARK
<input type="checkbox"/> STRUCTURE	<input type="checkbox"/> BOTH	<input type="checkbox"/> WORK IN PROGRESS	<input type="checkbox"/> EDUCATIONAL	<input checked="" type="checkbox"/> PRIVATE RESIDENCE
<input type="checkbox"/> SITE	<b>PUBLIC ACQUISITION</b>	<b>ACCESSIBLE</b>	<input type="checkbox"/> ENTERTAINMENT	<input type="checkbox"/> RELIGIOUS
<input type="checkbox"/> OBJECT	<input type="checkbox"/> IN PROCESS	<input checked="" type="checkbox"/> YES: RESTRICTED	<input type="checkbox"/> GOVERNMENT	<input type="checkbox"/> SCIENTIFIC
	<input type="checkbox"/> BEING CONSIDERED	<input type="checkbox"/> YES: UNRESTRICTED	<input type="checkbox"/> INDUSTRIAL	<input type="checkbox"/> TRANSPORTATION
		<input type="checkbox"/> NO	<input type="checkbox"/> MILITARY	<input type="checkbox"/> OTHER

**4 OWNER OF PROPERTY**

NAME

Telephone #:

STREET & NUMBER

CITY, TOWN

\_\_\_ VICINITY OF

STATE, zip code

**5 LOCATION OF LEGAL DESCRIPTION**

COURTHOUSE,  
REGISTRY OF DEEDS, ETC

Allegany County Courthouse

Liber #:

Folio #:

STREET & NUMBER

30 Washington Street

CITY, TOWN

Cumberland

STATE

Maryland 21502

**6 REPRESENTATION IN EXISTING SURVEYS**

TITLE

None

DATE

\_\_\_ FEDERAL \_\_\_ STATE \_\_\_ COUNTY \_\_\_ LOCAL

DEPOSITORY FOR  
SURVEY RECORDS

CITY, TOWN

STATE

# 7 DESCRIPTION

AL-VI-D-310

<b>CONDITION</b>		<b>CHECK ONE</b>		<b>CHECK ONE</b>	
<input type="checkbox"/> EXCELLENT	<input type="checkbox"/> DETERIORATED	<input checked="" type="checkbox"/> UNALTERED	<input checked="" type="checkbox"/> ORIGINAL SITE	<input type="checkbox"/> MOVED	DATE _____
<input checked="" type="checkbox"/> GOOD	<input type="checkbox"/> RUINS	<input checked="" type="checkbox"/> ALTERED			
<input type="checkbox"/> FAIR	<input type="checkbox"/> UNEXPOSED				

## DESCRIBE THE PRESENT AND ORIGINAL (IF KNOWN) PHYSICAL APPEARANCE

The South Westernport Historic District is located in Westernport, Maryland, a town of about 2725 people in the mountainous southwestern end of Allegany County. The district, located approximately 22 miles southwest of Cumberland, is located on flat land adjacent to the Potomac River. It consists of three blocks of rowhouses on both side of Maryland Avenue which runs NW and SE through the center of the district. Second and Third Streets, which intersect Maryland Avenue, divide the district into 3 blocks in a grid plan.

The 300 block of the district between First and Second Streets, contains two rows of 15 dwellings each. The rowhouses are 2 stories tall, 3 bays wide and 4 bays deep on the ends. They rest on cement foundations and have walls of brown bricks laid in stretcher bond. The shed roofs of the rowhouses have stepped parapets. A projecting two story bay window is located on the facade of each dwelling. A continuous shed roofed porch supported by brick posts shelters the facade of each row. Windows are 6/1 sash with flat brick arches

The 400 block of South Westernport consists of two rows of 12 houses each designed in a mock Tudor period style. The rowhouses are symmetrically arranged in an alternating pattern of single or paired, gabled and shed-roofed dwellings. The rowhouses are 2½ stories tall, 3 bays wide and 3 bays deep on the ends. They rest on cement foundations and have walls, probably of building tiles, sheathed in cement. The shed roofed dwellings and gable roofed dwellings on the end of each row have hipped dormers. Shed roofed and gabled porticos have paired square wooden posts. Windows are 4/1 and 6/1 sash in groups of three on the 2nd floor facade and paired 6 light casement windows on the attic level of the gable roofed houses.

The 500 block of South Westernport consists of two rows of 9 apartments each. Stylistically the 500 block is much the same as the 300 block, the main difference being the two tiered brick porches of the 500 block. Entrances to 2nd story apartments are located between the porches of the ground floor apartments, the tops of which are balconies for 2nd story apartments.

### Boundary Description

The boundaries of the South Westernport Historic District are indicated by the dotted solid line on the attached map. The borders of the district consist of the property lines of the unnamed alleys indicated.

CONTINUE ON SEPARATE SHEET IF NECESSARY

**8 SIGNIFICANCE**

PERIOD		AREAS OF SIGNIFICANCE -- CHECK AND JUSTIFY BELOW			
<input type="checkbox"/> PREHISTORIC	<input type="checkbox"/> ARCHEOLOGY-PREHISTORIC	<input type="checkbox"/> COMMUNITY PLANNING	<input type="checkbox"/> LANDSCAPE ARCHITECTURE	<input type="checkbox"/> RELIGION	
<input type="checkbox"/> 1400-1499	<input type="checkbox"/> ARCHEOLOGY-HISTORIC	<input type="checkbox"/> CONSERVATION	<input type="checkbox"/> LAW	<input type="checkbox"/> SCIENCE	
<input type="checkbox"/> 1500-1599	<input type="checkbox"/> AGRICULTURE	<input type="checkbox"/> ECONOMICS	<input type="checkbox"/> LITERATURE	<input type="checkbox"/> SCULPTURE	
<input type="checkbox"/> 1600-1699	<input type="checkbox"/> ARCHITECTURE	<input type="checkbox"/> EDUCATION	<input type="checkbox"/> MILITARY	<input type="checkbox"/> SOCIAL/HUMANITARIAN	
<input type="checkbox"/> 1700-1799	<input type="checkbox"/> ART	<input type="checkbox"/> ENGINEERING	<input type="checkbox"/> MUSIC	<input type="checkbox"/> THEATER	
<input type="checkbox"/> 1800-1899	<input type="checkbox"/> COMMERCE	<input type="checkbox"/> EXPLORATION/SETTLEMENT	<input type="checkbox"/> PHILOSOPHY	<input type="checkbox"/> TRANSPORTATION	
<input checked="" type="checkbox"/> 1900-	<input type="checkbox"/> COMMUNICATIONS	<input type="checkbox"/> INDUSTRY	<input type="checkbox"/> POLITICS/GOVERNMENT	<input type="checkbox"/> OTHER (SPECIFY)	
		<input type="checkbox"/> INVENTION			

---

SPECIFIC DATES	BUILDER/ARCHITECT
----------------	-------------------

---

**STATEMENT OF SIGNIFICANCE**

South Westernport, an early 20th century housing complex in Westernport, Maryland, is architecturally significant as the only rowhouse development of its size in Allegany County. It is also, for western Maryland, an unusual architectural approach to company-supplied housing.

**History and Support**

South Westernport is located in Westernport, Md. The town of Westernport is located at the confluence of Georges Creek and the Potomac River. The town traces its late-18th century beginnings to George Washington's idea of deepening and connecting the Potomac and Ohio rivers for water transportation. The plan, although never realized, created interest in the area and attracted settlers. 1 In 1802, the town known to its residents as "Hardscrabble" was named Westernport and made a post town. As early as 1810 Georges Creek Coal was shipped down the Potomac River from Westernport. The town's importance as a transportation center was established in the 1850's when it became the site of the junction of the Baltimore and Ohio Railroad and the Cumberland and Pennsylvania Railroad. 2

The West Virginia Pulp and Paper Company, which built south Westernport in 1920-1922, was originally known as the Piedmont Pulp and Paper Company. In 1888 this company purchased a saw-mill at the fledgeling village of West Piedmont and enlarged the operation into a pulp and papermill which employed 1000 laborers by 1909. 3 Throughout its existence the company provided housing for its workers in the factory town which was renamed Luke. 4 In 1918 the company owned 67 houses, mostly frame duplex buildings, which were located on terraced streets on a steep hillside. 5 It is likely that by 1918 the usable building lots in Luke were occupied and the company was compelled to seek building space elsewhere.

During the 20th century Westernport was also experiencing growing pains. The number of building sites in Westernport was limited by the hilly topography of the intersecting Georges Creek and Potomac River valleys. Additional pressure for building

**CONTINUE ON SEPARATE SHEET IF NECESSARY**

**9 MAJOR BIBLIOGRAPHICAL REFERENCES**

CONTINUE ON SEPARATE SHEET IF NECESSARY

**10 GEOGRAPHICAL DATA**

ACREAGE OF NOMINATED PROPERTY \_\_\_\_\_

VERBAL BOUNDARY DESCRIPTION

LIST ALL STATES AND COUNTIES FOR PROPERTIES OVERLAPPING STATE OR COUNTY BOUNDARIES

STATE COUNTY

STATE COUNTY

**11 FORM PREPARED BY**

NAME / TITLE

David A. Dorsey, Historic Sites Surveyor

ORGANIZATION

Maryland Historical Trust/Bureau of Mines

DATE

May 1982

STREET &amp; NUMBER

21 State Circle, Shaw House

TELEPHONE

(301) 269-2438

CITY OR TOWN

Annapolis

STATE

Maryland 21401

The Maryland Historic Sites Inventory was officially created by an Act of the Maryland Legislature, to be found in the Annotated Code of Maryland, Article 41, Section 181 KA, 1974 Supplement.

The Survey and Inventory are being prepared for information and record purposes only and do not constitute any infringement of individual property rights.

RETURN TO: Maryland Historical Trust  
The Shaw House, 21 State Circle  
Annapolis, Maryland 21401  
(301) 267-1438

space was created by the rapid growth of the town's population which increased from 1468 people in 1880 to nearly 4000 in 1920.<sup>6</sup>

In 1918, the West Virginia Pulp and Paper Company purchased several acres of Potomac River flood plain land in Westernport from the Westernport Real Estate and Improvement Company.<sup>7</sup> The paper company's decision makers, realizing the restrictions on building space near the Luke Mill, used the rowhouse plan as a means of using the available space most effectively. Between 1920 and 1922 the company constructed 72 rowhouse dwellings on Maryland Avenue of South Westernport.<sup>8</sup>

The rowhouses, resembling those of Baltimore and other metropolitan areas, are unique in Allegany County, where the few existing rowhouses are single rows found in neighborhoods characterized by detached dwellings. South Westernport's three blocks of rowhouses present a streetscape which is quite uncommon for its non-metropolitan setting.

The brick rowhouses are an unusual form of company housing in western Maryland. Company housing supplied by coal operators in the George's Creek coal region during the latter half of the 19th century is characterized by detached, frame, single or duplex buildings.

During the 1950's the West Virginia Pulp and Paper Company sold its houses to the occupants.

AL-VI-D-310

South Westernport Historic District  
(Bibliography #9 - Continuation)

Allegheny County Land Records

Allegheny County Tax Assessments

Stegmaier, Harry L., et al, Allegheny County - A History, Parsons: McClain Publishing Company, 1976.

Town of Luke, Maryland: 50th Anniversary of Incorporation, 1922 through 1972, Luke, MD: Privately published, 1972.

Westvaco Corporation, Luke Mill Report, Bicentennial Edition, Luke, MD: Privately published, 1976.

Footnotes

1

Harry L. Stegmaier, et al, Allegheny County - A History, Parsons: McClain Publishing Company, 1976, pp. 84-86.

2

Ibid. pp. 140-141.

3

Westvaco Corporation, Luke Mill Report, Bicentennial Edition, Luke, MD: Privately published, 1976, p. 1 and p. 4.

4

Town of Luke, Maryland: 50th Anniversary of Incorporation, 1922 through 1972, Luke: Privately published, 1972, p. 10.

5

Allegheny County Tax Assessments, 1918-1922, Election District 8.

6

Stegmaier et al, p. 258.

7

Allegheny County Land Records, Liber 125, Folio 493.

8

Luke Mill Report, Bicentennial Edition, p. 14, and Allegheny County Tax Assessments, 1918-1922, Election District 8.

9

Stegmaier, et al, p. 402.

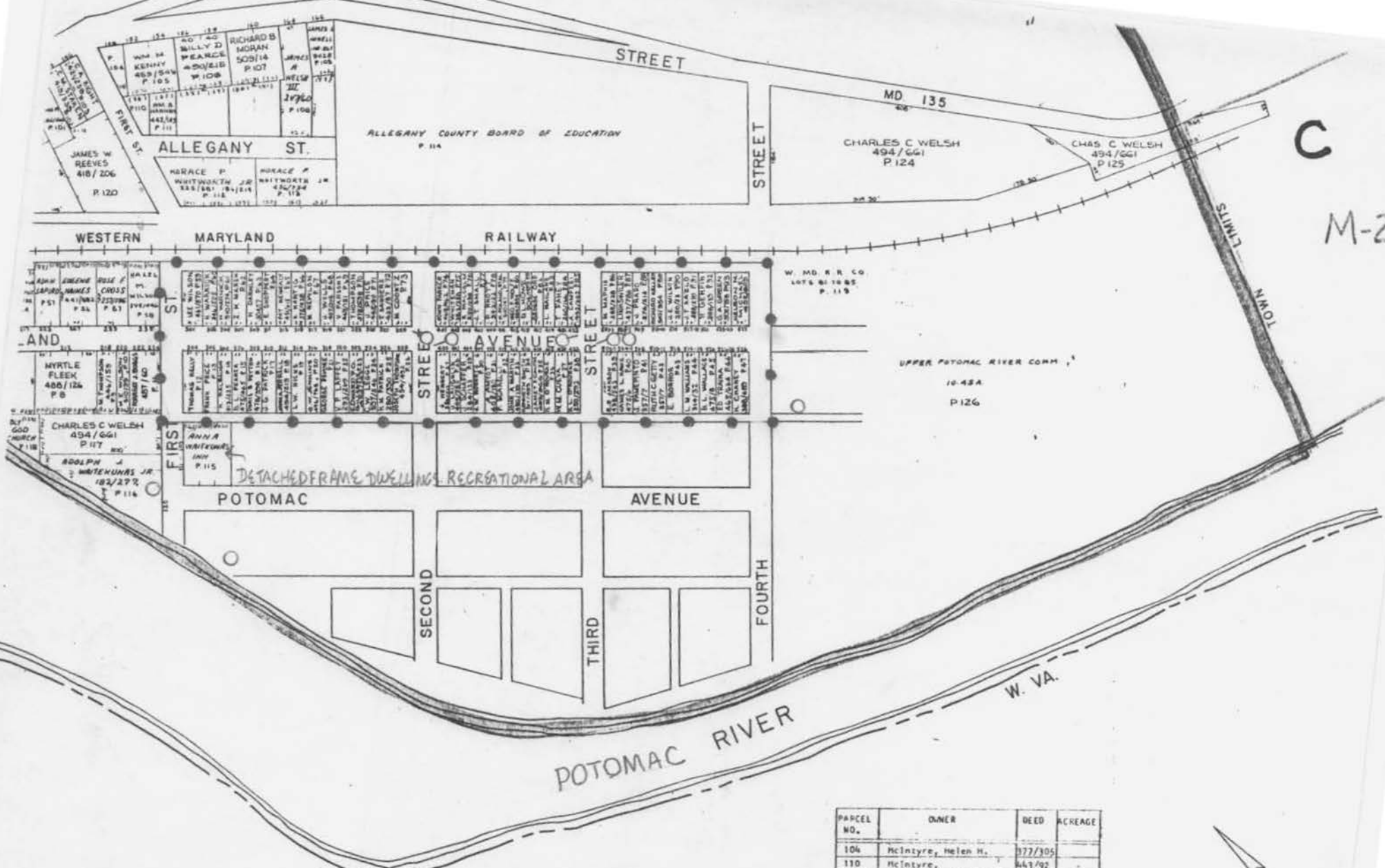

C  
M-2

SOUTH WESTERNPORT HISTORIC DISTRICT  
 APPROXIMATE SCALE 1"=2000'  
 AL-VI-D-310

PARCEL NO.	OWNER	DEED	ACREAGE
104	McIntyre, Helen H.	377/305	
110	McIntyre,	443/92	
122	Will, Marshall	501/817	



WEST  
 ALLEGANY  
 SCALE

DEPT. OF ASSESSMENTS & TAXATION  
 TAX MAP DIVISION





PARCEL NO.	OWNER	DEED	ACREAGE
220	Davis, Julian	383/126	
221	Keller, Russell W.	506/689	
224	Kitzmiller, R.	254/413	
226	Bateson, Cecil	286/540	
228	Hazzone	368/7	

AL-VI-D-310

PIEDMONT WEST VIRGINIA

MD. 135

WESTERN MARYLAND

POTOMAC RIVER

WALNUT STREET

VINE STREET

SPRING ALLEY

STREET

STREET

FAIRVIEW

LYNN

GAY

JOHNSON

STREET

STREET

STREET

STREET

STREET

STREET

STREET

STREET

STREET

STREET

STREET

STREET

STREET

STREET

STREET

MD

FRONT ST

WESTERN MARYLA

WASHINGTON  
GEORGES  
SAC

LIMITS

S.A.C.

A

AL-VI-D-310

AK ST

LYN G  
KRON  
26/182  
P. 511

45 E  
SON  
9/130  
210

1116 E  
BRICK  
20/360  
18/176  
207

IMPORT  
019

ST

ROCK

DAVID L GENTRY  
503/03  
P.190

CHARLES T HOBBS  
240/325  
P.175

DEWEY A DUCKWORTH  
274/472 P.178

SARAH J MORAN  
R.177

P.188 P.176

CLIFTON G MCKENZIE  
279/568 P.175

JOHNSON

TOWN OF WESTERN-PORT  
405/318 P.187

JOHN W MILLS  
515/700 P.172

HELEN K WILSON  
501/426 P.171

JOSEPH JARFIND  
385/236 P.170

DONALD L  
241/36 P.168

FRANCIS A  
NAUGHTON P.166

RUSSELL BROY  
P.167

WANDA E  
BUT P.164

P.163

FAIRVIEW

RUSSELL T MOOREHEAD  
316/153 P.144

ROBERT PEARCE  
461/264 P.165

DONNA J  
MICHAEL  
485/10 P.182

CLARA D  
WILSON  
475/174 P.161

GAY

THOMAS L  
PEARCE  
384/504 P.191

HARRY P PRITTS  
308/502 P.191

MELVIN R  
PRITTS  
326/226 P.160

HARRIETT A MEYERS  
466/801 P.158

WILLIAM M  
SMILEY  
372/18 P.154

GEORGE HES  
344/107 P.153

JOHN J HERTZ  
435/37 P.136

DANIEL A HOLLER  
P.135

DARRELL G WINEBRENNER  
443/454

EARL BRADWATER  
311/221 P.152

JOHN K  
DE VOES  
478/105 P.151

JOHN F  
WILLIAMS  
487/640 P.150

WILLIAM  
FURKROW  
P.128

BLA MARY  
342/405 P.125

RONALD GREY  
470/404 P.140

JOHN A  
JOHNSTON  
154/448 P.147

DONALD L  
GROVE  
279/108 P.149

EARL  
GROVE  
305/552 P.158

QUIGLEY  
FOULTZ  
382/178 P.146

JOHN J  
TAYLOR  
466/743 P.144

RUSSELL  
FOULTZ  
P.125

JOHN W  
MOOREHEAD  
P.124

HAROLD W  
BURGESS  
344/404 P.144

RICHARD P  
DAVIS  
445/464 P.143

WALTER R  
MARTIN  
360/262 P.142

RICHARD A  
DAVIS  
P.122

RICHARD  
A. DAVID  
409/172 P.121

STREET

MARILYN M  
DYER  
436/137 P.105

ROBERT C  
KELLER  
468/107 P.120

DONALD SMITH  
371/251 P.108

KENNETH L KELLER  
381/240 P.123

JAMES O  
RAHMS  
449/248 P.118

W. WILSON  
413/128 P.118

JOHN P  
HOOKER  
P.117

VINCENT  
HOOKER  
P.117

DALE D  
DESHOND  
BOGGS  
P.113

ONEY E  
MICHAEL  
P.114

ONEY E MICHAEL  
466/809 P.113

ALBERT DUCHONNE  
480/184 P.112

ALBERT D  
DUCKWORTH  
480/181 P.111

WYRILE W  
MORRISON  
P.110

IVELYN  
SHELTER  
364/440 P.109

JOHN P  
HOOKER  
P.108

RUSSELL R  
FOLTZ  
261/10 P.108

STREET

DONALD SMITH  
318/31 P.87

ELMER E  
KLOBERG  
P.106

MARILYN M  
DYER  
436/137 P.105

MARIE  
KESNER  
444/91 P.120

EDWARD J  
KALBAUGH, JR  
405/490 P.84

ARTHUR J  
DEBANDER  
P.83

HARRY T  
KALBAUGH  
P.82

KENNETH E  
METCALF  
P.81

RONALD E  
WINTNER  
397/264 P.80

EARL A  
KALBAUGH  
P.79

ED J KALBAUGH  
508/466 P.87

POWER L  
KAMER  
P.86

THOS M  
MALCOLM  
455/114 P.85

ESSE H  
BIRDA  
409/800 P.84

GARY H  
POPP  
400/818 P.83

CHAS WITCHKES  
467/817 P.82

ROBERT SOMER  
448/716 P.81

IVELYN F  
WARRIUK  
P.80

EDWARD  
W. JONES  
447/574 P.80

STREET

CARL E SHAW, JR  
507/445 P.80

DONALD SMITH  
318/31 P.87

JANNA  
COLMAN  
480/461 P.81

CLARENCE  
W BIGG3  
P.88

STREET

J D LAFFEY  
351/282 P.78

JOHN R DEVORE  
511/777 P.57

RICHARD E MILLER  
409/569 P.56

WILLIAM E MAYLES, JR  
486/454 P.55

ODES H CHESHIRE  
464/772 P.54

ELMER E  
HOTT  
467/306 P.41

MILLIE  
COOPER  
440/253 P.42

E. E. HOTT  
467/306 P.41

CHAR A  
PATRICK  
440/653 P.43

STREET

GEORGE D  
MACKEY  
340/387 P.78

CYNTHIA SHERROD  
496/491 P.78

ROBERT P  
BANK  
471/25 P.75

JOSEPH MILLER  
311/186 P.74

EDWIN  
MONTGOMERY  
262/118 P.73

WILBUR T  
WILT  
422/287 P.81

PORTER D  
SCHWERS  
401/630 P.74

PORTER D  
SCHWERS  
401/630 P.73

AMANDA L  
FRANKLAND  
P.43

STREET

GEORGE T  
DEWITT JR  
P.42

GLENN STRICKLER  
512/411 P.41

SARAH J  
MORAN  
P.25

CHARLES E  
MORAN  
P.35

CHARLES E  
MORAN  
P.35

CLYDE E  
FRANKLAND  
P.38

S.R.C.

FUSNER ST.

EVANGELICAL LUTHERAN  
CHURCH P. 20

448/846

STEPHAN WIELAND  
Q 504/504 P.19

NEVA F LUPTON  
506/728 P.27

WILLIAM E PRITCHARD  
394/141 P.26

MELVILLE R  
WHITE  
257/523 P.25

RETHA E  
BERON  
352/225 P.24

HAZEL M  
GIBSON  
448/151 P.23

STREET

HAZEL WOLFE  
507/542 P.21

C R  
SMITH  
357/83 P.16

MC CLELLAN  
RIGGLEMAN  
242/170 P.12

CHARLES R  
SMITH  
P.12

HELLIE R  
DOWLING  
P.23

R W CLEVELAND  
414/286 P.22

S.R.C.

STREET

ROBERT L  
FITZGERALD  
485/811 P.75

MICHAEL J  
DAILEY  
458/243 P.74

J BANCHE  
243/309 P.72

CLARENCE  
W DAVIS  
335/212 P.71

R J  
P.68

GRACE E  
FOSTER  
613/119 P.66

FRONT ST.

MD.

36

WESTERN MARYLAND RAILWAY

PIEDMONT WEST VIRGINIA

RIVER

MD. 135

WALNUT

VINE

SPRING ALLEY

WALNUT

WALNUT

WALNUT

WALNUT

WALNUT

WALNUT

WALNUT

WALNUT

RECEL NO. OWNER DEED RECAP

WESTERNPORT QUADRANGLE  
WEST VIRGINIA-MARYLAND  
7.5 MINUTE SERIES (TOPOGRAPHIC)  
NE/4 ELK GARDEN 15' QUADRANGLE

YLAND  
AL SURVEY

ROSTBURG (JUNC. U.S. 40)-15 MI. 2'30" 668 669 670 2 140 000 FEET (W. VA.) 79°



Westernport, MD:WV  
USGS 7.5 Minute Series  
Scale 1:24,000  
1950; photorevised 1974

AL-VI-D-310  
South Westernport Historic District  
22 miles southwest of Cumberland



①

AL-VI-D-310

South Westernport Hist. District

Allegany Co., MD

David A. Dorsey 1/82

photo #1, looking southwest



2

AL-VI-D-310

S. Westernport Historic District

Allegany Co., MD

David A. Dorsey 1/82

photo #2, looking northwest



3

AL-VI-D-310  
South Westernport Hist. Dist.  
Allegany Co., MD  
David A. Dorsey 1/82  
photo #3, looking southwest



3

AL-VI-D-310

South Westernport Hist. Dist.

Allegany Co., MD

David A. Dorsey 1/82

photo #5, looking northeast



6

AL-VI-D-310

South Westernport Hist. Dist.

Allegheny Co., MD

David A. Dorsey 1/82

photo #6, looking northwest



7

AL-VI-D-310

South Westernport Hist. Dist.

Allegany Co., MD

David A. Dorsey 1/82

photo #7, looking northeast



8

AL-VI-D-310

South Westernport Hist. Dist.

Allegany Co., MD

David A. Dorsey 1/82

photo #8, looking northeast